

# SECURITY FIXINGS THAT NEVER LET GO



**2011 STOCK  
PRODUCT GUIDE  
EDITION 4**



# 4



## Welcome to Edition 4 Prolok Security Fastener Catalogue!

Anything left unattended in the public area  
is at risk of theft, vandalism and tampering.

And when it's your valuable property, what's  
the best way to protect it?

By installing a 24/7 security guard.

One that's unique and suited to your  
application.

**One that never lets go.**







# Security & Architectural Fasteners

	RESYTORK SECURITY SCREWS		2
	RESYTORK BARREL NUTS		10
	PIN HEX SECURITY SCREWS		12
	2 HOLE SECURITY SCREWS		18
	CLUTCH HEAD SECURITY SCREWS		23
	SENTINEL® SECURITY SCREWS		26
	TORXplus® SECURITY SCREWS		28
	TRI-LOBULAR SECURITY SCREWS		30
	OVAL PAN HEAD SECURITY SCREWS		32
	QUADTECH™ SECURITY SCREWS		33
	PENTAFORCE™ SECURITY SCREWS		34
	UNI-SET™ SECURITY SCREWS		37
	KINMAR® SECURITY SYSTEM	 	38
	SHEAR NUTS		40
	STELLAR™ FASTENING SYSTEM		41
	ARMOUR RINGS		42
	SLAB TEE NUTS		44
	TRIDENT NUTS		44
	NO-GO™ SECURITY ENCLOSURES		45
	SCROLL NUTS		46
	4-HOLE NUTS		47
	PYRANUT SECURITY NUTS		48
	SECURITY ANCHORS	 	49
	SECURITY TOOLING		54
	MADE TO MEASURE SPECIALS		58
	TECHNICAL INFORMATION		60
	PROMOTIONAL		64
	APPLICATION ADVICE		66

## How To Order

- Does it need to be removable?  
If 'yes' look for  logo  
If 'no' look for  logo
- What size?
- What material?
- What quantity do you require?
- Bulk packs or in box quantity?



- How many driver bits do you need?
- Do you want direct to site plain label delivery?
- Phone before 3:30pm to avoid disappointment!

Call our Sales team on  
**1800 PRO LOK**  
7 7 6 5 6 5



Stocked in the largest range available, including machine screws, self tappers, self drilling screws, barrel nuts and concrete anchors.



Also available in zinc plated steel to order only. Subject to minimum order quantity.



Manufactured with an internal pin in the six-lobe recess to repel standard tork bits.



Manufactured in 304 (A2 or 18-8 grade) stainless steel.



Specials can be made to order, such as grub screws and other thread styles e.g. concrete tapping screws, tri-lobular metal and plastic tapping threads etc.



Also known as Post Tork, Star Drive Pin or Security Tork.



Available to order in other materials (note minimum order qty may apply).



Requires matching tooling, see page 55.



Suitable for high torque applications.



Head dimensions on page 60.



Imperial sizes available – see pages 6 & 7.



## Resytork Countersunk Self Tapper

AB Type Thread | 304 Stainless Steel



GAUGE LENGTH		4 GAUGE (2.9mm)			6 GAUGE (3.5mm)			8 GAUGE (4.2mm)		
		Driver: T10	Pack: 100		Driver: T15	Pack: 100		Driver: T20	Pack: 100	
		Part No.	\$ / 100	\$ / Ea	Part No.	\$ / 100	\$ / Ea	Part No.	\$ / 100	\$ / Ea
3/8"	9.5mm				RTCS6C	82.20	0.99			
1/2"	13mm	RTCS4D	73.00	0.88	RTCS6D	83.80	1.01	RTCS8D	93.00	1.12
5/8"	16mm				RTCS6E	86.60	1.04	RTCS8E	96.00	1.15
3/4"	19mm	RTCS4F*	76.00	0.91	RTCS6F	89.90	1.08	RTCS8F	98.80	1.19
1"	25mm				RTCS6G	95.80	1.15	RTCS8G	111.80	1.34
1 1/4"	32mm							RTCS8H	118.60	1.42
1 1/2"	38mm				RTCS6I	125.10	1.50	RTCS8I	142.60	1.71
2"	50mm							RTCS8J	158.70	1.90

\* Also available in 316 S/S

GAUGE LENGTH		10 GAUGE (4.8mm)			12 GAUGE (5.5mm)			14 GAUGE (6.3mm)		
		Driver: T25	Pack: 100		Driver: T27	Pack: 100		Driver: T30	Pack: 100	
		Part No.	\$ / 100	\$ / Ea	Part No.	\$ / 100	\$ / Ea	Part No.	\$ / 100	\$ / Ea
1/2"	13mm	RTCS10D	108.70	1.30						
1/2"	Undercut	RTCS10D-UC	168.00	2.02						
5/8"	16mm	RTCS10E	118.60	1.42	RTCS12E	198.00	2.38	RTCS14E	180.30	2.16
3/4"	19mm	RTCS10F	125.10	1.50	RTCS12F	203.00	2.44	RTCS14F	184.00	2.21
1"	25mm	RTCS10G	133.40	1.60	RTCS12G	207.90	2.49	RTCS14G	194.20	2.33
1 1/4"	32mm	RTCS10H	145.00	1.74	RTCS12H	211.50	2.54	RTCS14H	268.40	3.22
1 1/2"	38mm	RTCS10I	169.90	2.04	RTCS12I	243.20	2.92	RTCS14I	309.10	3.71
2"	50mm	RTCS10J	191.80	2.30	RTCS12J	260.20	3.12	RTCS14J	475.00	5.70
2 1/2"	63mm	RTCS10K	229.50	2.75	RTCS12K	301.50	3.62			
3"	75mm	RTCS10L	267.00	3.20	RTCS12L	310.30	3.72			
4"	100mm	RTCS10N	304.50	3.65						





## Resytork Button Head Self Tapper

AB Type Thread | 304 Stainless Steel

GAUGE LENGTH		6 GAUGE (3.5mm)			8 GAUGE (4.2mm)		
		Driver: T15	Pack: 100		Driver: T20	Pack: 100	
		Part No.	\$ / 100	\$ / Ea	Part No.	\$ / 100	\$ / Ea
3/8"	9.5mm	RTBS6C	81.30	9.76	RTBS8C	89.60	1.08
1/2"	13mm	RTBS6D	83.80	1.01	RTBS8D	93.00	1.12
5/8"	16mm	RTBS6E	87.30	1.05	RTBS8E	96.00	1.15
3/4"	19mm	RTBS6F	89.90	1.08	RTBS8F	98.80	1.19
1"	25mm	RTBS6G	95.80	1.15	RTBS8G	111.80	1.34
1 1/4"	32mm				RTBS8H	118.60	1.42
1 1/2"	38mm	RTBS6I	125.10	1.50	RTBS8I	142.60	1.71
2"	50mm				RTBS8J	158.70	1.90

GAUGE LENGTH		10 GAUGE (4.8mm)			12 GAUGE (5.5mm)			14 GAUGE (6.3mm)		
		Driver: T25	Pack: 100		Driver: T27	Pack: 100		Driver: T27	Pack: 100	
		Part No.	\$ / 100	\$ / Ea	Part No.	\$ / 100	\$ / Ea	Part No.	\$ / 100	\$ / Ea
1/2"	13mm	RTBS10D	108.70	1.30						
5/8"	16mm	RTBS10E	122.50	1.47	RTBS12E	198.80	2.39	RTBS14E	233.30	2.80
3/4"	19mm	RTBS10F	125.10	1.50	RTBS12F	205.00	2.46	RTBS14F	238.00	2.86
1"	25mm	RTBS10G	133.40	1.60	RTBS12G	207.90	2.49	RTBS14G	259.00	3.11
1 1/4"	32mm	RTBS10H	145.00	1.74	RTBS12H	211.50	2.54	RTBS14H	268.40	3.22
1 1/2"	38mm	RTBS10I	169.90	2.04	RTBS12I	243.20	2.92	RTBS14I	309.10	3.71
2"	50mm	RTBS10J	191.80	2.30	RTBS12J	260.20	3.12	RTBS14J	475.00	5.70
2 1/2"	63mm				RTBS12K	301.50	3.62			
3"	75mm				RTBS12L	310.30	3.72	RTBS14L	550.00	6.60



## Resytork Button Head Coach Screw

AB Type Thread | Zinc Plated

GAUGE LENGTH		12 GAUGE (5.5mm)			18 GAUGE (8.0mm)		
		Driver: T27	Pack: 100		Driver: T27	Pack: 100	
		Part No.	\$ / 100	\$ / Ea	Part No.	\$ / 100	\$ / Ea
2 1/2"	63mm	RTBS12K-Z	220.00	2.64	RTBS18K-Z	385.00	4.62





Available in other materials by special order (minimum order quantities apply).



Head dimensions on page 60.



Imperial sizes available – see page 6.



Specials such as grub screws, socket cap screws etc. made to order – please call our sales team for assistance.



Tooling available as either insert bits or key wrenches – see page 55.



## Resytork Countersunk Machine Screws

304 Stainless Steel



GAUGE LENGTH	M3			M4			M5		
	Driver: T10	Pack: 100		Driver: T20	Pack: 100		Driver: T25	Pack: 100	
	Part No.	\$ / 100	\$ / Ea	Part No.	\$ / 100	\$ / Ea	Part No.	\$ / 100	\$ / Ea
6mm	RTCM306	71.10	0.85						
8mm	RTCM308	92.20	1.11	RTCM408	77.00	0.92	RTCM508	99.00	1.19
10mm	RTCM310	92.70	1.11	RTCM410	78.10	0.94	RTCM510	101.20	1.21
12mm	RTCM312	96.00	1.15	RTCM412	79.60	0.96	RTCM512	103.90	1.25
16mm	RTCM316	99.80	1.20	RTCM416	82.60	0.99	RTCM516	109.40	1.31
20mm	RTCM320	103.70	1.24	RTCM420	88.20	1.06	RTCM520	116.70	1.40
25mm	RTCM325	124.00	1.49	RTCM425	95.10	1.14	RTCM525	131.60	1.58
30mm				RTCM430	100.00	1.20	RTCM530	139.80	1.68
35mm				RTCM435	187.50	2.25	RTCM535	182.00	2.18
40mm				RTCM440	152.00	1.82	RTCM540	164.40	1.97
50mm				RTCM450	175.00	2.10	RTCM550	183.90	2.21
70mm				RTCM470	198.00	2.38			
80mm							RTCM580	268.00	3.22

GAUGE LENGTH	M6			M8			M10		
	Driver: T30	Pack: 100		Driver: T40	Pack: 100		Driver: T45	Pack: 100	
	Part No.	\$ / 100	\$ / Ea	Part No.	\$ / 100	\$ / Ea	Part No.	\$ / 100	\$ / Ea
8mm	RTCM608	116.00	1.39						
10mm	RTCM610	122.90	1.47	RTCM810	262.50	3.15			
12mm	RTCM612	123.40	1.48						
16mm	RTCM616	125.20	1.50	RTCM816	248.50	2.98			
20mm	RTCM620	135.10	1.62	RTCM820	282.00	3.38			
25mm	RTCM625	155.10	1.86	RTCM825	305.50	3.67			
30mm	RTCM630	165.40	1.98	RTCM830	330.90	3.97	RTCM1030	440.00	5.28
35mm	RTCM635	182.80	2.19						
40mm	RTCM640	192.30	2.31	RTCM840	387.70	4.65			
50mm	RTCM650	214.10	2.57	RTCM850	430.90	5.17			
60mm	RTCM660	220.00	2.64	RTCM860	449.00	5.39	RTCM1060	620.00	7.44
80mm	RTCM680	245.00	2.94	RTCM880	455.00	5.46	RTCM1080	730.00	8.76





## Resytork Button Head Machine Screws

304 Stainless Steel

**RESYTORK**



GAUGE	M3			M4			M5		
	Driver: T10	Pack: 100		Driver: T20	Pack: 100		Driver: T25	Pack: 100	
LENGTH	Part No.	\$ / 100	\$ / Ea	Part No.	\$ / 100	\$ / Ea	Part No.	\$ / 100	\$ / Ea
6mm	RTBM306	71.10	0.85	RTBM406	74.50	0.89			
8mm	RTBM308	73.70	0.88	RTBM408	76.90	0.92	RTBM508	99.00	1.19
10mm	RTBM310	74.20	0.89	RTBM410	78.10	0.94	RTBM510	101.20	1.21
12mm	RTBM312	76.80	0.92	RTBM412	79.60	0.96	RTBM512	103.90	1.25
14mm	RTBM314	77.80	0.93						
16mm	RTBM316	79.80	0.96	RTBM416	82.60	0.99	RTBM516	109.40	1.31
18mm							RTBM518	146.00	1.75
20mm	RTBM320	83.00	1.00	RTBM420	88.20	1.06	RTBM520	116.70	1.40
25mm	RTBM325	89.00	1.07	RTBM425	95.10	1.14	RTBM525	131.60	1.58
30mm				RTBM430	100.00	1.20	RTBM530	139.80	1.68
35mm							RTBM535	149.60	1.80
40mm				RTBM440	127.00	1.52	RTBM540	164.40	1.97
50mm				RTBM450	148.00	1.78	RTBM550	183.90	2.21

GAUGE	M6			M8			M10		
	Driver: T30	Pack: 100		Driver: T40	Pack: 100		Driver: T45	Pack: 100	
LENGTH	Part No.	\$ / 100	\$ / Ea	Part No.	\$ / 100	\$ / Ea	Part No.	\$ / 100	\$ / Ea
8mm	RTBM608	104.80	1.26						
10mm	RTBM610	105.30	1.26	RTBM810	220.00	2.64			
12mm	RTBM612	105.80	1.27	RTBM812	232.00	2.78			
16mm	RTBM616	107.30	1.29	RTBM816	246.50	2.96	RTBM1016	352.00	4.22
20mm	RTBM620	115.80	1.39	RTBM820	275.00	3.30	RTBM1020	359.00	4.31
25mm	RTBM625	132.90	1.59	RTBM825	299.00	3.59	RTBM1025	382.00	4.58
30mm	RTBM630	141.80	1.70	RTBM830	328.30	3.94	RTBM1030	431.00	5.17
35mm	RTBM635	158.00	1.90	RTBM835	352.00	4.22	RTBM1035	447.00	5.36
40mm	RTBM640	164.80	1.98	RTBM840	370.00	4.44	RTBM1040	462.00	5.54
45mm							RTBM1045	484.00	5.81
50mm	RTBM650	183.50	2.20	RTBM850	404.00	4.85	RTBM1050	502.00	6.02
55mm				RTBM855	418.00	5.02			
60mm	RTBM660	215.00	2.58	RTBM860	438.50	5.26	RTBM1060	537.00	6.44
65mm				RTBM865	460.00	5.52	RTBM1065	564.90	6.78
70mm	RTBM670	245.00	2.94	RTBM870	490.00	5.88	RTBM1070	607.00	7.28
75mm	RTBM675	315.00	3.78	RTBM875	506.00	6.07			
80mm	RTBM680	330.00	3.96	RTBM880	523.00	6.28	RTBM1080	692.00	8.30
90mm							RTBM1090	732.00	8.78
95mm				RTBM895	545.00	6.54			
100mm				RTBM8100	569.00	6.83			

GAUGE	M12		
	Driver: T50	Pack: 100	
LENGTH	Part No.	\$ / 100	\$ / Ea
30mm	RTBM1230	1,120.00	13.44

Available in Zinc Plated or  
Galvanised Steel – see page 8.





Available in other materials by special order (minimum order quantities apply).



Tooling available as either insert bits or key wrenches – see page 55.



Manufactured with an internal pin in the six-lobe recess to repel standard tork tools.



Head dimensions on page 60.



Specials such as grub screws, socket cap screws etc. made to order – please call our sales team for assistance.



Manufactured in 304 (A2 or 18-8 grade) stainless.



## Resytork Imperial Countersunk Machine Screws

304 Stainless Steel

GAUGE LENGTH		6-32 UNC			8-32 UNC			10-24 UNC		
		Driver: T15	Pack: 100		Driver: T20	Pack: 100		Driver: T25	Pack: 100	
		Part No.	\$ / 100	\$ / Ea	Part No.	\$ / 100	\$ / Ea	Part No.	\$ / 100	\$ / Ea
1/4"	7mm	RTCM632AU*	104.00	1.25	RTCM832AU*	108.00	1.30			
3/8"	9.5mm	RTCM632C	104.00	1.25	RTCM832C	108.00	1.30	RTCM1024C	128.00	1.54
1/2"	13mm	RTCM632D	106.00	1.27	RTCM832D	112.00	1.34	RTCM1024D	136.00	1.63
5/8"	16mm				RTB512F	205.00	2.46	RTCM1024E	144.00	1.73
3/4"	19mm	RTCM632F	120.00	1.44	RTCM832F	119.00	1.43	RTCM1024F	152.00	1.82
1"	25mm	RTCM632G	134.00	1.61	RTCM832G	126.00	1.51	RTCM1024G	156.00	1.87
1 1/4"	32mm				RTCM832H	138.00	1.66	RTCM1024H	172.00	2.06
1 1/2"	38mm	RTCM632I	138.00	1.66	RTCM832I	146.00	1.75	RTCM1024I	189.00	2.27

\*Undercut - T10 Drive

\*Undercut - T15 Drive

GAUGE LENGTH		10-32 UNF			1/4 - 20 UNC			3/8 UNC		
		Driver: T25	Pack: 100		Driver: T30	Pack: 100		Driver: T45	Pack: 100	
		Part No.	\$ / 100	\$ / Ea	Part No.	\$ / 100	\$ / Ea	Part No.	\$ / 100	\$ / Ea
3/8"	9.5mm	RTCM1032C	128.00	1.54	RTCM1/4CU*	206.00	2.47			
1/2"	13mm	RTCM1032D	136.00	1.63	RTCM1/4DU*	190.00	2.28			
5/8"	16mm				RTCM1/4E	196.00	2.35	RTCM3/8E	429.00	5.15
3/4"	19mm	RTCM1032F	152.00	1.82	RTCM1/4F	212.00	2.54			
1"	25mm	RTCM1032G	156.00	1.87	RTCM1/4G	236.00	2.83			
1 1/4"	32mm	RTCM1032H	172.00	2.06	RTCM1/4H	248.00	2.98			
1 1/2"	38mm	RTCM1032I	189.00	2.27	RTCM1/4I	252.00	3.02			
2"	50mm				RTCM1/4J	420.00	5.04			

\*Undercut - T27 Drive





## Resytork Imperial Button Head Machine Screws

304 Stainless Steel

GAUGE LENGTH		6-32 UNC			8-32 UNC			10-24 UNC		
		Driver: T10			Driver: T15			Driver: T25		
		Part No.	\$ / 100	\$ / Ea	Part No.	\$ / 100	\$ / Ea	Part No.	\$ / 100	\$ / Ea
3/8"	9.5mm	RTBM632C	104.00	1.25	RTBM832C	108.00	1.30	RTBM1024C	128.00	1.54
1/2"	13mm	RTBM632D	106.00	1.27	RTBM832D	112.00	1.34	RTBM1024D	136.00	1.63
3/4"	19mm	RTBM632F	120.00	1.44	RTBM832F	119.00	1.43	RTBM1024F	152.00	1.82
1"	25mm	RTBM632G	134.00	1.61	RTBM832G	126.00	1.51	RTBM1024G	156.00	1.87
1 1/4"	32mm				RTBM832H	138.00	1.66	RTBM1024H	172.00	2.06
1 1/2"	38mm	RTBM632I	138.00	1.66	RTBM832I	146.00	1.75	RTBM1024I	189.00	2.27

GAUGE LENGTH		10-32 UNF			1/4 - 20 UNC			3/8 UNC		
		Driver: T25			Driver: T30			Driver: T25		
		Part No.	\$ / 100	\$ / Ea	Part No.	\$ / 100	\$ / Ea	Part No.	\$ / 100	\$ / Ea
3/8"	9.5mm	RTBM1032C	128.00	1.54	RTBM1/4C	206.00	2.47			
1/2"	13mm	RTBM1032D	136.00	1.63	RTBM1/4D	190.00	2.28			
5/8"	16mm				RTBM1/4E	196.00	2.35	RTBM3/8E	352.00	4.22
3/4"	19mm	RTBM1032F	152.00	1.82	RTBM1/4F	212.00	2.54	RTBM3/8F	359.00	4.31
1"	25mm	RTBM1032G	156.00	1.87	RTBM1/4G	236.00	2.83	RTBM3/8G	382.00	4.58
1 1/4"	32mm	RTBM1032H	172.00	2.06	RTBM1/4H	248.00	2.98	RTBM3/8H	431.00	5.17
1 1/2"	38mm	RTBM1032I	189.00	2.27	RTBM1/4I	252.00	3.02	RTBM3/8I	462.00	5.54
2"	50mm							RTBM3/8J	502.00	6.02
4"	100mm							RTBM3/8M	1092.00	13.10



## Resytork Raised Head Countersunk Machine Screws

304 Stainless Steel

GAUGE LENGTH		M3.5		
		Driver: T10		
		Part No.	\$ / 100	\$ / Ea
12mm		RTOM3512	133.60	1.60
20mm		RTOM3520	135.00	1.62
25mm		RTOM3525	138.20	1.66
30mm		RTOM3530	142.70	1.71
40mm		RTOM3540	147.10	1.77
50mm		RTOM3550	156.10	1.87



## Resytork Wafer Head Machine Screw

304 Stainless Steel

GAUGE LENGTH		M6		
		Driver: T10		
		Part No.	\$ / 100	\$ / Ea
35mm		RTWM635	165.00	1.98





Manufactured with an internal pin in the six-lobe recess to repel standard tork tools.



Manufactured in galvanised steel.



Available as Thread Forming and Tapered Point Machine Screws.



Head dimensions on page 60.



Tooling available as either insert bits or key wrenches – see page 55.



## Resytork Button Head Machine Screws

Galvanised



## Resytork Tapered Point Machine Screws

Galvanised

GAUGE	M10		
	Driver: T45	Pack: 100	
LENGTH	Part No.	\$ / 100	\$ / Ea
16mm	RTBM1016-G	198.00	2.38
20mm	RTBM1020-G	272.00	3.26
25mm	RTBM1025-G	288.00	3.46
30mm	RTBM1030-G	304.00	3.65
35mm	RTBM1035-G	336.00	4.03
40mm	RTBM1040-G	368.00	4.42
45mm	RTBM1045-G	389.00	4.67

GAUGE	M8			
	Driver: T40	Pack: 100		
LENGTH	Part No.	Description	\$ / 100	\$ / Ea
35mm	RTMM835-G	Thread Forming Machine Screw	118.00	1.42
50mm	RTBM850-T-G	Tapered Point Machine Screw	158.00	1.90



Manufactured with an internal pin in the six-lobe recess to repel standard tork tools.



Type 17 for quick and easy installation into timber.



Manufactured in zinc plated or galvanised steel.



Tooling available as either insert bits or key wrenches – see page 55.



## Resytork Button Head Type 17 Screws

Yellow Zinc | Galvanised

GAUGE		10 GAUGE (4.8mm)					
		YELLOW ZINC			GALVANISED		
LENGTH		Driver: T25	Pack: 1000		Driver: T25	Pack: 1000	
		Part No.	\$ / 1000	\$ / 100	Part No.	\$ / 1000	\$ / 100
3/4"	19mm	RTBT10F-Z	103.40	12.41	RTBT10F-G	126.50	15.18
1"	25mm	RTBT10G-Z	110.00	13.20	RTBT10G-G	137.50	16.50
1 1/2"	38mm	RTBT10I-Z	137.50	16.50	RTBT10I-G	165.00	19.80

Can be painted, to order  
– please call for stock  
availability.







Ideal security solution for applications such as fences, sheds, security screens etc where fast installation is required.



Manufactured with an internal pin in the six-lobe recess to repel standard tork tools.



Tooling available as either insert bits or key wrenches.



Manufactured in 410 Stainless.



**RESYTORK**



Warning: Please be aware 410 stainless is a martensitic stainless and contains high level of carbon in its chemical composition. This results in 410 Stainless having a corrosion rating similar to zinc plated fasteners. Not Recommended for use outdoors



## Resytork Pan Head Self Drilling Screws

410 Stainless Steel

GAUGE LENGTH		8 GAUGE (4.2mm)			10 GAUGE (4.8mm)		
		Driver: T20	Pack: 100		Driver: T25	Pack: 100	
		Part No.	\$ / 100	\$ / Ea	Part No.	\$ / 100	\$ / Ea
1/2"	13mm	RTPSD8D	128.00	1.54	RTPSD10D	118.00	1.42
3/4"	19mm	RTPSD8F	130.00	1.56	RTPSD10F	122.00	1.46
1"	25mm	RTPSD8G	132.00	1.58	RTPSD10G	118.00	1.42
1 1/4"	32mm	RTPSD8H	136.00	1.63	RTPSD10H	150.00	1.80
1 1/2"	38mm				RTPSD10I	165.00	1.98
2"	50mm				RTPSD10J	252.00	3.02

GAUGE LENGTH		12 GAUGE (5.5mm)			14 GAUGE (6.3mm)		
		Driver: T27	Pack: 100		Driver: T30	Pack: 100	
		Part No.	\$ / 100	\$ / Ea	Part No.	\$ / 100	\$ / Ea
3/4"	19mm				RTPSD14F	229.00	2.75
1"	25mm				RTPSD14G	239.00	2.87
1 1/2"	38mm	RTPSD12I	233.00	2.80	RTPSD14I	302.00	3.62
2"	50mm				RTPSD14J	462.00	5.54



## Pan Head Dimensions (mm)

GAUGE		DIMENSIONS			DRILLING CAPACITY
		A	B	C	
8	4.2mm	8	3	4.5	2 - 2.5mm
10	4.8mm	9	3.1	7	2 - 2.8mm
12	5.5mm	10.5	3.8	7	2 - 3mm
14	6.3mm	12	4	8	2.7 - 5mm

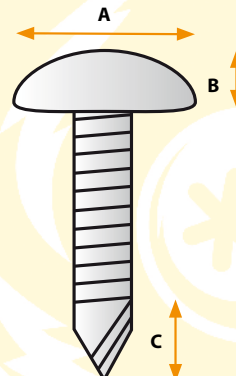

This table is a guide only and does not constitute a warranty of any type.



Available in 304 Grade Stainless, Galvanised and Zinc Plated Steel.

Ideal for playground manufacturers, councils and schools, or other applications where an aesthetically pleasing, vandal proof finish is required.



No protruding threads, ideal for public spaces.

Insert bit & key wrench to suit - see page 55.



## Resytork Countersunk Barrel Nuts

304 Stainless Steel

GAUGE	M4			M5			M6		
	Driver: T20	Pack: 100		Driver: T25	Pack: 100		Driver: T30	Pack: 100	
LENGTH	Part No.	\$ / 100	\$ / Ea	Part No.	\$ / 100	\$ / Ea	Part No.	\$ / 100	\$ / Ea
12mm	RTCNO412	168.00	2.10						
15mm				RTCNO515	225.00	2.81			
20mm							RTCNO620	248.00	3.10

GAUGE	M8			M10		
	Driver: T40	Pack: 100		Driver: T50	Pack: 100	
LENGTH	Part No.	\$ / 100	\$ / Ea	Part No.	\$ / 100	\$ / Ea
20mm	RTCNO820	310.00	3.88			
27mm				RTCNO1027	489.00	6.11

GAUGE	10-24 UNC			5/16 UNC			3/8 UNC		
	Driver: T27	Pack: 100		Driver: T45	Pack: 100		Driver: T50	Pack: 100	
LENGTH	Part No.	\$ / 100	\$ / Ea	Part No.	\$ / 100	\$ / Ea	Part No.	\$ / 100	\$ / Ea
22mm Stainless	RTCNO3/16S	490.00	5.88						
25mm Stainless				RTCNO5/16S	750.00	9.00			
32mm Stainless							RTCNO3/8S	1,900.00	22.80

### COUNTERSUNK BARREL NUT DIMENSIONS (mm)

Description	Material	A	B	C	D
M4 x 12	304 S/S	7.8	2.3	12	5.3
M5 x 15	304 S/S	9.8	2.8	15	6.3
M6 x 20	304 S/S	11.8	3.3	20	8
M8 x 20	304 S/S	14.8	4.4	20	10
M10 x 27	304 S/S	20	4.7	27	13
10-24 UNC	304 S/S	12.5	5	22	6.3
5/16 UNC x 25	304 S/S	19	6	27	9.6
3/8 UNC x 32	304 S/S	19.5	5.5	32	12.6

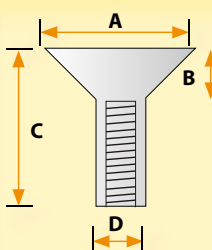





## Resytork Button Head Barrel Nuts

304 Stainless | Galvanised | Zinc

**RESYTORK**



GAUGE LENGTH		M4			M5			M6		
		Driver: T20	Pack: 100		Driver: T25	Pack: 100		Driver: T30	Pack: 100	
		Part No.	\$ / 100	\$ / Ea	Part No.	\$ / 100	\$ / Ea	Part No.	\$ / 100	\$ / Ea
10mm	Stainless	RTBN0410	168.00	2.10	RTBN0510	209.00	2.61			
12mm	Stainless							RTBN0612	265.00	3.31
25mm	Stainless							RTBN0625	320.00	4.00

GAUGE LENGTH		M8			M10			M12		
		Driver: T40	Pack: 100		Driver: T45	Pack: 100		Driver: T50	Pack: 100	
		Part No.	\$ / 100	\$ / Ea	Part No.	\$ / 100	\$ / Ea	Part No.	\$ / 100	\$ / Ea
16mm	Stainless	RTBN0816	368.00	4.60						
20mm	Stainless				RTBN1020	485.00	6.06			
28mm	Galvanised				RTBN10G	195.00	2.34			
28mm	Zinc				RTBN10Z	175.00	2.10			
28mm	Stainless				RTBN1028	500.00	6.25			
30mm	Stainless	RTBN0830	458.00	5.73						
35mm	Galvanised							RTBN12-G	300.00	3.60

GAUGE LENGTH		10-24 UNC			5/16 UNC			3/8 UNC		
		Driver: T10	Pack: 100		Driver: T10	Pack: 100		Driver: T45	Pack: 100	
		Part No.	\$ / 100	\$ / Ea	Part No.	\$ / 100	\$ / Ea	Part No.	\$ / 100	\$ / Ea
16mm	Stainless							RTBN3/8S	500.00	6.00
19mm	Stainless	RTBN3/16FS	490.00	5.88	RTBN5/16FS	750.00	9.00			
28mm	Zinc							RTBN3/8Z	175.00	2.10

**BUTTON HEAD BARREL NUT DIMENSIONS (mm)**

Description	Material	A	B	C	D
M4 x 10	304 S/S	9.2	2.75	10	5.3
M5 x 10	304 S/S	10.2	3.3	10	6.3
M6 x 12	304 S/S	11.8	4.4	12	8
M6 x 25	304 S/S	11.8	4.4	25	8
M8 x 16	304 S/S	14.6	5	16	10
M8 x 30	304 S/S	14.5	5	30	10
M10 x 20	304 S/S	18.5	5.8	20	12.5
M10 x 28	304 S/S	22	8	28	14
M10 x 28	Zinc/Galv	21	6	28	13.5
M12 x 35	Galvanised	25.2	5	35	16.5
10-24 UNC x 19	304 S/S	11	3.5	19	6.3
5/16 UNC x 19	304 S/S	16.4	5	19	9.6
3/8 UNC x 16	304 S/S	23	6	16	12.6
3/8 UNC x 28	Zinc/Galv	21	6	28	13.5

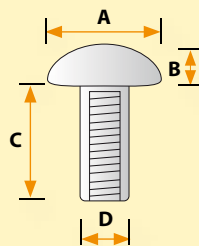



Available in other materials by special order (minimum order quantities apply).



Self tappers can be substituted for wood screws.



Head dimensions on page 60.



Requires matching tooling for installation/ removal – see page 54.



Manufactured with an internal pin in the socket recess to repel standard hexagon tools.



Imperial sizes available to order.



Tooling available as either insert bits or key wrenches.



Can be made to order in alternative materials and other style screws, such as cap screws and grub screws, subject to minimum order quantities.



Manufactured in 304 (A2 or 18-8 grade) stainless.



## Pin Hex Countersunk Self Tappers

AB Type Thread | 304 Stainless Steel

GAUGE LENGTH		6 GAUGE (3.5mm)			8 GAUGE (4.2mm)			10 GAUGE (4.8mm)		
		Driver: H30	Pack: 100		Driver: H40	Pack: 100		Driver: H40	Pack: 100	
		Part No.	\$ / 100	\$ / Ea	Part No.	\$ / 100	\$ / Ea	Part No.	\$ / 100	\$ / Ea
3/8"	9.5mm	PHCS6C	82.10	0.99						
1/2"	13mm	PHCS6D	85.10	1.02	PHCS8D	92.10	1.11	PHCS10D	106.10	1.27
5/8"	16mm	PHCS6E	87.80	1.05	PHCS8E	94.80	1.14	PHCS10E	110.30	1.32
3/4"	19mm	PHCS6F	90.20	1.08	PHCS8F	97.30	1.17	PHCS10F	117.30	1.41
1"	25mm	PHCS6G	98.20	1.18	PHCS8G	107.30	1.29	PHCS10G	136.00	1.63
1 1/4"	32mm				PHCS8H	114.90	1.38	PHCS10H	137.70	1.65
1 1/2"	38mm	PHCS6I	121.30	1.46	PHCS8I	135.80	1.63	PHCS10I	160.50	1.93
2"	50mm				PHCS8J	149.80	1.80	PHCS10J	182.40	2.19
2 1/2"	63mm							PHCS10K	210.60	2.53

GAUGE LENGTH		12 GAUGE (5.5mm)			14 GAUGE (6.3mm)		
		Driver: H40	Pack: 100		Driver: H40	Pack: 100	
		Part No.	\$ / 100	\$ / Ea	Part No.	\$ / 100	\$ / Ea
5/8"	16mm	PHCS12E	156.60	1.88			
3/4"	19mm	PHCS12F	159.00	1.91	PHCS14F	205.00	2.46
1"	25mm	PHCS12G	163.80	1.97	PHCS14G	256.00	3.07
1 1/4"	32mm	PHCS12H	166.00	1.99	PHCS14H	283.60	3.40
1 1/2"	38mm	PHCS12I	221.60	2.66	PHCS14I	342.00	4.10
2"	50mm	PHCS12J	253.00	3.04	PHCS14J	387.00	4.64







## Pin Hex Button Head Self Tappers

AB Type Thread | 304 Stainless Steel

GAUGE  LENGTH		6 GAUGE (3.5mm)			8 GAUGE (4.2mm)			10 GAUGE (4.8mm)		
		Driver: H30	Pack: 100		Driver: H40	Pack: 100		Driver: H40	Pack: 100	
		Part No.	\$ / 100	\$ / Ea	Part No.	\$ / 100	\$ / Ea	Part No.	\$ / 100	\$ / Ea
3/8"	9.5mm	PHBS6C	82.10	0.99	PHBS8C	100.20	1.20			
1/2"	13mm	PHBS6D	85.10	1.02	PHBS8D	103.60	1.24	PHBS10D	119.30	1.43
5/8"	16mm	PHBS6E	87.80	1.05	PHBS8E	106.70	1.28	PHBS10E	124.10	1.49
3/4"	19mm	PHBS6F	90.20	1.08	PHBS8F	109.40	1.31	PHBS10F	131.90	1.58
1"	25mm	PHBS6G	108.00	1.30	PHBS8G	120.70	1.45	PHBS10G	142.20	1.71
1 1/4"	32mm				PHBS8H	129.20	1.55	PHBS10H	154.90	1.86
1 1/2"	38mm	PHBS6I	121.30	1.46	PHBS8I	152.80	1.83	PHBS10I	180.50	2.17
2"	50mm				PHBS8J	168.60	2.02	PHBS10J	205.20	2.46
2 1/2"	63mm							PHBS10K	237.00	2.84

GAUGE  LENGTH		12 GAUGE (5.5mm)			14 GAUGE (6.3mm)		
		Driver: H40	Pack: 100		Driver: H40	Pack: 100	
		Part No.	\$ / 100	\$ / Ea	Part No.	\$ / 100	\$ / Ea
5/8"	16mm	PHBS12E	179.30	2.15	PHBS14E	229.30	2.75
3/4"	19mm	PHBS12F	183.00	2.20	PHBS14F	234.40	2.81
1"	25mm	PHBS12G	187.20	2.25	PHBS14G	310.10	3.72
1 1/4"	32mm	PHBS12H	189.70	2.28	PHBS14H	325.60	3.91
1 1/2"	38mm	PHBS12I	253.20	3.04	PHBS14I	342.00	4.10
2"	50mm	PHBS12J	268.00	3.22	PHBS14J	387.00	4.64



## Pin Hex Raised Head Countersunk Machine Screws

304 Stainless Steel

GAUGE  LENGTH		M3.5		
		Driver: H30	Pack: 100	
		Part No.	\$ / 100	\$ / Ea
12mm		PHOM3512	297.20	3.57
20mm		PHOM3520	300.20	3.60
25mm		PHOM3525	307.40	3.69
30mm		PHOM3530	317.60	3.81
40mm		PHOM3540	326.60	3.92
50mm		PHOM3550	347.40	4.17
60mm		PHOM3560	368.40	4.42





## Pin Hex Countersunk Machine Screws

304 Stainless Steel



Manufactured with an internal pin in the socket recess to repel standard hexagon tools



Tooling available as either insert bits or key wrenches.



Manufactured in 304 (A2 or 18-8 grade) stainless.



Requires matching tooling for installation/ removal – see page 54.



GAUGE	M3		
	Driver: H30	Pack: 100	
LENGTH	Part No.	\$ / 100	\$ / Ea
6mm	PHCM306	104.60	1.26
10mm	PHCM310	109.40	1.31
12mm	PHCM312	110.80	1.33
16mm	PHCM316	113.40	1.36
20mm	PHCM320	115.60	1.39

GAUGE	M4			M5			M6		
	Driver: H40	Pack: 100		Driver: H40	Pack: 100		Driver: H40	Pack: 100	
LENGTH	Part No.	\$ / 100	\$ / Ea	Part No.	\$ / 100	\$ / Ea	Part No.	\$ / 100	\$ / Ea
6mm	PHCM406	69.00	0.83						
8mm	PHCM408	71.80	0.86	PHCM508	94.00	1.13	PHCM608	104.80	1.26
10mm	PHCM410	76.00	0.91	PHCM510	96.50	1.16	PHCM610	106.20	1.27
12mm	PHCM412	77.40	0.93	PHCM512	98.60	1.18	PHCM612	107.00	1.28
14mm	PHCM414	79.00	0.95						
16mm	PHCM416	80.00	0.96	PHCM516	104.00	1.25	PHCM616	108.30	1.30
20mm	PHCM420	85.10	1.02	PHCM520	110.10	1.32	PHCM620	116.50	1.40
25mm	PHCM425	90.90	1.09	PHCM525	122.80	1.47	PHCM625	134.00	1.61
30mm	PHCM430	109.10	1.31	PHCM530	130.60	1.57	PHCM630	142.50	1.71
40mm	PHCM440	125.80	1.51	PHCM540	152.10	1.83	PHCM640	165.70	1.99
45mm							PHCM645	175.70	2.11
50mm	PHCM450	340.00	4.08	PHCM550	168.90	2.03	PHCM650	184.40	2.21
60mm				PHCM560	199.00	2.39	PHCM660	215.90	2.59
75mm							PHCM675	244.40	2.93

GAUGE	M8			M10			M12		
	Driver: H50	Pack: 100		Driver: H60	Pack: 100		Driver: H60	Pack: 100	
LENGTH	Part No.	\$ / 100	\$ / Ea	Part No.	\$ / 100	\$ / Ea	Part No.	\$ / 100	\$ / Ea
12mm	PHCM812	183.10	2.20						
16mm	PHCM816	183.10	2.20						
20mm	PHCM820	197.40	2.37	PHCM1020	325.80	3.91	PHCM1220	1,090.50	13.09
25mm	PHCM825	215.90	2.59	PHCM1025	357.50	4.29	PHCM1225	1,109.00	13.31
30mm	PHCM830	243.20	2.92	PHCM1030	374.10	4.49	PHCM1230	1,114.00	13.37
40mm	PHCM835	296.80	3.56						
45mm	PHCM840	281.10	3.37	PHCM1040	399.00	4.79	PHCM1240	1,120.00	13.44
50mm	PHCM850	316.20	3.79	PHCM1050	446.40	5.36	PHCM1250	1,209.00	14.51
60mm	PHCM860	367.70	4.41	PHCM1060	479.20	5.75	PHCM1260	1,446.00	17.35



## Pin Hex Button Head Machine Screws

304 Stainless Steel

### Pin Hex Socket Specials

– made to order

Socket cap screws, grub screws etc.



GAUGE LENGTH	M3		
	Driver: H20	Pack: 100	
	Part No.	\$ / 100	\$ / Ea
10mm	PHBM310	109.40	1.31
12mm	PHBM312	110.80	1.33
16mm	PHBM316	113.40	1.36
20mm	PHBM320	115.60	1.39

GAUGE LENGTH	M4			M5			M6		
	Driver: H40	Pack: 100		Driver: H40	Pack: 100		Driver: H40	Pack: 100	
	Part No.	\$ / 100	\$ / Ea	Part No.	\$ / 100	\$ / Ea	Part No.	\$ / 100	\$ / Ea
6mm	PHBM406	69.00	0.83						
8mm	PHBM408	71.80	0.86				PHBM608	104.00	1.25
10mm	PHBM410	76.00	0.91	PHBM510	96.50	1.16	PHBM610	106.20	1.27
12mm	PHBM412	77.40	0.93	PHBM512	98.60	1.18	PHBM612	107.00	1.28
16mm	PHBM416	80.00	0.96	PHBM516	104.00	1.25	PHBM616	108.30	1.30
20mm	PHBM420	85.10	1.02	PHBM520	110.10	1.32	PHBM620	116.50	1.40
25mm	PHBM425	90.90	1.09	PHBM525	122.80	1.47	PHBM625	134.00	1.61
30mm	PHBM430	109.10	1.31	PHBM530	130.60	1.57	PHBM630	142.50	1.71
35mm				PHBM535	142.80	1.71	PHBM635	150.00	1.80
40mm	PHBM440	138.40	1.66	PHBM540	152.10	1.83	PHBM640	165.70	1.99
45mm							PHBM645	175.70	2.11
50mm				PHBM550	177.40	2.12	PHBM650	184.40	2.21
60mm				PHBM560	196.00	2.35	PHBM660	215.90	2.59
65mm							PHBM665	244.40	2.93

GAUGE LENGTH	M8			M10			M12		
	Driver: H50	Pack: 100		Driver: H60	Pack: 100		Driver: H80	Pack: 100	
	Part No.	\$ / 100	\$ / Ea	Part No.	\$ / 100	\$ / Ea	Part No.	\$ / 100	\$ / Ea
10mm	PHBM810	178.00	2.14						
12mm	PHBM812	180.00	2.16						
16mm	PHBM816	183.10	2.20	PHBM1016	228.00	2.74			
20mm	PHBM820	197.40	2.37	PHBM1020	232.70	2.79	PHBM1220	1,096.80	13.16
25mm	PHBM825	215.90	2.59	PHBM1025	255.40	3.06	PHBM1225	1,114.90	13.38
30mm	PHBM830	243.20	2.92	PHBM1030	334.40	4.01	PHBM1230	1,133.40	13.60
35mm	PHBM835	276.00	3.31						
40mm	PHBM840	281.10	3.37	PHBM1040	356.30	4.28	PHBM1240	1,192.40	14.31
50mm	PHBM850	316.20	3.79	PHBM1050	398.60	4.78	PHBM1250	1,240.60	14.89
60mm	PHBM860	367.70	4.41	PHBM1060	427.90	5.13	PHBM1260	1,446.00	17.35
100mm				PHBM10100	506.80	6.08			

PIN HEX







Manufactured with an internal pin in the socket recess to repel standard hexagon tools



Tooling available as either insert bits or key wrenches.



Manufactured in 304 (A2 or 18-8 grade) stainless.



Requires matching tooling for installation/ removal – see page 54.



## Pin Hex Countersunk Self Tappers – Metric Drive Recess

304 Stainless Steel

GAUGE		6 GAUGE (3.5mm)		
		Driver: H2M	Pack: 100	
		Part No.	\$ / 100	\$ / Ea
1/2"	13mm	PHCS6D-M	85.10	1.02
5/8"	16mm	PHCS6E-M	94.80	1.14



## Pin Hex Button Head Self Tappers – Metric Drive Recess

304 Stainless Steel

GAUGE		6 GAUGE (3.5mm)			8 GAUGE (4.2mm)			10 GAUGE (4.8mm)		
		Driver: H2M	Pack: 100		Driver: H25M	Pack: 100		Driver: H3M	Pack: 100	
		Part No.	\$ / 100	\$ / Ea	Part No.	\$ / 100	\$ / Ea	Part No.	\$ / 100	\$ / Ea
3/8"	9.5mm				PHBS8C-M	100.20	1.20			
1/2"	13mm	PHBS6D-M	85.10	1.02				PHBS10D-M	119.30	1.43
3/4"	19mm				PHBS8F-M	109.40	1.31			
1 1/4"	32mm							PHBS10H-M	154.90	1.86



## Pin Hex Countersunk Machine Screws – Metric Drive Recess

304 Stainless Steel

GAUGE		M3			M4			M5		
		Driver: H2M	Pack: 100		Driver: H25M	Pack: 100		Driver: H3M	Pack: 100	
		Part No.	\$ / 100	\$ / Ea	Part No.	\$ / 100	\$ / Ea	Part No.	\$ / 100	\$ / Ea
6mm		PHCM306-M	104.60	1.26	PHCM406-M	69.00	0.83			
8mm					PHCM408-M	75.40	0.90			
10mm					PHCM410-M	76.00	0.91	PHCM510-M	96.50	1.16
12mm					PHCM412-M	77.40	0.93	PHCM512-M	98.60	1.18
16mm					PHCM416-M	80.00	0.96			
20mm					PHCM420-M	85.10	1.02	PHCM520-M	110.10	1.32
25mm					PHCM425-M	90.90	1.09			



## Pin Hex Button Head Machine Screws – Metric Drive Recess

304 Stainless Steel

GAUGE LENGTH	M3			M4			M5		
	Driver: H2M	Pack: 100		Driver: H25M	Pack: 100		Driver: H3M	Pack: 100	
	Part No.	\$ / 100	\$ / Ea	Part No.	\$ / 100	\$ / Ea	Part No.	\$ / 100	\$ / Ea
8mm				PHBM408-M	71.80	0.86			
10mm				PHBM410-M	76.00	0.91	PHBM510-M	96.50	1.16
12mm	PHBM312-M	110.80	1.33	PHBM412-M	77.40	0.93	PHBM512-M	98.60	1.18
16mm				PHBM416-M	80.00	0.96	PHBM516-M	104.00	1.25
20mm				PHBM420-M	85.10	1.02	PHBM520-M	110.10	1.32
25mm				PHBM425-M	90.90	1.09	PHBM525-M	122.80	1.47
30mm							PHBM530-M	130.60	1.57
35mm							PHBM535-M	142.80	1.71



## Pin Hex Imperial Countersunk Machine Screws

GAUGE LENGTH	10-24 UNC		
	Driver: H40	Pack: 100	
	Part No.	\$ / 100	\$ / Ea
3/8"	PHCM1024C	92.00	1.10
1"	PHCM1024G	99.00	1.19



## Pin Hex Imperial Button Head Machine Screws

GAUGE		6-32 UNC			8-32 UNC			10-24 UNC		
		Driver:H30	Pack: 100		Driver:H40	Pack: 100		Driver:H40	Pack: 100	
LENGTH		Part No.	\$ / 100	\$ / Ea	Part No.	\$ / 100	\$ / Ea	Part No.	\$ / 100	\$ / Ea
1/4"	7mm	PHBM632A	88.00	1.06	PHBM832A	89.00	1.07	PHBM1024A	91.00	1.09
1/2"	13mm	PHBM632D	91.00	1.09	PHBM832D	92.00	1.10	PHBM1024D	94.00	1.13
3/4"	19mm	PHBM632F	93.00	1.12	PHBM832F	94.00	1.13	PHBM1024F	95.00	1.14
1"	25mm	PHBM632G	95.00	1.14	PHBM832G	95.00	1.14	PHBM1024G	96.00	1.15
1 1/2"	38mm	PHBM632I	112.00	1.34	PHBM832I	112.00	1.34			
2"	50mm	PHBM632J	240.00	2.88						

GAUGE		10-32 UNF			1/4 - 20 UNC			3/8 - 16 UNC		
		Driver: H40	Pack: 100		Driver: H40	Pack: 100		Driver: H7/32	Pack: 100	
LENGTH		Part No.	\$ / 100	\$ / Ea	Part No.	\$ / 100	\$ / Ea	Part No.	\$ / 100	\$ / Ea
5/8"	16mm	PHBM1032E	95.00	1.14	PHBM1/4E	116.00	1.39	PHBM3/8E	429.00	5.15
3/4"	19mm	PHBM1032F	95.00	1.14	PHBM1/4F	118.00	1.42			
1"	25mm	PHBM1032G	96.00	1.15	PHBM1/4G	120.00	1.44	PHBM3/8G	833.80	10.01
1 1/2"	38mm	PHBM1032I	115.00	1.38	PHBM1/4I	146.00	1.75	PHBM3/8I	644.00	7.73
2"	50mm				PHBM1/4J	165.00	1.98	PHBM3/8J	702.00	8.42
2 1/2"	63mm				PHBM1/4K*	184.00	2.21	PHBM3/8K	811.00	9.73
4"	100mm				PHBM1/4N*	203.00	2.44			

Other sizes available to order.

\*=Zinc





Head dimensions – see page 60.



Specials made to order – Please call sales team for assistance.



Made to measure with this drive system:

Male & female bolts, grub screw, large disc head, glass screws etc.



Self tappers can be substituted for wood screws.



Requires matching tooling – see page 54.



Designed for low to medium torque applications.



Visual appeal.



Manufactured in 304 (A2 or 18-8 grade) stainless.

2 HOLE



## 2 Hole Countersunk Self Tappers

AB Type Thread – 304 Stainless Steel



GAUGE LENGTH		4 GAUGE (2.9mm)			6 GAUGE (3.5mm)			8 GAUGE (4.2mm)		
		Driver: TH3	Pack: 100		Driver: TH4	Pack: 100		Driver: TH5	Pack: 100	
		Part No.	\$ / 100	\$ / Ea	Part No.	\$ / 100	\$ / Ea	Part No.	\$ / 100	\$ / Ea
3/8"	9.5mm	THCS4C	74.00	0.89	THCS6C	78.30	0.94	THCS8C	88.10	1.06
1/2"	13mm	THCS4D	75.60	0.91	THCS6D	80.30	0.96	THCS8D	89.40	1.07
5/8"	16mm				THCS6E	81.10	0.97	THCS8E	90.50	1.09
3/4"	19mm	THCS4F	77.30	0.93	THCS6F	82.40	0.99	THCS8F	91.80	1.10
1"	25mm	THCS4G	79.80	0.96	THCS6G	83.50	1.00	THCS8G	93.30	1.12
1 1/4"	32mm	THCS4H	79.80	0.96	THCS6H	90.20	1.08	THCS8H	100.40	1.20
1 1/2"	38mm	THCS4I	81.50	0.98	THCS6I	100.00	1.20	THCS8I	109.60	1.32
2"	50mm				THCS6J	116.60	1.40	THCS8J	124.70	1.50

GAUGE LENGTH		10 GAUGE (4.8mm)			12 GAUGE (5.5mm)			14 GAUGE (6.3mm)		
		Driver: TH6	Pack: 100		Driver: TH7	Pack: 100		Driver: TH8	Pack: 100	
		Part No.	\$ / 100	\$ / Ea	Part No.	\$ / 100	\$ / Ea	Part No.	\$ / 100	\$ / Ea
1/2"	13mm	THCS10D	90.30	1.08						
5/8"	16mm	THCS10E	92.00	1.10				THCS14E	143.10	1.72
3/4"	19mm	THCS10F	93.00	1.12				THCS14F	144.00	1.73
1"	25mm	THCS10G	94.80	1.14	THCS12G	125.00	1.50	THCS14G	144.80	1.74
1 1/4"	32mm	THCS10H	97.80	1.17				THCS14H	156.70	1.88
1 1/2"	38mm	THCS10I	112.20	1.35	THCS12I	143.90	1.73	THCS14I	159.20	1.91
2"	50mm	THCS10J	125.10	1.50	THCS12J	158.60	1.90	THCS14J	171.70	2.06
2 1/2"	63mm	THCS10K	162.90	1.95						





2 HOLE



## 2 Hole Pan Head Self Tappers

AB Type Thread – 304 Stainless Steel

GAUGE		4 GAUGE (2.9mm)			6 GAUGE (3.5mm)			8 GAUGE (4.2mm)		
		Driver: TH3			Driver: TH4			Driver: TH5		
		Pack: 100			Pack: 100			Pack: 100		
LENGTH		Part No.	\$ / 100	\$ / Ea	Part No.	\$ / 100	\$ / Ea	Part No.	\$ / 100	\$ / Ea
1/4"	6.35mm				THPS6A	132.00	1.58			
3/8"	9.5mm	THPS4C	74.00	0.89	THPS6C	78.30	0.94	THPS8C	88.10	1.06
1/2"	13mm	THPS4D	75.60	0.91	THPS6D	80.30	0.96	THPS8D	89.40	1.07
5/8"	16mm	THPS4E	76.50	0.92	THPS6E	81.10	0.97	THPS8E	90.50	1.09
3/4"	19mm	THPS4F	77.30	0.93	THPS6F	82.40	0.99	THPS8F	91.80	1.10
1"	25mm	THPS4G	80.10	0.96	THPS6G	83.50	1.00	THPS8G	93.30	1.12
1 1/4"	32mm				THPS6H	90.20	1.08	THPS8H	100.40	1.20
1 1/2"	38mm	THPS4I	81.50	0.98	THPS6I	100.00	1.20	THPS8I	109.60	1.32
2"	50mm				THPS6J	116.60	1.40	THPS8J	124.70	1.50

GAUGE		10 GAUGE (4.8mm)			12 GAUGE (5.5mm)			14 GAUGE (6.3mm)		
		Driver: TH6			Driver: TH7			Driver: TH8		
		Pack: 100			Pack: 100			Pack: 100		
LENGTH		Part No.	\$ / 100	\$ / Ea	Part No.	\$ / 100	\$ / Ea	Part No.	\$ / 100	\$ / Ea
3/8"	9.5mm	THPS10C	90.30	1.08						
1/2"	13mm	THPS10D	92.00	1.10	THPS12D	125.00	1.50	THPS14D	140.70	1.69
5/8"	16mm	THPS10E	93.00	1.12				THPS14E	143.10	1.72
3/4"	19mm	THPS10F	94.80	1.14				THPS14F	144.00	1.73
1"	25mm	THPS10G	97.80	1.17	THPS12G	134.40	1.61	THPS14G	144.80	1.74
1 1/4"	32mm	THPS10H	112.20	1.35				THPS14H	156.70	1.88
1 1/2"	38mm	THPS10I	125.10	1.50				THPS14I	159.20	1.91
2"	50mm	THPS10J	162.90	1.95	THPS12J	158.60	1.90	THPS14J	171.70	2.06
2 1/2"	63mm	THPS10K	164.10	1.97						



Manufactured in 304 (A2 or 18-8 grade) stainless.



Imperial sizes available to order.



Head dimensions – see page 60.



Matching tool required – see page 54.



Designed for low to medium torque applications.



Visual appeal.



Specials made to order. Please call sales team for assistance.

Insert bit to suit – see page 54.



## 2 Hole Countersunk Machine Screws

304 Stainless Steel

GAUGE LENGTH	M3			M4			M5		
	Driver: TH3	Pack: 100		Driver: TH5	Pack: 100		Driver: TH6	Pack: 100	
	Part No.	\$ / 100	\$ / Ea	Part No.	\$ / 100	\$ / Ea	Part No.	\$ / 100	\$ / Ea
8mm	THCM308	107.10	1.29						
10mm	THCM310	110.00	1.32	THCM410	115.90	1.39			
12mm	THCM312	111.30	1.34	THCM412	117.20	1.41	THCM512	117.80	1.41
16mm	THCM316	113.20	1.36	THCM416	119.20	1.43	THCM516	119.00	1.43
20mm	THCM320	117.60	1.41	THCM420	120.70	1.45	THCM520	124.40	1.49
25mm	THCM325	120.80	1.45	THCM425	125.70	1.51	THCM525	131.20	1.57
30mm	THCM330	130.80	1.57	THCM430	124.40	1.49	THCM530	141.90	1.70
35mm	THCM335	138.60	1.66	THCM435	137.60	1.65	THCM535	150.00	1.80

GAUGE LENGTH	M6		
	Driver: TH8	Pack: 100	
	Part No.	\$ / 100	\$ / Ea
12mm	THCM612	143.40	1.72
16mm	THCM616	152.20	1.83
20mm	THCM620	161.40	1.94
25mm	THCM625	164.00	1.97
30mm	THCM630	175.10	2.10
40mm	THCM640	211.80	2.54



## 2 Hole Raised Head Countersunk Machine Screws

304 Stainless Steel



GAUGE LENGTH	M3.5		
	Driver: TH4	Pack: 100	
	Part No.	\$ / 100	\$ / Ea
12mm	THOM3512	107.40	1.29
25mm	THOM3525	124.30	1.49
30mm	THOM3530	130.90	1.57
40mm	THOM3540	150.70	1.81
50mm	THOM3550	161.70	1.94



## 2 Hole Pan Head Machine Screws

304 Stainless Steel



2 HOLE



GAUGE	M3			M4			M5		
	Driver: TH3	Pack: 100		Driver: TH5	Pack: 100		Driver: TH6	Pack: 100	
LENGTH	Part No.	\$ / 100	\$ / Ea	Part No.	\$ / 100	\$ / Ea	Part No.	\$ / 100	\$ / Ea
6mm				THPM406	113.70	1.36			
10mm	THPM310	110.00	1.32	THPM410	115.90	1.39			
12mm	THPM312	111.30	1.34	THPM412	117.20	1.41	THPM512	117.80	1.41
16mm	THPM316	113.20	1.36	THPM416	119.20	1.43	THPM516	119.00	1.43
20mm				THPM420	120.70	1.45	THPM520	124.40	1.49
25mm				THPM425	125.70	1.51	THPM525	131.20	1.57
30mm							THPM530	141.90	1.70

GAUGE	M6		
	Driver: TH8	Pack: 100	
LENGTH	Part No.	\$ / 100	\$ / Ea
12mm	THPM612	143.40	1.72
14mm	THPM614	147.90	1.77
16mm	THPM616	152.20	1.83
20mm	THPM620	161.40	1.94
25mm	THPM625	164.00	1.97
30mm	THPM630	175.10	2.10
40mm	THPM640	211.80	2.54



## 2 Hole Specials

Made to measure – see pages 58 & 59





## 2 Hole Pan Head Machine Screws

GAUGE LENGTH		6-32 UNC			8-32 UNC		
		Driver: TH4	Pack: 100		Driver: TH5	Pack: 100	
		Part No.	\$ / 100	\$ / Ea	Part No.	\$ / 100	\$ / Ea
1/2"	13mm	THPM632D	79.80	0.96	THPM832D	84.80	1.02
3/4"	19mm	THPM632F	81.80	0.98	THPM832F	89.00	1.07
1"	25mm	THPM632G	82.80	0.99	THPM832G	91.00	1.09
1 1/2"	38mm	THPM632I	98.00	1.18	THPM832I	100.00	1.20
2"	50mm	THPM632J	115.00	1.38	THPM832J	124.90	1.50
3"	75mm	THPM632L	134.00	1.61			

GAUGE LENGTH		10-24 UNC			10-32 UNF			1/4 - 20 UNC		
		Driver: TH6	Pack: 100		Driver: TH6	Pack: 100		Driver: TH8	Pack: 100	
		Part No.	\$ / 100	\$ / Ea	Part No.	\$ / 100	\$ / Ea	Part No.	\$ / 100	\$ / Ea
1/2"	13mm	THPM1024D	119.00	1.42	THPM1032D	91.00	1.09	THPM1/4D	139.00	1.67
3/4"	19mm	THPM1024F	94.00	1.13	THPM1032F	94.00	1.13	THPM1/4F	142.00	1.70
1"	25mm	THPM1024G	96.00	1.15	THPM1032G	96.00	1.15	THPM1/4G	144.00	1.73
1 1/2"	38mm	THPM1024I	124.90	1.50	THPM1032I	124.00	1.49	THPM1/4I	157.00	1.88



## 2 Hole Imperial Countersunk Machine Screws

GAUGE LENGTH		6-32 UNC		
		Driver: TH4	Pack: 100	
		Part No.	\$ / 100	\$ / Ea
3/8"	9.5mm	THCM632C	77.90	0.93
1/2"	13mm	THCM632D	79.90	0.96
3/4"	19mm	THCM632F	82.00	0.98
1"	25mm	THCM632G	83.00	1.00
1 1/2"	38mm	THCM632I	99.00	1.19

GAUGE LENGTH		8-32 UNC			10-24 UNC			1/4 - 20 UNC		
		Driver: TH5	Pack: 100		Driver: TH6	Pack: 100		Driver: TH8	Pack: 100	
		Part No.	\$ / 100	\$ / Ea	Part No.	\$ / 100	\$ / Ea	Part No.	\$ / 100	\$ / Ea
1/2"	13mm	THCM832D	87.00	1.04	THCM1024D	91.00	1.09	THCM1/4D	141.00	1.69
3/4"	19mm	THCM832F	90.00	1.08	THCM1024F	94.00	1.13	THCM1/4F	142.00	1.70
1"	25mm	THCM832G	91.00	1.09	THCM1024G	97.00	1.16	THCM1/4G	144.00	1.73
1 1/2"	38mm	THCM832I	100.00	1.20	THCM1024I	124.00	1.49	THCM1/4I	158.00	1.90



## 2 Hole Security Nut

GAUGE		1/4 - 20 UNC		
		Driver: THND 1/4	Pack: 100	
		Part No.	\$ / 100	\$ / Ea
Zinc Alloy		THSN1/4	550.00	6.60
Driver		THND1/4		55.00

GAUGE		M6			M8			M10		
		Driver: THND 1/4	Pack: 100		Driver: THND 1/4	Pack: 100		Driver: THND 1/4	Pack: 100	
		Part No.	\$ / 100	\$ / Ea	Part No.	\$ / 100	\$ / Ea	Part No.	\$ / 100	\$ / Ea
Zinc Alloy		THSN6	550.00	6.60	THSN8	550.00	6.60	THSN10	550.00	6.60
Driver		THND1/4		55.00	THND1/4		55.00	THND1/4		55.00



Clutch Head One Way screws only operate in a clockwise motion.



Ideal for permanent fixtures.



No specialist tools required for installation. Uses standard slotted screwdriver.



Probably the worlds first security screw.



Manufactured in 304 (A2 or 18-8 grade) stainless steel and zinc plated hardened steel.



Chrome plated Barrel Nuts and Shoulder screws also stocked.



Imperial sizes available to order.



Removal tool available – see page 55.



## Clutch Head Round Head Machine Screws

Clear Zinc Plated

GAUGE	M5			M6		
	Driver: SLDB	Pack: 100		Driver: SLD10	Pack: 100	
LENGTH	Part No.	\$ / 100	\$ / Ea	Part No.	\$ / 100	\$ / Ea
20mm	CHRM520-Z	58.50	0.70	CHRM620-Z	45.00	0.54

Number plate application. Special pricing on bulk buys.



## Clutch Head Round Head Machine Screws

304 Stainless Steel

GAUGE	M4			M5			M6		
	Driver: SLD5	Pack: 100		Driver: SLD8	Pack: 100		Driver: SLD10	Pack: 100	
LENGTH	Part No.	\$ / 100	\$ / Ea	Part No.	\$ / 100	\$ / Ea	Part No.	\$ / 100	\$ / Ea
12mm	CHRM412	72.00	0.86						
16mm	CHRM416	76.00	0.91	CHRM516	100.00	1.20			
20mm	CHRM420	81.00	0.97	CHRM520	106.00	1.27	CHRM620	112.00	1.34
25mm	CHRM425	86.00	1.03	CHRM525	118.00	1.42	CHRM625	130.00	1.56
30mm	CHRM430	105.00	1.26	CHRM530	126.00	1.51	CHRM630	138.00	1.66
40mm	CHRM440	134.00	1.61	CHRM540	148.00	1.78	CHRM640	161.00	1.93
50mm							CHRM650	180.00	2.16



Clutch Head One Way screws only operate in a clockwise motion.  
Ideal for permanent fixtures.



No specialist tools required for installation. Uses standard slotted screwdriver.



Probably the worlds first security screw.



Manufactured in 304 (A2 or 18-8 grade) stainless steel and zinc plated hardened steel.



Chrome plated Barrel Nuts and Shoulder screws also stocked.



Imperial sizes available to order.



Removal tool available – see page 55.



## Clutch Head Countersunk Self Tappers

AB Type Thread | 304 Stainless Steel

GAUGE		6 GAUGE (3.5mm)			8 GAUGE (4.2mm)			10 GAUGE (4.8mm)		
		Driver: SLD5			Driver: SLD8			Driver: SLD8		
		Pack: 100			Pack: 100			Pack: 100		
LENGTH		Part No.	\$ / 100	\$ / Ea	Part No.	\$ / 100	\$ / Ea	Part No.	\$ / 100	\$ / Ea
1/2"	13mm				CHCS8D	47.90	0.57			
3/4"	19mm	CHCS6F	35.00	0.42	CHCS8F	50.70	0.61			
1"	25mm	CHCS6G	49.70	0.60	CHCS8G	53.50	0.64	CHCS10G	65.10	0.78
1 1/4"	32mm				CHCS8H	63.00	0.76	CHCS10H	67.90	0.81
1 1/2"	38mm				CHCS8I	63.70	0.76	CHCS10I	85.40	1.02
2"	50mm				CHCS8J	71.40	0.86	CHCS10J	121.10	1.45



## Clutch Head Round Head Self Tappers

AB Type Thread | 304 Stainless Steel

GAUGE		6 GAUGE (3.5mm)			8 GAUGE (4.2mm)			10 GAUGE (4.8mm)		
		Driver: SLD5			Driver: SLD8			Driver: SLD8		
		Pack: 100			Pack: 100			Pack: 100		
LENGTH		Part No.	\$ / 100	\$ / Ea	Part No.	\$ / 100	\$ / Ea	Part No.	\$ / 100	\$ / Ea
1/2"	13mm	CHRS6D	34.55	0.41	CHRS8D	47.78	0.57	CHRS10D	58.59	0.70
3/4"	19mm	CHRS6F	35.28	0.42	CHRS8F	51.03	0.61	CHRS10F	62.69	0.75
1"	25mm	CHRS6G	40.43	0.49	CHRS8G	52.50	0.63	CHRS10G	75.39	0.90
1 1/4"	32mm				CHRS8H	57.75	0.69	CHRS10H	76.65	0.92
1 1/2"	38mm				CHRS8I	63.00	0.76	CHRS10I	80.33	0.96
2"	50mm				CHRS8J	89.25	1.07	CHRS10J	84.53	1.01

GAUGE		14 GAUGE (6.3mm)		
		Driver: SLD10		
		Pack: 100		
LENGTH		Part No.	\$ / 100	\$ / Ea
1/2"	13mm	CHRS14D	71.93	0.86
3/4"	19mm	CHRS14F	97.13	1.17
1"	25mm	CHRS14G	135.03	1.62
1 1/2"	38mm	CHRS14I	135.77	1.63



## Clutch Head Round Head Self Tappers

Clear Zinc Plated

GAUGE		10 GAUGE (4.8mm)			12 GAUGE (5.5mm)		
		Driver: SLD8			Driver: SLD10		
		Pack: 100			Pack: 100		
LENGTH		Part No.	\$ / 100	\$ / Ea	Part No.	\$ / 100	\$ / Ea
3/4"	19mm	CHRS10F-Z	37.50	0.45	CHRS12F-Z	45.00	0.54

Number plate application. Special pricing on bulk buys.





## Clutch Head Shoulder Screws

Chrome Plated

GAUGE		10-24 GAUGE		
		Driver: SLD8	Pack: 100	
LENGTH		Part No.	\$ / 100	\$ / Ea
3/4"	19mm	CHSS1019	226.20	2.71
15/16"	23.4mm	CHSS1024	211.20	2.53
1 1/16"	26.1mm	CHSS1027	253.00	3.04
1 3/16"	30mm	CHSS1030	309.30	3.71
1 5/16"	33mm	CHSS1033	314.60	3.78



## Clutch Head Barrel Nuts

Chrome Plated

GAUGE		10-24 GAUGE		
		Driver: SLD8	Pack: 100	
LENGTH		Part No.	\$ / 100	\$ / Ea
1/2"	13mm	CHBN10D	250.30	3.00
5/8"	16mm	CHBN10E	254.80	3.06

CLUTCH HEAD

## Clutch Head Shoulder Screw and Barrel Nut Dimensions

LENGTH	DIMENSIONS						
	13mm 1/2"	16mm 5/8"	3/4"	15/16"	1 1/16"	1 3/16"	1 5/16"
Dimension A			18.7mm	23.4mm	26.1mm	30mm	33mm
			0.74"	0.92"	1.03"	1.18"	1.30"
Dimension B			6.8mm	4.8mm	6.6mm	6.6mm	6.7mm
			0.27"	0.19"	0.26"	0.26"	0.26"
Dimension C	12.6mm	15.9mm					
	0.50"	0.63"					

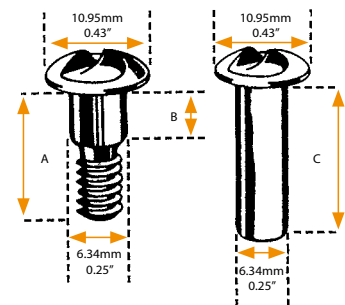

## Clutch Head Countersunk Twin Thread Woodscrews

Clear Zinc Plated

GAUGE		6 GAUGE (3.5mm)			8 GAUGE (4.2mm)			10 GAUGE (4.8mm)		
		Driver: SLD5	Pack: 100		Driver: SLD8	Pack: 100		Driver: SLD8	Pack: 100	
LENGTH		Part No.	\$ / 100	\$ / Ea	Part No.	\$ / 100	\$ / Ea	Part No.	\$ / 100	\$ / Ea
3/4"	19mm	CHCW6F-Z	23.30	0.28	CHCW8F-Z	28.30	0.34			
1"	25mm	CHCW6G-Z	30.90	0.37	CHCW8G-Z	31.20	0.37	CHCW10G-Z	39.50	0.47
1 1/4"	32mm				CHCW8H-Z	32.40	0.39	CHCW10H-Z	44.20	0.53
1 1/2"	38mm				CHCW8I-Z	39.80	0.48	CHCW10I-Z	51.70	0.62
2"	50mm				CHCW8J-Z	40.90	0.49	CHCW10J-Z	62.50	0.75

GAUGE		12 GAUGE (5.5mm)		
		Driver: SLD10	Pack: 100	
LENGTH		Part No.	\$ / 100	\$ / Ea
1 1/2"	38mm	CHCW12I-Z	65.90	0.79
2"	50mm	CHCW12J-Z	83.70	1.00
2 1/2"	63mm	CHCW12K-Z	97.80	1.17
3"	75mm	CHCW12L-Z	130.30	1.56





The original one way Pozidrive system.



Unique to Prolok – Design rights apply.



Fast, easy installation with power tools.



Most popular permanent option.



Other sizes and lengths available to order.



Manufactured in zinc plated steel, galvanized to order.



No specialist tools required for installation – use standard pozidrive bits or drivers.



## Sentinel® Countersunk Machine Screws

Clear Zinc Plated

GAUGE	M4			M5			M6		
	Driver: PZ2	Pack: 100		Driver: PZ2	Pack: 100		Driver: PZ3	Pack: 100	
LENGTH	Part No.	\$ / 100	\$ / Ea	Part No.	\$ / 100	\$ / Ea	Part No.	\$ / 100	\$ / Ea
12mm	STCM412	118.25	1.42	STCM512	120.45	1.45	STCM612	121.00	1.45
16mm	STCM416	119.35	1.43	STCM516	122.10	1.47	STCM616	123.20	1.48
20mm	STCM420	120.45	1.45	STCM520	123.75	1.49	STCM620	125.40	1.50
25mm	STCM425	121.00	1.45	STCM525	125.95	1.51	STCM625	128.15	1.54
30mm	STCM430	122.65	1.47	STCM530	131.45	1.58	STCM630	130.90	1.57
40mm				STCM540	286.00	3.43	STCM640	300.30	3.60



## Sentinel® Pan Head Machine Screws

Clear Zinc Plated

GAUGE	M4			M5			M6		
	Driver: PZ2	Pack: 100		Driver: PZ2	Pack: 100		Driver: PZ3	Pack: 100	
LENGTH	Part No.	\$ / 100	\$ / Ea	Part No.	\$ / 100	\$ / Ea	Part No.	\$ / 100	\$ / Ea
12mm	STBM412	118.25	1.42	STBM512	120.45	1.45	STBM612	121.00	1.45
16mm	STBM416	119.35	1.43	STBM516	122.10	1.47	STBM616	123.20	1.48
20mm	STBM420	120.45	1.45	STBM520	123.75	1.49	STBM620	125.40	1.50
25mm	STBM425	121.00	1.45	STBM525	125.95	1.51	STBM625	128.15	1.54
30mm	STBM430	122.65	1.47	STBM530	131.45	1.58	STBM630	130.90	1.57
40mm				STBM540	286.00	3.43	STBM640	300.30	3.60

GAUGE	M8		
	Driver: PZ4	Pack: 100	
LENGTH	Part No.	\$ / 100	\$ / Ea
20mm	STBM820	147.40	1.77
25mm	STBM825	152.90	1.83
30mm	STBM830	157.30	1.89
40mm	STBM840	162.80	1.95
50mm	STBM850	169.40	2.03





## Sentinel® Countersunk Woodscrews

Clear Zinc Plated

GAUGE		6 GAUGE (3.5mm)			8 GAUGE (4.2mm)			10 GAUGE (4.8mm)		
		Driver: PZ2	Pack: 1000		Driver: PZ2	Pack: 1000		Driver: PZ2	Pack: 1000	
LENGTH		Part No.	\$ / 1000	\$ / 200	Part No.	\$ / 1000	\$ / 200	Part No.	\$ / 1000	\$ / 200
1/2"	13mm				STCW8D	261.79	57.59			
3/4"	19mm	STCW6F	281.78	61.99	STCW8F	344.70	75.83			
1"	25mm	STCW6G	303.75	66.83	STCW8G	400.24	88.05	STCW10G	660.81	145.38
1 1/4"	32mm				STCW8H	460.93	101.40	STCW10H	688.35	151.44
1 1/2"	38mm				STCW8I	525.77	115.67	STCW10I	759.53	167.10
2"	50mm				STCW8J	613.76	135.03	STCW10J	805.11	177.12

GAUGE		12 GAUGE (5.5mm)		
		Driver: PZ3	Pack: 1000	
LENGTH		Part No.	\$ / 1000	\$ / 200
1 1/2"	38mm	STCW12I	902.36	198.52
2"	50mm	STCW12J	1,219.48	268.29
2 1/2"	63mm	STCW12K	1,515.64	333.44
3"	75mm	STCW12L	1,679.44	369.48



## Sentinel® Thread Forming Machine Screw

Galvanised

Also available in  
Resytork Drive  
— see page 8

GAUGE		M8		
		Driver: PZ4	Pack: 100	
		Part No.	\$ / 100	\$ / Ea
20mm		STMM820-G	168.00	2.02
35mm		STMM835-G	188.00	2.26







High Security TORXplus – Restricted Tooling Availability.



Five lobe drive.



Suitable for high torque installation.



Manufactured in 304 (A2 or 18-8) Stainless Steel.



Machine screws available to order, subject to minimum order quantity.



Requires matching tooling – See page 56.



## Torxplus® Countersunk Self Tappers

AB Type Thread | 304 Stainless Steel

GAUGE		6 GAUGE (3.5mm)			8 GAUGE (4.2mm)		
		Driver: 15 IPR	Pack: 100		Driver: 20 IPR	Pack: 100	
		Part No.	\$ / 100	\$ / Ea	Part No.	\$ / 100	\$ / Ea
1/2"	13mm	TPCS6D	131.60	1.58	TPCS8D	134.50	1.61
3/4"	19mm	TPCS6F	148.40	1.78	TPCS8F	142.00	1.70
1"	25mm	TPCS6G	173.20	2.08	TPCS8G	148.80	1.79
1 1/4"	32mm				TPCS8H	179.10	2.15
1 1/2"	38mm	TPCS6I	177.00	2.12	TPCS8I	189.70	2.28



GAUGE		10 GAUGE (4.8mm)			14 GAUGE (6.3mm)		
		Driver: 25 IPR	Pack: 100		Driver: 30 IPR	Pack: 100	
		Part No.	\$ / 100	\$ / Ea	Part No.	\$ / 100	\$ / Ea
1/2"	13mm	TPCS10D	144.10	1.73			
3/4"	19mm	TPCS10F	148.50	1.78	TPCS14F	239.10	2.87
1"	25mm	TPCS10G	167.60	2.01	TPCS14G	277.90	3.33
1 1/4"	32mm	TPCS10H	209.90	2.52	TPCS14H	287.10	3.45
1 1/2"	38mm	TPCS10I	236.40	2.84	TPCS14I	308.70	3.70



## Torxplus® Button Head Self Tappers

AB Type Thread | 304 Stainless Steel

GAUGE		6 GAUGE (3.5mm)			8 GAUGE (4.2mm)		
		Driver: 10 IPR	Pack: 100		Driver: 15 IPR	Pack: 100	
		Part No.	\$ / 100	\$ / Ea	Part No.	\$ / 100	\$ / Ea
1/2"	13mm	TPBS6D	131.60	1.58	TPBS8D	134.50	1.61
3/4"	19mm	TPBS6F	148.40	1.78	TPBS8F	142.00	1.70
1"	25mm	TPBS6G	173.20	2.08	TPBS8G	148.80	1.79
1 1/4"	32mm				TPBS8H	179.10	2.15
1 1/2"	38mm	TPBS6I	177.00	2.12	TPBS8I	189.70	2.28

GAUGE		10 GAUGE (4.8mm)			14 GAUGE (6.3mm)		
		Driver: 25 IPR	Pack: 100		Driver: 27 IPR	Pack: 100	
		Part No.	\$ / 100	\$ / Ea	Part No.	\$ / 100	\$ / Ea
1/2"	13mm	TPBS10D	144.10	1.73	TPBS14D	234.22	2.81
3/4"	19mm	TPBS10F	148.50	1.78	TPBS14F	239.10	2.87
1"	25mm	TPBS10G	167.60	2.01	TPBS14G	277.90	3.33
1 1/4"	32mm	TPBS10H	209.90	2.52	TPBS14H	287.10	3.45
1 1/2"	38mm	TPBS10I	236.40	2.84	TPBS14I	308.70	3.70





Can be re-torqued as necessary.



Ideal for light to medium duty applications in concrete, block and brick.



Zinc Plated Steel.



High Security, Removable Concrete Screw.



Specials made to order.

**TORxplus®**



## Torxplus® Camcrete™ Countersunk Concrete Screws

Zinc Plated

GAUGE LENGTH		10 GAUGE (4.8mm)				
		Driver: 25 IPR	Pack: 100		Drill Sizes mm	
		Part No.	\$ / 100	\$ / Ea	Concrete	Block
1 1/4"	32mm	TPCC10125	401.80	4.82	4.45	4.83
1 3/4"	45mm	TPCC10175	462.36	5.55	4.45	4.83
2 1/4"	58mm	TPCC10225	519.40	6.23	4.45	4.83
2 3/4"	70mm	TPCC10275	588.00	7.06	4.45	4.83
3 1/4"	82mm	TPCC10325	640.63	7.69	4.45	4.83
3 3/4"	95mm	TPCC10375	695.80	8.35	4.45	4.83
4"	100mm	TPCC10400	769.30	9.23	4.45	4.83



GAUGE LENGTH		14 GAUGE (6.3mm)				
		Driver: 27 IPR	Pack: 100		Drill Sizes mm	
		Part No.	\$ / 100	\$ / Ea	Concrete	Block
1 1/4"	32mm	TPCC14125	516.95	6.20	5.6	6.1
1 3/4"	45mm	TPCC14175	569.38	6.83	5.6	6.1
2 1/4"	58mm	TPCC14225	627.20	7.53	5.6	6.1
2 3/4"	70mm	TPCC14275	686.98	8.24	5.6	6.1
3 1/4"	82mm	TPCC14325	754.11	9.05	5.6	6.1
3 3/4"	95mm	TPCC14375	803.60	9.64	5.6	6.1
4"	100mm	TPCC14400	868.28	10.42	5.6	6.1



## Torxplus® Camcrete™ Button Head Concrete Screws

Zinc Plated

GAUGE LENGTH		10 GAUGE (4.8mm)				14 GAUGE (6.3mm)			
		Driver: 25 IPR	Pack: 100		Drill Sizes mm		Driver: 27 IPR	Pack: 100	
		Part No.	\$ / 100	\$ / Ea	Concrete	Block	Part No.	\$ / 100	\$ / Ea
1 1/4"	32mm	TPBC10125	401.80	4.82	4.45	4.83	TPBC14125	516.95	6.20
1 3/4"	45mm	TPBC10175	462.36	5.55	4.45	4.83	TPBC14175	569.38	6.83
2 1/4"	58mm	TPBC10225	519.40	6.23	4.45	4.83	TPBC14225	627.20	7.53
2 3/4"	70mm	TPBC10275	588.00	7.06	4.45	4.83	TPBC14275	686.98	8.24
3 1/4"	82mm	TPBC10325	640.63	7.69	4.45	4.83	TPBC14325	754.11	9.05
3 3/4"	95mm	TPBC10375	695.80	8.35	4.45	4.83	TPBC14375	803.60	9.64
4"	100mm	TPBC10400	769.30	9.23	4.45	4.83	TPBC14400	868.28	10.42



Stocked in zinc plated and galvanized steel.



Special sizes available to order, please contact our sales team for minimum order quantity.



Screws can be painted to order – minimum run 1000 pieces per colour.



Matching tooling required for installation/removal – see page 56. Double ended key wrench also available.



One of the most popular security screws, often used on security screens or doors, and in the sign industry.



Available in 10 Gauge Type 17 – ideal for quick and easy installation into timber.



## Tri-lobular Button Head Type 17 Screws

Zinc Yellow | CL3 Galvanised | 304 Stainless

GAUGE		10 GAUGE (4.8mm)								
		ZINC YELLOW			GALVANISED			304 STAINLESS		
LENGTH		Driver: TL2	Pack: 1000		Driver: TL2	Pack: 1000		Driver: TL2	Pack: 1000	
		Part No.	\$ / 1000	\$ / 100	Part No.	\$ / 1000	\$ / 100	Part No.	\$ / 1000	\$ / 100
3/4"	19mm	TLBT10FZ	103.40	12.41	TLBT10FG	126.50	15.18			
1"	25mm	TLBT10GZ	110.00	13.20	TLBT10GG	137.50	16.50			
1 ¼"	32mm	TLBT10HZ	121.00	14.52	TLBT10HG	150.00	18.00	TLBT10HS	750.00	90.00
1 ½"	38mm	TLBT10IZ	137.50	16.50	TLBT10IG	165.00	19.80	TLBT10IS	900.00	108.00



## Tri-lobular Button Head Self Driller

Zinc Yellow | CL3 Galvanised

GAUGE		10 - 16 GAUGE		
		GALVANISED		
LENGTH		Driver: TL2	Pack: 1000	
		Part No.	\$ / 1000	\$ / 100
5/8"	16mm	TLBSD10EG	120.00	14.40





## Tri-lobular Machine Screw

Zinc Yellow | 304 Stainless

GAUGE	M10					
	ZINC YELLOW			304 STAINLESS		
LENGTH	Driver: TL10	Pack: 100		Driver: TL10	Pack: 100	
	Part No.	\$ / 100	\$ / Ea	Part No.	\$ / 100	\$ / Ea
17mm	TLBM1017Z	60.00	0.72	TLBM1017S	360.00	4.32
20mm	TLBM1020Z	73.00	0.88			
25mm	TLBM1025Z	86.00	1.03	TLBM1025S	440.00	5.28
40mm	TLBM1040Z	134.00	1.61	TLBM1040S	596.00	7.15



TRI-LOBULAR



## Tri-lobular Machine Screw CA Point

Zinc Yellow

GAUGE	M10		
	Driver: TL10	Pack: 100	
LENGTH	Part No.	\$ / 100	\$ / Ea
18mm	TLBM1018CA	66.00	0.79
19mm	TLBM1019CA	75.00	0.90
20mm	TLBM1021CA	75.00	0.90
35mm	TLBM1035CA	170.00	2.04





Suitable for low to medium torque installations.



Requires matching socket for installation/removal – see page 56.



Oval pan head looks like a stud or rivet – leaving potential intruder fooled.



Manufactured from case hardened steel.



## Oval Pan Head Machine Screws

Clear Zinc Plated

GAUGE LENGTH	M4			M5			M6		
	Driver: PHD1	Pack: 100		Driver: PHD2	Pack: 100		Driver: PHD2	Pack: 100	
	Part No.	\$ / 100	\$ / Ea	Part No.	\$ / 100	\$ / Ea	Part No.	\$ / 100	\$ / Ea
10mm	OPHM410	162.75	1.95	OPHM510	184.10	2.21	OPHM610	207.70	2.49
12mm	OPHM412	170.20	2.04	OPHM512	187.70	2.25	OPHM612	214.10	2.57
16mm	OPHM416	176.30	2.12	OPHM516	193.30	2.32	OPHM616	222.60	2.67
20mm	OPHM420	183.30	2.20	OPHM520	198.40	2.38	OPHM620	228.20	2.74
25mm	OPHM425	189.90	2.28	OPHM525	205.00	2.46	OPHM625	233.80	2.81
30mm	OPHM430	195.70	2.35	OPHM530	218.60	2.62	OPHM630	243.40	2.92
40mm	OPHM440	203.20	2.44	OPHM540	224.50	2.69	OPHM640	251.60	3.02







Available in Type 17 for quick and easy installation into timber.



Requires matching tooling – see page 56.



High security option for security screen manufacturers and sign installers.



Positive drive – offers all the benefits of the popular square drive system.



Stocked in galvanized steel.



Unique to Prolok – restricted tooling availability.



## Quadtech™ Button Head Type 17 Screws

CL3 Galvanised

GAUGE		10 GAUGE (4.8mm)		
LENGTH		Driver: SD2	Pack: 100	
		Part No.	\$ / 100	\$ / Ea
3/4"	19mm	QTBS10F-G	115.00	13.80
1"	25mm	QTBS10G-G	142.50	17.10
1 1/2"	38mm	QTBS10I-G	161.00	19.32



## Quadtech™ Button Head Self Drillers

CL3 Galvanised

GAUGE		10 GAUGE (4.8mm)		
LENGTH		Driver: SD2	Pack: 100	
		Part No.	\$ / 100	\$ / Ea
5/8"	16mm	QTPSD10E-G	138.00	16.56

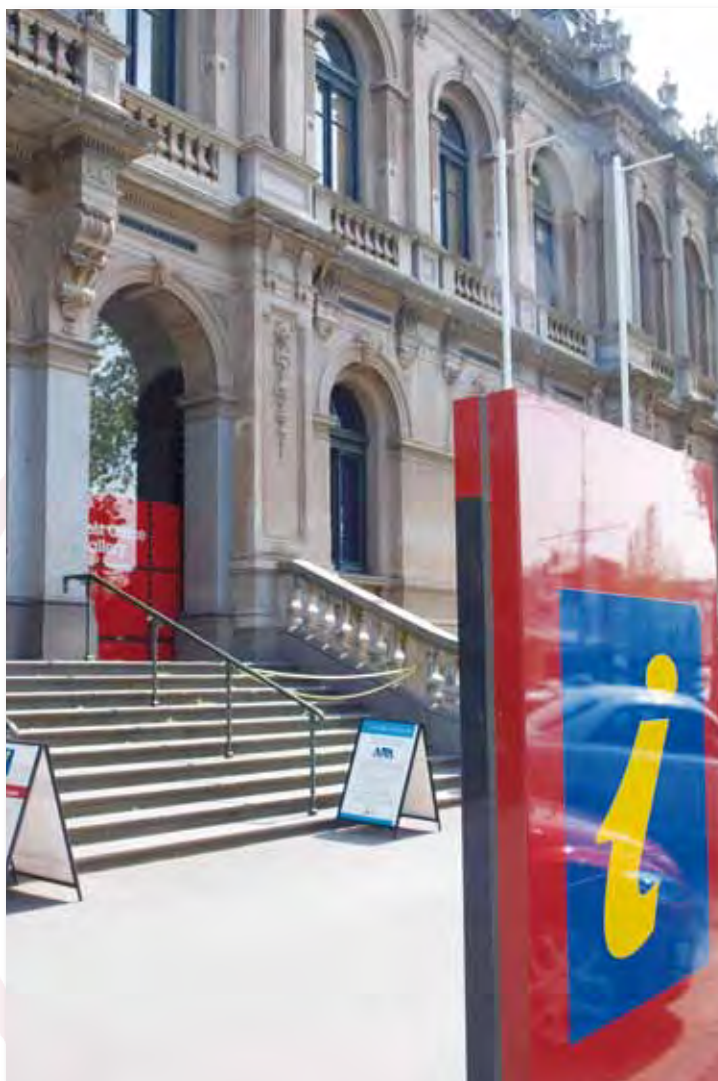





**Unique to PROLOK – High security screw with restricted tooling availability. All End users required to complete a registration form, please contact our sales team to obtain a copy.**

Complete range available from 8G to 14G in galvanized steel.

Very positive recess makes this drive ideal for fast and accurate self drilling into steel.

Ideal for:

- Security Fencing
- Playgrounds
- Cladding
- Prisons
- Roofing
- Street Furniture

Stocked plain, can be painted and fitted with washers, subject to minimum order quantities.

Requires matching tooling – see page 56.



**PENTAFORCE™**



## Pentaforce™ Pan Head Self Drilling Screws

Galvanised

GAUGE		8-18 GAUGE (4.2mm)			10-16 GAUGE (4.8mm)		
		Driver: PFD1-B	Pack: 1000		Driver: PFD1-B	Pack: 1000	
LENGTH		Part No.	\$ / 1000	\$ /100	Part No.	\$ / 1000	\$ /100
1/2"	12mm	PFPSD8D	110.00	13.20			
5/8"	16mm				PFPSD10E	180.00	21.60
3/4"	19mm	PFPSD8F	125.00	15.00			
1"	25mm				PFPSD10G	220.00	26.40
1 1/2"	40mm				PFPSD10I	275.00	33.00

GAUGE		12-14 GAUGE (5.5mm)			14-10 GAUGE (6.3mm)		
		Driver: PFD2-B	Pack: 1000		Driver: PFD2-B	Pack: 1000	
LENGTH		Part No.	\$ / 1000	\$ /100	Part No.	\$ / 1000	\$ /100
1"	25mm	PFPSD12G	260.00	31.20	PFPSD14G	350.00	42.00
1 1/2"	40mm	PFPSD12I	318.00	38.16			
2"	50mm	PFPSD12J	395.00	47.40	PFPSD14J	540.00	64.80
2 1/2"	63mm	PFPSD12K	415.00	49.80	PFPSD14K	620.00	74.40



## Pentaforce™ Pan Head Type 17 Screws

Galvanised

GAUGE		10-12 GAUGE		
		Driver: PFD1-B	Pack: 1000	
LENGTH		Part No.	\$ / 1000	\$ /100
3/4"	19mm	PFPT10F	158.00	18.96
1"	25mm	PFPT10G	170.00	20.40
1 1/2"	40mm	PFPT10I	208.00	24.96

GAUGE		12-14 GAUGE		
		Driver: PDF1-B	Pack: 1000	
LENGTH		Part No.	\$ / 1000	\$ /100
1 1/4"	32mm	PFPT12H	320.00	38.40
1 1/2"	38mm	PFPT12I	297.00	35.64
2"	50mm	PFPT12J	395.00	47.40



Can be fitted with washers



## Pentaforce™ Countersunk Self Tappers

304 Stainless Steel

GAUGE LENGTH		6 GAUGE (3.5mm)			8 GAUGE (4.2mm)		
		Driver: PFD0-B	Pack: 100		Driver: PFD0-B	Pack: 100	
		Part No.	\$ / 100	\$ / Ea	Part No.	\$ / 100	\$ / Ea
3/4"	19mm	PFCS6F	POA	POA	PFCS8F	POA	POA
1"	25mm				PFCS8G	POA	POA
2"	50mm						

GAUGE LENGTH		10 GAUGE (4.8mm)			12 GAUGE (5.5mm)		
		Driver: PFD1-B	Pack: 100		Driver: PFD2-B	Pack: 100	
		Part No.	\$ / 100	\$ / Ea	Part No.	\$ / 100	\$ / Ea
1"	25mm				PFCS12G	POA	POA
2"	50mm	PFCS10J	POA	POA			



PENTAFORCE™



## Pentaforce™ Button Head Self Tappers

304 Stainless Steel

GAUGE LENGTH		6 GAUGE (3.5mm)			8 GAUGE (4.2mm)		
		Driver: PFD0-B	Pack: 100		Driver: PFD0-B	Pack: 100	
		Part No.	\$ / 100	\$ / Ea	Part No.	\$ / 100	\$ / Ea
3/8"	9.5mm				PFBS8C	POA	POA
1/2"	13mm	PFBS6D	POA	POA	PFBS8D	POA	POA
3/4"	19mm				PFBS8F	POA	POA
1"	25mm	PFBS6G	POA	POA	PFBS8G	POA	POA
1 1/4"	32mm				PFBS8H	POA	POA
1 1/2"	40mm	PFBS6I	POA	POA	PFBS8I	POA	POA

GAUGE LENGTH		10 GAUGE (4.8mm)			12 GAUGE (5.5mm)		
		Driver: PFD1-B	Pack: 100		Driver: PFD2-B	Pack: 100	
		Part No.	\$ / 100	\$ / Ea	Part No.	\$ / 100	\$ / Ea
3/4"	19mm	PFBS10F	POA	POA			
1"	25mm	PFBS10G	POA	POA	PFBS12G	POA	POA
1 1/4"	32mm	PFBS10H	POA	POA	PFBS12H	POA	POA
1 1/2"	40mm				PFBS12I	POA	POA



Other sizes available to order – minimum order quantities apply.



High Security Machine screw.



Very positive recess reduces wobble and makes this drive type very user friendly.



Ideal for high security areas where driver tool availability is of concern.



Other sizes available.



Requires matching tooling – see page 56.



Unique to PROLOK - restricted tooling availability. All End users required to complete a registration form, please contact our sales team to obtain a copy.



## Pentaforce™ Countersunk Machine Screws

304 Stainless Steel

GAUGE	M3			M4		
	Driver: PFD0-B	Pack: 100		Driver: PFD0-B	Pack: 100	
LENGTH	Part No.	\$ / 100	\$ / Ea	Part No.	\$ / 100	\$ / Ea
12mm	PFCM312	POA	POA	PFCM412	POA	POA

GAUGE	M5			M6		
	Driver: PFD1-B	Pack: 100		Driver: PFD2-B	Pack: 100	
LENGTH	Part No.	\$ / 100	\$ / Ea	Part No.	\$ / 100	\$ / Ea
12mm	PFCM512	POA	POA			
20mm	PFCM520	POA	POA	PFCM620	POA	POA
30mm				PFCM630	POA	POA

Other sizes available to order –  
minimum order quantities apply



## Pentaforce™ Button Head Machine Screws

304 Stainless Steel

GAUGE	M3			M4		
	Driver: PFD0-B	Pack: 100		Driver: PFD0-B	Pack: 100	
LENGTH	Part No.	\$ / 100	\$ / Ea	Part No.	\$ / 100	\$ / Ea
8mm	PFBM308	POA	POA	PFBM408	POA	POA
10mm				PFBM410	POA	POA
12mm				PFBM412	POA	POA
16mm				PFBM416	POA	POA
30mm				PFBM430	POA	POA

GAUGE	M5			M6			M8		
	Driver: PFD1-B	Pack: 100		Driver: PFD02-B	Pack: 100		Driver: PFD3-B	Pack: 100	
LENGTH	Part No.	\$ / 100	\$ / Ea	Part No.	\$ / 100	\$ / Ea	Part No.	\$ / 100	\$ / Ea
10mm	PFBM510	POA	POA						
12mm	PFBM512	POA	POA	PFBM612	POA	POA			
16mm	PFBM516	POA	POA	PFBM616	POA	POA	PFBM816	POA	POA
20mm	PFBM520	POA	POA	PFBM620	POA	POA	PFBM820	POA	POA
25mm	PFBM525	POA	POA	PFBM625	POA	POA	PFBM825	POA	POA
40mm				PFBM640	POA	POA			
50mm				PFBM650	POA	POA			





Unique to PROLOK - restricted tooling availability. All End users required to complete a registration form, please contact our sales team to obtain a copy.



Ultimate security screw. Manufactured to order with unique drive shape.



This system enables each customer to have their own security drive with tooling manufactured solely for them.



Used in the prison industry.



Millions of Uni-Set™ shapes available ensures your drive is unique, therefore enhancing the level of security to a new plane.



Manufactured to order in steel or stainless steel.

UNI-SET™



## Uni-Set AB Type Self Tappers

Unique Drive Type. Manufactured to order, subject to minimum order quantities



**Countersunk and Button Head self tapping screws from No.4 to No.14 Gauge, from 3/8" to 4" long.**



## Uni-Set Metric Machine Screws

Unique Drive Type. Manufactured to order, subject to minimum order quantities



**Countersunk and Button Head metric machine screws from M2 up to M16 diameter, from 4mm to 100mm long.**



## UNI-SET™

*How to specify*

**US**

DRIVE RECESS  
US= Uni Set

**B**

HEAD TYPE  
B= Button Head  
C= Countersunk

**M**

THREAD TYPE  
M= Machine Screw  
S= Self Tapper

**10**

DIAMETER

**20**

LENGTH



Superior alternative to shear nut, having the advantages of not being governed by the shear point and not leaving unplated surfaces.



Manufactured in zinc plated steel, galvanized steel and stainless steel.



Unique, high torque security nut (patented product).



Can be re-torqued if required.



Requires matching socket for installation, see page 56.



## Kinmar® Permanent Nuts

304 Stainless Steel | Galvanised | Zinc

GAUGE \ MATERIAL	M5			M6			M8		
	Driver: KM5P	Pack: 100		Driver: KM6P	Pack: 100		Driver: KM8P	Pack: 100	
	Part No.	\$ / 100	\$ / Ea	Part No.	\$ / 100	\$ / Ea	Part No.	\$ / 100	\$ / Ea
Zinc Plated	KM5N-Z	238.00	2.86	KM6N-Z	238.00	2.86	KM8N-Z	250.30	3.00
Galvanised				KM6N-G	246.00	2.95	KM8N-G	275.40	3.30
A2 Stainless	KM5N-S	335.00	4.02	KM6N-S	336.00	4.03	KM8N-S	389.90	4.68

GAUGE \ MATERIAL	M10			M12		
	Driver: KM10P	Pack: 100		Driver: KM12P	Pack: 100	
	Part No.	\$ / 100	\$ / Ea	Part No.	\$ / 100	\$ / Ea
Zinc Plated	KM10N-Z	333.80	4.01	KM12N-Z	362.90	4.35
Galvanised	KM10N-G	365.70	4.39	KM12N-G	399.20	4.79
A2 Stainless	KM10N-S	538.00	6.46	KM12N-S	846.00	10.15

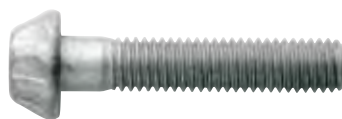

## Kinmar® Permanent Bolts

Galvanised

GAUGE \ MATERIAL	M8		
	Driver: KM8P	Pack: 100	
	Part No.	\$ / 100	\$ / Ea
40mm	KMPM840	600.00	7.20

Other sizes / finishes available to order only – minimum order quantities apply

## Kinmar® Permanent Dimensions (mm)

GAUGE \ DIMENSIONS	M5	M6	M8	M10	M12
	A	A	A	A	A
A	12.1	12.1	16.1	20.1	24.2
B	5.6	5.6	7.3	9.1	10.5

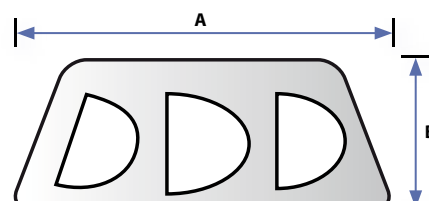



Unique, high torque security nut with the added benefit of being removable with the matching socket (patented product).



Probably the most cost effective removable security nut on the market.



Manufactured in zinc plated steel, galvanized steel and stainless steel.



Required matching socket for installation/removal, see page 56.



KINMAR®



## Kinmar® Removable Nuts

304 Stainless Steel | Galvanised | Zinc



GAUGE	M5			M6			M8		
	Driver: KM6R	Pack: 100		Driver: KM6R	Pack: 100		Driver: KM8R	Pack: 100	
MATERIAL	Part No.	\$ / 100	\$ / Ea	Part No.	\$ / 100	\$ / Ea	Part No.	\$ / 100	\$ / Ea
Zinc Plated	KM5R-Z	194.00	2.33	KM6R-Z	194.00	2.33	KM8R-Z	220.00	2.64
Galvanised				KM6R-G	230.00	2.76	KM8R-G	250.00	3.00
A2 Stainless	KM5R-S	320.00	3.84	KM6R-S	320.00	3.84	KM8R-S	355.00	4.26

GAUGE	M10			M12		
	Driver: KM10R	Pack: 100		Driver: KM12R	Pack: 100	
MATERIAL	Part No.	\$ / 100	\$ / Ea	Part No.	\$ / 100	\$ / Ea
Zinc Plated	KM10R-Z	312.00	3.74	KM12R-Z	364.00	4.37
Galvanised	KM10R-G	370.00	4.44	KM12R-G	405.00	4.86
A2 Stainless	KM10R-S	520.00	6.24	KM12R-S	848.00	10.18



## Kinmar® Removable Bolts

Galvanised

TO ORDER ONLY – Minimum order quantities apply



## Kinmar® Removable Dimensions (mm)

GAUGE	M5	M6	M8	M10	M12
DIMENSIONS					
A	12.1	12.1	16.1	20.1	24.2
B	5.6	5.6	7.3	9.1	10.5

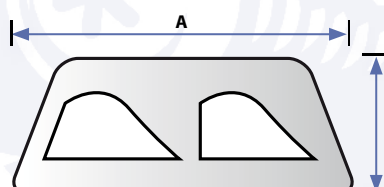





High security, permanent nut.

No specialist tools required – installed with a standard socket or spanner.

Manufactured in zinc plated steel, galvanized steel and stainless steel.



Before



After



Hexagonal part shears off when nut is tightened leaving a tamper resistant cone.



## Shear Nuts

304 Stainless Steel | Galvanised | Zinc Plated

GAUGE	M6						M8					
		Pack: 100		Shear Torque		A/F (mm)		Pack: 100		Shear Torque		A/F (mm)
MATERIAL	Part No.	\$ / 100	\$ / Ea	lb/ft	nm		Part No.	\$ / 100	\$ / Ea	lb/ft	nm	
Zinc Plated	SHN6-Z	146.00	1.75	5-9	7-14	14	SHN8-Z	153.00	1.84	10-15	14-20	16
Galvanised							SHN8-G	160.00	1.92	10-15	14-20	16
A2 Stainless	SHN6-S	268.00	3.22	5-9	7-14	10	SHN8-S	308.00	3.70	10-15	14-20	13

GAUGE	M10						M12					
		Pack: 100		Shear Torque		A/F (mm)		Pack: 100		Shear Torque		A/F (mm)
MATERIAL	Part No.	\$ / 100	\$ / Ea	lb/ft	nm		Part No.	\$ / 100	\$ / Ea	lb/ft	nm	
Zinc Plated	SHN10-Z	202.00	2.42	23-28	31-38	19	SHN12-Z	292.00	3.50	38-44	52-60	22
Galvanised	SHN10-G	312.00	3.74	23-28	31-38	19	SHN12-G	418.00	5.02	38-44	52-60	22
A2 Stainless	SHN10-S	462.00	5.54	23-28	31-38	17	SHN12-S	550.00	6.60	38-44	52-60	19

GAUGE	M16						M20					
		Pack: 100		Shear Torque		A/F (mm)		Pack: 100		Shear Torque		A/F (mm)
MATERIAL	Part No.	\$ / 100	\$ / Ea	lb/ft	nm		Part No.	\$ / 100	\$ / Ea	lb/ft	nm	
Zinc Plated	SHN16-Z	729.00	8.75	54-60	74-82	27	SHN20-Z	2,016.00	24.19	72-82	100-113	32
Galvanised	SHN16-G	690.00	8.28	54-60	74-82	27	SHN20-G	2,120.00	25.44	72-82	100-113	32
A2 Stainless	SHN16-S	1,050.00	12.60	54-60	74-82	24	SHN20-S	3,880.00	46.56	72-82	100-113	30

### SHEAR BOLTS MADE TO ORDER ONLY –

For further details please phone us with material and quantity required.

Button Head Shear Bolt



Countersunk Shear Bolt



Saddle Bolt





Unique Security Nut



Low head, ideal for public spaces



Smooth and finished appearance, ideal for high profile locations



Custom socket configurations available for ultimate security



**STELLAR™**



## Stellar™ Barrel Nut (Special Purpose)

316 Stainless Steel

GAUGE	M12		
	Driver: SRS12SP	Pack: 100	
LENGTH	Part No.	\$ / 100	\$ / Ea
22mm	SRBN1222SP	1,698.00	21.00

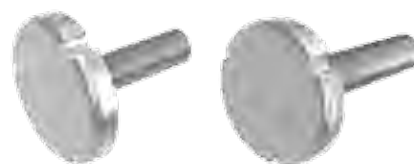

**Stellar™ Bolts made to order.**



## Stellar™ Barrel Nut with Through Hole

304 Stainless Steel

GAUGE	M12		
	Driver: SRS12-1	Pack: 100	
LENGTH	Part No.	\$ / 100	\$ / Ea
22mm	SRBN1222TH	1,350.00	16.80



### STELLAR™ BARREL NUT DIMENSIONS

Description	Material	A	B	C	D
M12 Barrel Nut	304 S/S	30	22	18	5
Drive Socket	304 S/S	38	3/8"	40	15

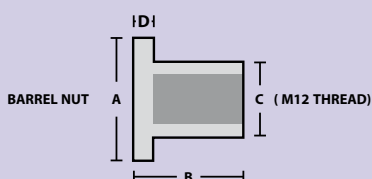
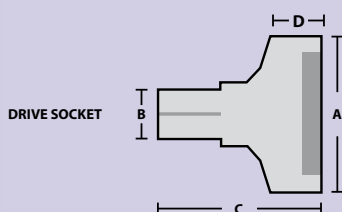



This security fastener has the advantage of not being governed by torque as it can be applied to any standard or hi-tensile hex fasteners.



Leaves a smooth cover over the sharp edges of a hexagon.



Simple conical collar which can be hammered over any standard hexagon bolt head or nut to render tamper proof.



Can be applied to existing fasteners.



No specialist tools required – applied with a hammer.



Manufactured in zinc plated steel, stainless steel and galvanised to order.



## Armour Ring™

304 Stainless Steel | Zinc Plated

GAUGE	M6			M8			M10		
		Pack: 100			Pack: 100			Pack: 100	
MATERIAL	Part No.	\$ / 100	\$ / Ea	Part No.	\$ / 100	\$ / Ea	Part No.	\$ / 100	\$ / Ea
Zinc Plated	AR6-Z	172.60	2.07	AR8-Z	218.40	2.62	AR10-Z	305.80	3.67
A2 Stainless	AR6-S	514.90	6.18	AR8-S	644.30	7.73	AR10-S	1,306.10	15.67

GAUGE	M12			M16			M20		
		Pack: 100			Pack: 100			Pack: 100	
MATERIAL	Part No.	\$ / 100	\$ / Ea	Part No.	\$ / 100	\$ / Ea	Part No.	\$ / 100	\$ / Ea
Zinc Plated	AR12-Z	600.80	7.21	AR16-Z	1,201.20	14.41			
A2 Stainless	AR12-S	1,632.60	19.59	AR16-S	7,207.20	86.49	AR20-S	POA	POA

## Armour Ring™ Dimensions (mm)

GAUGE	M6	M8	M10	M12	M16	M20
DIMENSIONS						
A	15.8	20	26.6	33	41.2	51
B	6.8	7.7	9.8	12.3	16	19
C	7.2	10.5	11.5	14	17.3	19
D	11	15	20	25	30	38

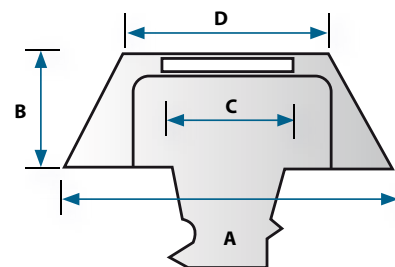

Collar is tapped into place with conventional tools

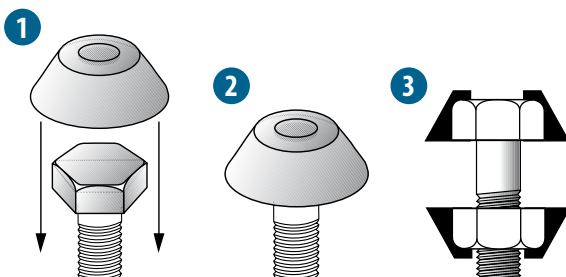

Special installation tools available.





Specially modified Armour Ring™ to suit Hex washer face heads commonly used on Self drilling and Type 17 screws.



Ultimate security - no tool for removal.



Available in Zinc, Galvanised and Stainless steel to suit a variety of environments.



Can be painted to match roof sheet colours.



Installed using a standard hammer, installation tools available to order.



## Armour Ring™ to suit #12 Hex Washer Face Screw

304 Stainless Steel | Galvanised



ARMOUR RINGS™



GAUGE	M5.5		
	Driver: AST5.5	Pack: 100	
MATERIAL	Part No.	\$ / 100	\$ / Ea
Galvanised	AR5.5-M-G	POA	POA
A2 Stainless	AR5.5-M-A2	POA	POA

## Armour Ring™ to suit #14 Hex Washer Face Screw

304 Stainless Steel | Galvanised

GAUGE	M6		
	Driver: AST6	Pack: 100	
MATERIAL	Part No.	\$ / 100	\$ / Ea
Galvanised	AR6-M-G	POA	POA
A2 Stainless	AR6-M-A2	POA	POA

Collar is tapped into place with conventional tools

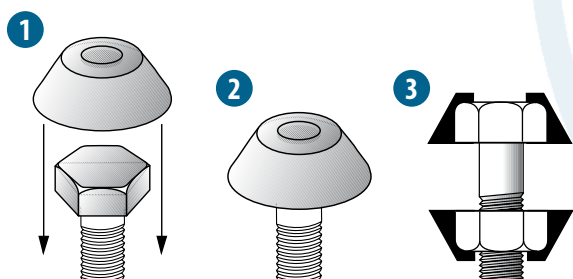



Useful threaded insert often used in playground industry.



No drive – offers complete security.



## Slab Tee Nut

304 Stainless Steel

GAUGE	3/8 UNC			M10		
		Pack: 100			Pack: 100	
LENGTH	Part No.	\$ / 100	\$ / Ea	Part No.	\$ / 100	\$ / Ea
Stainless	STBTN3/8	180.00	2.16	STBTN10	150.00	1.80

## Slab Tee Nut Dimensions (mm)

DIMENSIONS	A	B	C
GAUGE			
3/8 UNC	25.5	18.5	9
M10	26	18	9

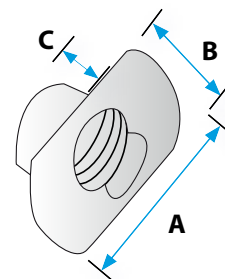

Cone shape resists attack.



Good driving torque.



Available in imperial thread sizes.



## Trident Nut

Zinc Alloy

GAUGE	10 - 24 UNC			10 - 32 UNC		
	Driver: TDS20	Pack: 100		Driver: TDS20	Pack: 100	
LENGTH	Part No.	\$ / 100	\$ / Ea	Part No.	\$ / 100	\$ / Ea
Steel Zinc	TDN1024	225.00	2.70	TDN1032	225.00	2.70
Trident Driver	TDS20		120.00	TDS20		120.00

GAUGE	1/4 - 20 UNC			5/16 - 18 UNC		
	Driver: TDS20	Pack: 100		Driver: TDS30	Pack: 100	
LENGTH	Part No.	\$ / 100	\$ / Ea	Part No.	\$ / 100	\$ / Ea
Steel Zinc	TDNA20	265.00	3.18	TDNB18	375.00	4.50
Trident Driver	TDS20		120.00	TDS30		140.00

GAUGE	3/8 - 16 UNC			1/2 - 13 UNC		
	Driver: TDS30	Pack: 100		Driver: TDS40	Pack: 100	
LENGTH	Part No.	\$ / 100	\$ / Ea	Part No.	\$ / 100	\$ / Ea
Steel Zinc	TDNC16	440.00	5.28	TDND13	575.00	6.90
Trident Driver	TDS30		140.00	TDS40		400.00



Manufactured in case hardened Bright Zinc Plated (CR-3) Steel. RoHS Compliant.



Highest security enclosure for any standard nut or bolt.



Permanent, non removable fastener.



Two part enclosure made from case hardened steel which repels attack, including drills and saws.



Available as Type 1 for bolts and Type 2 for nuts which may have threads standing higher than the base cap.



No specialist tools required – applied with a hammer.

**NOGO™**



## No-Go™ Type 1

Bright Zinc Plated (CR3)



## No-Go™ Type 2

Bright Zinc Plated (CR3)

GAUGE	M5			M6			M8		
		Pack: 10 - pair			Pack: 10 - pair			Pack: 10 - pair	
TYPE	Part No.	\$ / 10	\$ / Ea	Part No.	\$ / 10	\$ / Ea	Part No.	\$ / 10	\$ / Ea
Type 1 - Plain	NG5PR	108.88	13.07	NG6PR	113.75	13.65	NG8PR	165.75	19.89
Type 2 - Hole	NG5PR-H	108.88	13.07	NG6PR-H	113.75	13.65	NG8PR-H	165.75	19.89



GAUGE	M10			M12		
		Pack: 10 - pair			Pack: 10 - pair	
TYPE	Part No.	\$ / 10	\$ / Ea	Part No.	\$ / 10	\$ / Ea
Type 1 - Plain	NG10PR	251.88	30.23	NG12PR	360.75	43.29
Type 2 - Hole	NG10PR-H	251.88	30.23	NG12PR-H	360.75	43.29

## Nogo™ Security Enclosure Dimensions (mm)

LENGTH GAUGE	DIMENSIONS IN MM					ANGLE
	A	B	C	D	E	
M5	12	20	5.4	18	12.9	4.5°
M6	13	22	6.4	20	15	5°
M8	14	28.4	8.4	26	19.9	6°
M10	18	32	10.4	30	25.3	6°
M12	20	36	12.4	32	26.4	6°

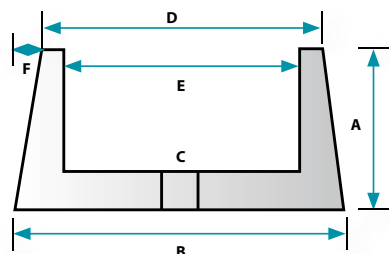

A. Fix base cap under fastener.

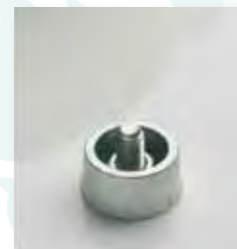

B. Hammer home cap for the most secure fastening.

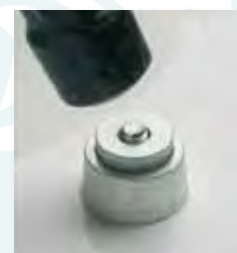
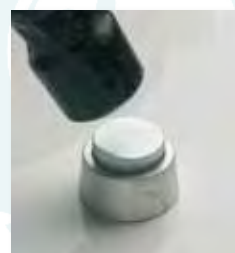





Due to its rounded design, this nut is almost impossible to remove without the matching socket.



Suitable for medium to high torque applications.



Requires matching socket, see page 57.



Unique high security nut (patented product).



Can be removed with matching socket.



Manufactured in 304 (A2 or 18-8) stainless steel. Available in other materials by special order.



## Scroll Nuts™

304 Stainless



GAUGE	M3			M4			M5		
	Driver: SC3	Pack: 100		Driver: SC4	Pack: 100		Driver: SC5	Pack: 100	
MATERIAL	Part No.	\$ / 100	\$ / Ea	Part No.	\$ / 100	\$ / Ea	Part No.	\$ / 100	\$ / Ea
A2 Stainless	SCN3	1,382.00	16.58	SCN4	1,420.00	17.04	SCN5	1,450.00	17.40

GAUGE	M6			M8			M10		
	Driver: SC6	Pack: 100		Driver: SC8	Pack: 100		Driver: SC10	Pack: 100	
MATERIAL	Part No.	\$ / 100	\$ / Ea	Part No.	\$ / 100	\$ / Ea	Part No.	\$ / 100	\$ / Ea
A2 Stainless	SCN6	1,650.00	19.80	SCN8	1,695.00	20.34	SCN10	1,750.00	21.00

GAUGE	M12			M16			M20		
	Driver: SC12	Pack: 100		Driver: SC16	Pack: 100		Driver: SC20	Pack: 100	
MATERIAL	Part No.	\$ / 100	\$ / Ea	Part No.	\$ / 100	\$ / Ea	Part No.	\$ / 100	\$ / Ea
A2 Stainless	SCN12	1,960.00	23.52	SCN16	3,575.00	42.90	SCN20	4,555.00	54.66

GAUGE	M24		
	Driver: SC24	Pack: 100	
MATERIAL	Part No.	\$ / 100	\$ / Ea
A2 Stainless	SCN24	5,525.00	66.30

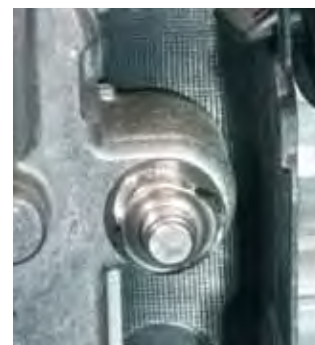
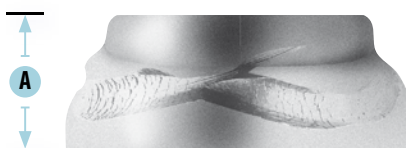

## Scroll Nut™ Dimensions (mm)

THREADED SIZE		M3	M4	M5	M6	M8	M10	M12	M16	M20	M24
Scroll Nut Dimensions (mm)	A	3.4	3.4	4.3	4.8	6	7.5	9	12	12.8	14.3
	B	7.9	7.9	9.5	12.5	16	19	22	25	35	38



Four small holes recessed into a narrow groove make this nut almost impossible to remove without matching driver socket.



Requires matching socket, see page 57.



Manufactured in 304 (A2 or 18-8) stainless steel. Available in other materials by special order.



High security removable security nut, suitable for low torque applications.



Aesthetically pleasing design, often specified purely for its good looks, particularly on glass panels and stainless steel architecture.



## 4-HOLE NUTS



### 4-Hole Nut

304 Stainless

GAUGE	M6			M8			M10		
	Driver: FH1	Pack: 100		Driver: FH1	Pack: 100		Driver: FH1	Pack: 100	
MATERIAL	Part No.	\$ / 100	\$ / Ea	Part No.	\$ / 100	\$ / Ea	Part No.	\$ / 100	\$ / Ea
304 Stainless	FHN6	1,912.00	22.94	FHN8	2011.00	24.13	FHN10	2110.00	25.32

GAUGE	M12			M16			M20		
	Driver: FH2	Pack: 100		Driver: FH3	Pack: 100		Driver: FH3	Pack: 100	
MATERIAL	Part No.	\$ / 100	\$ / Ea	Part No.	\$ / 100	\$ / Ea	Part No.	\$ / 100	\$ / Ea
304 Stainless	FHN12	2209.00	26.51	FHN16	4,975.00	59.70	FHN20	5,056.00	60.67

### 4-Hole Nut Dimensions (mm)

THREADED SIZE		M6	M8	M10	M12	M16	M20
4-Hole Dimensions (mm)	A	6	6	6	6	10	10
	B	19	19	19	25	38	38

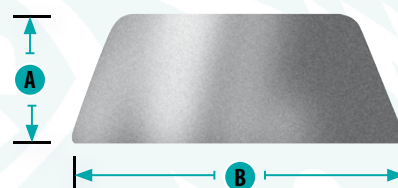

### 4-Hole Security Bolts

Available to order. For further details please phone us with materials and quantities required.





Easy to install security nut. No specialist tools required for installation.

Can be removed – see installation instructions below.



Manufactured in hardened steel.



Imperial sizes also available.



## Pyranut

Zinc Yellow

GAUGE	M6			M8		
		Pack: 100			Pack: 100	
MATERIAL	Part No.	\$ / 100	\$ / Ea	Part No.	\$ / 100	\$ / Ea
Zinc Yellow	PYNM6	375.00	4.50	PYNM8	375.00	4.50

GAUGE	M10			M12		
		Pack: 100			Pack: 100	
MATERIAL	Part No.	\$ / 100	\$ / Ea	Part No.	\$ / 100	\$ / Ea
Zinc Yellow	PYNM10	375.00	4.50	PYNM12	625.00	7.50



## Pyranut Dimensions (mm)

GAUGE	M6	M8	M10	M12
DIMENSIONS				
A	26.67	26.67	26.67	31.75
B	32.50	32.50	32.50	34.80
C	5.84	5.84	5.84	7.62

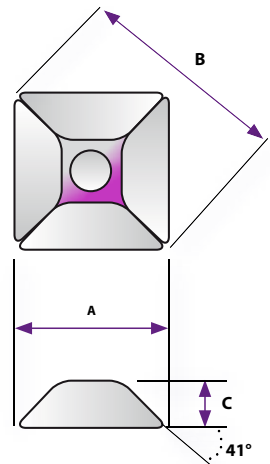

## Installation Instructions



Using standard carriage bolt, install Pyranut #1 finger tight.

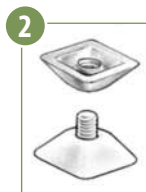

Pyranut #2 is installed as shown, so it's a half turn away from #1.



Pyranut #1 is tightened or loosened by inserting an open-ended or adjustable wrench between the two nuts, then turning both nuts.



When tight remove Pyranut #2 leaving your property secured.





Fast and easy installation.



Flush head leaves no threads protruding which could pose a hazard to inmates or passer bys.



Available in both button head and countersunk.



Available in zinc plated and galvanized steel to order.



Requires matching tooling, see page 55.



## Resytork Button Head Removable Sleeve Anchors

304 Stainless



GAUGE	M8			M10			M12		
	Driver: T30	Pack: 100		Driver: T40	Pack: 100		Driver: T45	Pack: 100	
LENGTH	Part No.	\$ / 100	\$ / Ea	Part No.	\$ / 100	\$ / Ea	Part No.	\$ / 100	\$ / Ea
45mm	RTBSA845	854.00	10.25						
55mm				RTBSA1055	1,112.00	13.34			
65mm							RTBSA1265	1,614.00	19.37
75mm				RTBSA1075	1,568.00	18.82			
80mm							RTBSA1280	2,006.00	24.07



## Resytork Countersunk Removable Sleeve Anchors

304 Stainless

GAUGE	M8			M10			M12		
	Driver: T30	Pack: 100		Driver: T40	Pack: 100		Driver: T45	Pack: 100	
LENGTH	Part No.	\$ / 100	\$ / Ea	Part No.	\$ / 100	\$ / Ea	Part No.	\$ / 100	\$ / Ea
50mm	RTCSA850	870.00	10.44						
55mm				RTCSA1055	1,042.00	12.50			
60mm							RTCSA1260	1,646.00	19.75
80mm				RTCSA1080	1,600.00	19.20	RTCSA1280	2,048.00	24.58

### Button Head Dimensions (mm)

SIZE	BUTTONHEAD (mm)		
	Drill Hole Diameter	Maximum Fixture Thickness	Minimum Hole Depth*
M8 x 45	8	10	37
M10 x 55	10	10	45
M10 x 75	10	25	45
M12 x 65	12	10	52
M12 x 80	12	25	52

### Countersunk Dimensions (mm)

SIZE	COUNTERSUNK (mm)		
	Drill Hole Diameter	Maximum Fixture Thickness	Minimum Hole Depth*
M8 x 50	8	10	37
M10 x 55	10	10	45
M10 x 80	10	25	45
M12 x 60	12	10	52
M12 x 80	12	25	52

\*Minimum hole depth quoted is for maximum fixture thickness. For thinner fixtures increase the hole depth accordingly.





Unique Kinmar® drive offers accurate, torque controlled fixing, which can be re-torqued if necessary.



Requires matching sockets, see page 56.



Fast and easy installation into a wide variety of base materials.



Available in both permanent and removable versions.



Available in zinc plated steel, galvanized and stainless steel.



## Kinmar® Sleeve Anchors Permanent

304 Stainless | Zinc | Galvanised

GAUGE	M8 Drill Hole Diameter: 8mm					
	CLEAR ZINC PLATED			Maximum Fixture Thickness	Minimum Hole Depth*	
	Driver: KM6P	Pack: 100				
	Part No.	\$ / 100	\$ / Ea			
LENGTH	40mm	KMSZ0840	423.50	5.08	5	35
65mm	KMSZ0865	445.50	5.35	30	35	
85mm	KMSZ0885	478.50	5.74	50	35	



GAUGE   
---

GAUGE	M12 Drill Hole Diameter: 12mm							
	CLEAR ZINC PLATED			GALVANISED			Maximum Fixture Thickness	Minimum Hole Depth*
	Driver: KM10P	Pack: 100		Driver: KM10P	Pack: 100			
LENGTH	Part No.	\$ / 100	\$ / Ea	Part No.	\$ / 100	\$ / Ea		
60mm	KMSZ1260	561.00	6.73	KMSG1260	1,078.00	12.94	10	50
75mm	KMSZ1275	583.00	7.00	KMSG1275	1,193.50	14.32	25	50
100mm	KMSZ12100	643.50	7.72	KMSG12100	1,271.05	15.25	50	50
130mm	KMSZ12130	698.50	8.38	KMSG12130	1,353.00	16.24	80	50

GAUGE	M16 Drill Hole Diameter: 16mm				
	CLEAR ZINC PLATED			Maximum Fixture Thickness	Minimum Hole Depth*
	Driver: KM12P	Pack: 100			
LENGTH	Part No.	\$ / 100	\$ / Ea		
65mm	KMSZ1665	742.50	8.91	10	55
100mm	KMSZ16100	852.50	10.23	45	55





## Kinmar® Sleeve Anchors Removable

304 Stainless | Zinc | Galvanised



GAUGE	M8 Drill Hole Diameter: 8mm											
	CLEAR ZINC PLATED			GALVANISED			304 STAINLESS			Maximum Fixture Thickness	Minimum Hole Depth*	
	Driver: KM6R	Pack: 100		Driver: KM6R	Pack: 100		Driver: KM6R	Pack: 100				
	Part No.	\$ / 100	\$ / Ea	Part No.	\$ / 100	\$ / Ea	Part No.	\$ / 100	\$ / Ea			
LENGTH	40mm	KMRSZ840	423.50	5.08	KMRSG840	660.00	7.92	KMRSS840	885.50	10.63	5	35
65mm	KMRSZ865	445.50	5.35	KMRSG865	706.09	8.47	KMRSS865	1,127.50	13.53	30	35	
85mm	KMRSZ885	478.50	5.74	KMRSG885	787.16	9.45				50	35	

GAUGE	M10    Drill Hole Diameter: 10mm											
	CLEAR ZINC PLATED			GALVANISED			304 STAINLESS			Maximum Fixture Thickness	Minimum Hole Depth*	
	Driver: KM8R	Pack: 100		Driver: KM8R	Pack: 100		Driver: KM8R	Pack: 100				
	Part No.	\$ / 100	\$ / Ea	Part No.	\$ / 100	\$ / Ea	Part No.	\$ / 100	\$ / Ea			
LENGTH	40mm	KMRSZ1040	448.80	5.39	KMRSG1040	781.88	9.38	KMRSS1040	1,144.00	13.73	6	34
50mm	KMRSZ1050	451.00	5.41	KMRSG1050	814.00	9.77	KMRSS1050	1,166.00	13.99	10	40	
60mm	KMRSZ1060	467.50	5.61	KMRSG1060	814.00	9.77	KMRSS1060	1,320.00	15.84	20	40	
75mm	KMRSZ1075	478.50	5.74	KMRSG1075	847.00	10.16	KMRSS1075	1,394.80	16.74	35	40	
95mm	KMRSZ1095	522.50	6.27	KMRSG1095	1,007.60	12.09	KMRSS1095	1,771.00	21.25	55	40	
120mm	KMRSZ10120	649.00	7.79							80	40	

GAUGE	M12 Drill Hole Diameter: 12mm						
	CLEAR ZINC PLATED			GALVANISED			Maximum Fixture Thickness
	Driver: KM10R		Pack: 100	Driver: KM10R		Pack: 100	
	Part No.	\$ / 100	\$ / Ea	Part No.	\$ / 100	\$ / Ea	
60mm	KMRSZ1260	561.00	6.73	KMRSG1260	1,078.00	12.94	10
75mm	KMRSZ1275	583.00	7.00	KMRSG1275	1,193.50	14.32	25
100mm	KMRSZ12100	643.50	7.72	KMRSG12100	1,271.05	15.25	50
130mm	KMRSZ12130	698.50	8.38	KMRSG12130	1,353.00	16.24	80



GAUGE	M16 Drill Hole Diameter: 16mm			
	CLEAR ZINC PLATED			Maximum Fixture Thickness
	Driver: KM12R		Pack: 100	
	Part No.	\$ / 100	\$ / Ea	
65mm	KMRSZ1665	742.50	8.91	10
100mm	KMRSZ16100	852.50	10.23	45

\*Minimum hole depth quoted is for maximum fixture thickness.  
For thinner fixtures increase the hole depth accordingly.





Designed to save time and money when fixing security shield or other fixtures to concrete.

Bright zinc plated (CR-3) steel.  
RoHS Compliant.



Requires matching driver bit for installation, see page 54.



Can be re-torqued or removed as necessary, using the correct security tool.



## Pin Hex Security Shield Anchor

Bright Zinc Plated (CR3)

GAUGE	M8		
	Driver: H50	Pack: 100	
LENGTH	Part No.	\$ / 100	\$ / Ea
65mm	PHSA0865	679.60	8.16

GAUGE	M10		
	Driver: H60	Pack: 100	
LENGTH	Part No.	\$ / 100	\$ / Ea
75mm	PHSA1075	748.20	8.98



Non removable anchor.



Bright zinc plated (CR-3) steel.  
RoHS Compliant.



No specialist tools required – installed using a standard hex key.



Once fixture is installed, simply drill out socket recess with standard HSS drill bit (sizing as shown) to leave a completely tamper proof anchor.



Designed to provide maximum security for permanent fixtures.



## Drill Out Security Shield Anchor

Bright Zinc Plated (CR3)

SIZE	PIN HEX & DRILL OUT SECURITY SHIELD TECHNICAL					
	Drill Hole Diameter mm	Maximum Fixture Thickness mm*	Minimum Hole Depth mm**	Recommended Tightening Torque N.M.	Safe Static Loads Kn	
					Tension	Shear
M8 x 65	14	25	50	15	4.8	4.4
M10 x 75	16	25	60	27	6.2	6.1

GAUGE LENGTH	M8			
	STD 5mm Hex Bit	Pack: 100		HSS Drill Out Size mm
	Part No.	\$ / 100	\$ / Ea	
65mm	SGA0865	640.40	7.68	6.5

GAUGE LENGTH	M10			
	STD 5mm Hex Bit	Pack: 100		HSS Drill Out Size mm
Part No.	\$ / 100	\$ / Ea		
75mm	SGA1075	669.60	8.04	6.5

\* Max without washer

\*\* Minimum hole depth quoted is for maximum fixture thickness. For thinner fixtures increase the hole depth accordingly.



Hammer-in security solution for concrete, very fast and easy to install.

With 100% contact, Fastdrives create compressive strength which provides superior holding power.



No specialist tools required – hammer in fixing.



Available in galvanized steel.



## Fastdrive™

Galvanised

GAUGE	5mm		
	Pack: 100		
LENGTH	Part No.	\$ / 100	\$ / Ea
30mm	FDCA530	32.50	0.39
40mm	FDCA540	39.20	0.47
50mm	FDCA550	47.50	0.57
65mm	FDCA565	53.20	0.64
75mm	FDCA575	65.40	0.78
85mm	FDCA585	139.00	1.67
100mm	FDCA5100	118.90	1.43



## Fastdrive™ Technical Data

304 Stainless

DRILL SIZE MM	TECHNICAL DATA			
	Total Length mm	Minimum Embedment mm	Maximum Fixing Thickness mm	Clearance Hole Size mm
5	30	25	5	6.5
5	40	25	15	6.5
5	50	30	20	6.5
5	65	30	35	6.5
5	75	30	45	6.5
5	85	30	55	6.5
5	100	30	70	6.5

30 MPA CONCRETE		
Embedment Depth mm	Ultimate Tension (Kn)	Ultimate Shear (Kn)
20	5.4	8.2
25	7.4	13.8
32	10.6	14.9

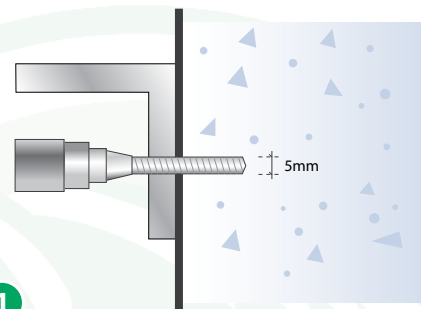

1  
Drill a 5mm diameter hole to the recommended minimum depth and clean hole.

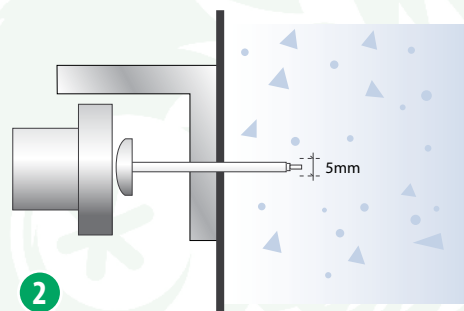

2  
Insert Fastdrive™ through material to be fastened and drive with a hammer until head is flush.



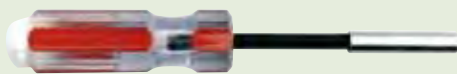

## Standard Magnetic Screwdriver

With storage area in handle and 1/4" hex drive for interchangeable bits

Part No.	\$ / Ea
SMH	34.20



## Ratchet Magnetic Screwdriver

Reversible silent ratchet magnetic screwdriver. Storage area in handle and 1/4" hex drive for interchangeable bits

Part No.	\$ / Ea
RMH	45.60

## 2 Hole



One Piece Screwdriver To Order Only



1/4" Hex Insert Bit x 25mm

Part No.	\$ / Ea
TH3-B	9.90
TH4-B	9.90
TH5-B	9.90
TH6-B	9.90
TH7-B	9.90
TH8-B	9.90

## Pin Hex



1/4" Hex Insert Bit x 25mm

Hex Size	Part No.	\$ / Ea
3/32"	H20-B	9.90
1/8"	H30-B	9.90
5/32"	H40-B	9.90
5.0mm	H50-B	15.00
6.0mm	H60-B	25.00
8.0mm	H80-B	25.00
3/16"	H3/16-B	9.90
7/32"	H7/32-B	9.90
2.0mm	H2M-B	9.90
2.5mm	H25M-B	9.90
3.0mm	H3M-B	9.90
4.0mm	H4M-B	9.90

1/4" Hex Insert Bit x 50mm

Hex Size	Part No.	\$ / Ea
3/32"	H2050-B	12.00
1/8"	H3050-B	12.00
5/32"	H4050-B	12.00

1/4" Hex Insert Bit x 70mm

Hex Size	Part No.	\$ / Ea
5/32"	H4070-B	12.00

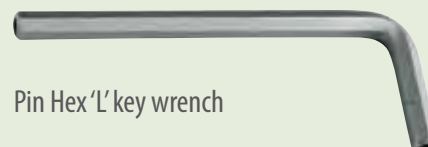

Pin Hex 'L' key wrench

Hex Size	Part No.	\$ / Ea
3/32"	H20-K	9.90
1/8"	H30-K	9.90
5/32"	H40-K	9.90
5.0mm	H50-K	15.00
6.0mm	H60-K	25.00
8.0mm	H80-K	25.00
10.0mm	H100-K	75.00
3/16"	H3/16-K	9.90
7/32"	H7/32-K	9.90
2.0mm	H2M-K	9.90
2.5mm	H25M-K	9.90
3.0mm	H3M-K	9.90

### Please note:

Security tools are not guaranteed against breakage, misuse, over-torque or wear. Always ensure correct alignment and care when fastening. Observe safety.





## Resytork



1/4" x 65mm Hex  
Insert Bit T-20 & T-30  
Double ended

Part No.	\$ / Ea
T2030-B	15.00

1/4" Hex Insert Bit  
x 25mm

Part No.	\$ / Ea
T6-B	9.90
T7-B	9.90
T8-B	9.90
T9-B	9.90
T10-B	9.90
T15-B	9.90
T20-B	9.90
T25-B	9.90
T27-B	9.90
T30-B	9.90
T40-B	9.90
T45-B	9.90
T50-B	15.00

1/4" Hex Insert Bit  
x 50mm

Part No.	\$ / Ea
T1050-B	12.00
T1550-B	12.00
T2050-B	12.00
T2550-B	12.00
T2750-B	12.00
T3050-B	12.00

1/4" Hex Insert Bit  
x 75mm

Part No.	\$ / Ea
T575-B	13.60
T675-B	13.60
T775-B	13.60
T875-B	13.60
T975-B	13.60
T1075-B	13.60
T1575-B	13.60
T2075-B	13.60
T2575-B	13.60
T2775-B	13.60
T3075-B	13.60

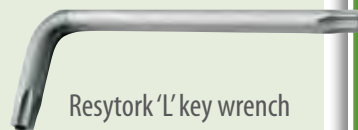

Resytork 'L' key wrench

Part No.	\$ / Ea
T10-K	13.00
T15-K	13.00
T20-K	13.00
T25-K	13.00
T27-K	23.90
T30-K	23.90
T40-K	23.90
T45-K	23.90

TOOLING



## Resytork Driver Pack 1

(25mm Bits) 10 Pce

Contains: T8-B, T9-B, T10-B, T15-B, T20-B,  
T25-B, T27-B, T30-B, T40-B, T45-B.

Part No.	\$ / Ea
RTDP1	70.00

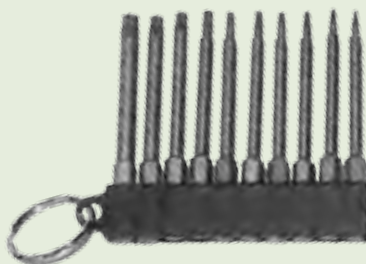

## Resytork Driver Pack 2

(75mm Bits) 10 Pce

Contains: T575-B, T675-B, T775-B, T875-B, T975-B,  
T1075-B, T1575-B, T2075-B, T2575-B, T3075-B.

Part No.	\$ / Ea
RTDP2	118.75

## Resytork Screwdriver

One Piece Screwdriver



Part No.	\$ / Ea
T5-SD	22.50
T6-SD	22.50
T7-SD	22.50
T8-SD	22.50
T9-SD	22.50
T10-SD	27.50

T15-SD	27.50
T20-SD	27.50
T25-SD	27.50
T27-SD	27.50
T30-SD	27.50
T40-SD	27.50
T45-SD	27.50

## Standard Tork

1/4" Hex Insert Bit x 25mm

Part No.	\$ / Ea
T20-S	2.50
T25-S	2.50

T30-S	2.50
T40-S	2.50

**TORXplus®**

1/4" Hex Insert Bit x 25mm

Part No.	\$ / Ea
10 IPR	57.00
15 IPR	57.00
20 IPR	57.00
25 IPR	57.00
27 IPR	57.00
30 IPR	57.00

**Oval Pan Head**

Driver Socket

Part No.	\$ / Ea
PHD1	99.00
PHD2	99.00

**Tri-Lobular**1/4" Hex Insert Bit  
– Suits 10 Gauge

Part No.	\$ / Ea
TL2-B Suits 10G	9.90
TL2100-B (100mm) Suits 10G	21.70
TL10-B Suits M10	18.00

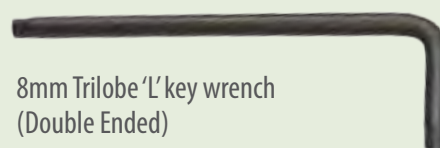
8mm Trilobe 'L' key wrench  
(Double Ended)

Part No.	\$ / Ea
TL10-K	28.00

8mm Hex Insert Bit  
– Suits M10**Clutch Head Removal Tool**

For use with Clutch Head screws only. The two tungsten carbide tips dig into the sloping areas of the Clutch Head and enable removal when applying pressure.

Part No.	\$ / Ea
RT41	69.00
RT51	69.00
RT61	69.00

**Pin Phillips**

1/4" Hex Insert Bit x 25mm

Part No.	\$ / Ea
PP2-B	18.00
PP3-B	18.00

**Slotted Drive  
(Suits Clutch Head)**

1/4" Hex Insert Bit

Part No.	\$ / Ea
SLD525 (25mm)	3.50
SLD550 (50mm)	5.20
SLD850 (50mm)	6.50
SLD1050 (50mm)	7.50

**Quadtech™**1/4" Hex Insert Bit  
x 50mm

Part No.	\$ / Ea
SD2-B	18.00

**Pentaforce™**

1/4" Hex Insert Bit

Part No.	\$ / Ea
PFD0-B (50mm)	24.00
PFD1-B (50mm)	24.00
PFD1150-B (150mm)	36.00
PFD2-B (50mm)	28.00
PFD3-B (50mm)	32.00

**Please note:** Security tools are not guaranteed against breakage, misuse, over-torque or wear.  
Always ensure correct alignment and care when fastening. Observe safety.



## Kinmar® Permanent

1/2" Hex Drive Socket

Part No.	\$ / Ea
KM5P	82.40
KM6P	82.40
KM8P	82.40
KM10P	110.00
KM12P	128.00



## Kinmar® Removable

1/2" Hex Drive Socket

Part No.	\$ / Ea
KM5R	82.40
KM6R	82.40
KM8R	82.40
KM10R	110.00
KM12R	128.00



## Stellar™

Driver Socket

Part No.	\$ / Ea
SRSM12SP	124.00
SRS12-1	124.00



## Armour Ring™

Setting Tool

Part No.	\$ / Ea
ARST5.5	198.00
ARST6	198.00



## Scroll™ Nut

Driver Socket

Part No.	\$ / Ea
SC3	245.70
SC4	245.70
SC5	273.00
SC6	307.13
SC8	341.25
SC10	375.38
SC12	409.50
SC16	477.75
SC20	614.25
SC24	682.50



## 4 - Hole

T-Bar Driver

Part No.	\$ / Ea
FH1	283.00
FH2	295.00
FH3	329.00

## Socket Adaptors



1/4" Socket Set Adaptor

Part No.	\$ / Ea
SA1	48.20

**Please note:** Security tools are not guaranteed against breakage, misuse, over-torque or wear. Always ensure correct alignment and care when fastening. Observe safety.







## Specials

Sentinel Group are able to offer a made to measure range of Security Fasteners. Our expert sales team are able to assist with every type of security application from design stage to final installation, including on-site testing.

### Design



### Manufacture



### On-site Testing



### Installation



### Security

















**Safety**





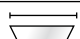

## Dimensions

Guide sizes only. For accurate current stock sizes, please contact sales team.  
Samples available for approval upon request.

	SCREW TYPE		SELF TAPPING SCREW GAUGE						METRIC MACHINE			
	2-HOLE		No 4	No 6	No 8	No 10	No 12	No 14	M3	M4	M5	M6
	DIMENSIONS		2.9mm	3.5mm	4.2mm	4.8mm	5.5mm	6.3mm				
Pan Head	 A		5.4	6.7	8	9.2	10.5	12.2	5.8	7.8	9.8	11.8
	 I B		1.6	2	2.3	2.7	3.2	3.5	1.8	2.4	2.9	3.5
Countersunk Head	 A		5.5	6.7	7.9	9	10.3	12.2	5.5	7.4	9	10.8
	 I B		2	2.5	2.8	3.6	3.7	4.6	1.6	2.4	2.9	3.5

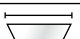



	SCREW TYPE		SELF TAPPING SCREW GAUGE						METRIC MACHINE SCREWS					
	RESYTORK		No 4	No 6	No 8	No 10	No 12	No 14	M3	M4	M5	M6	M8	M10
	DIMENSIONS		2.9mm	3.5mm	4.2mm	4.8mm	5.5mm	6.3mm						
Button Head	 A			6.7	7.4	9.3	10	11	5.5	7.4	9.3	10.3	13.7	17.3
	 I B			2.5	2.1	2.6	3.1	3.4	1.7	2.1	2.6	3.2	4.5	5.5
Countersunk Head	 A		4.8	6.6	7.9	9.3	10	13	5.9	7.8	9.8	11.8	14	17.3
	 I B		1.8	2.1	2.5	3	4	4.8	2	2.3	2.8	3.3	4.7	5.2

	SCREW TYPE		SELF TAPPING SCREW GAUGE					METRIC MACHINE SCREWS						
	PIN HEX		No 6	No 8	No 10	No 12	No 14	M3	M4	M5	M6	M8	M10	M12
	DIMENSIONS													
Button Head		A	6.7	7.4	9.3	9.9	11	5.5	7.4	9.3	10.3	13.7	17.4	20.5
		I B	2.5	2.1	2.6	2.9	3.4	1.7	2.1	2.6	3.2	4.4	5.5	6.5
Countersunk Head		A	6.6	7.9	9.3	11.7	12.8	5.5	7.8	9.8	11.8	15.7	19.7	23.6
		I B	2.1	2.5	3	4.8	5.2	1.7	2.3	2.8	3.3	5.2	6.3	7.5

### Please note:

The guide only shows sizes without min. and max. tolerances.

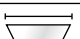
Sentinel Group reserve the rights to change/alter sizes without notice.

	SCREW TYPE		IMPERIAL METRIC MACHINE				
	RESYTORK		6-32 UNC	8-32 UNC	10-24 UNC	10-32 UNC	1/4-20 UNC
	DIMENSIONS						
Button Head	 A		6.5	7.5	9	9	11
	 I B		2.2	2.2	2.5	2.5	3.2
Countersunk Head	 A		6.35	7.5	9	9	12.5
	 I B		2.5	3	3.5	3.5	4.5



### Recommended Drill Sizes for AB Type Self Tapping Screws into Metal

SCREW SIZE		PLATE GAUGE	DRILLED OR PUNCHED: HOLE DIAMETER	
Gauge No	Metric Equiv.	Metal Thickness	Steel, Stainless, Copper, Brass, Nickel Hole Dia.	Aluminium Hole Dia.
#2	2.2	0.46	1.63	
		0.61	1.70	1.63
		0.76	1.78	1.63
		1.22	1.85	1.70
		1.52	1.93	1.78
#4	2.9	0.46	2.18	
		0.61	2.26	
		0.76	2.39	
		1.22	2.44	2.18
		1.52	2.54	2.26
#6	3.5	0.46	2.64	
		0.76	2.69	
		0.91	2.79	
		1.22	2.82	2.64
		1.52	2.95	2.69
#8	4.2	0.91	3.18	3.05
		1.22	3.25	3.25
		1.52	3.45	3.45
		1.91	3.56	3.56
		2.67	3.81	3.73
#10	4.8	3.43	3.86	3.78
		4.11		
		9.53		3.86
		0.76	3.66	
		0.91	3.73	
#12	5.5	1.52	3.86	3.66
		1.91	3.99	
		2.67	4.09	3.73
		3.43	4.32	3.91
		4.11	4.39	4.04
#14	6.3	5.08		
		9.53		4.22
		0.91	4.22	
		1.22	4.32	4.09
		1.52	4.50	4.22
#16	7.0	1.91	4.62	4.39
		2.67	4.70	4.57
		3.43	4.98	4.63
		4.11	5.11	4.80
		5.08		
#18	7.6	9.53		4.98
		1.22	4.93	
		1.52	5.05	5.05
		1.91	5.18	5.11
		2.67	5.31	5.18
#20	8.0	3.43	5.79	5.31
		4.93	5.94	5.61
		5.08		
		9.53		5.79

## Common Thread Specifications

### Metric

150 METRIC COARSE				150 METRIC
Nom. Dia.	Major Dia.	Dia. Inch	Thread Pitch	Thread Pitch
M1.6	1.60	0.0630	0.35	
M1.8	1.80	0.0709	0.35	
M2	2.00	0.0787	0.40	
M2.2	2.20	0.0866	0.45	
M2.5	2.50	0.0984	0.45	
M3	3.00	0.1181	0.50	
M3.5	3.50	0.1378	0.60	
M4	4.00	0.1575	0.70	
M4.5	4.50	0.1772	0.75	
M5	5.00	0.1969	0.80	
M6	6.00	0.2362	1.00	
M8	8.00	0.3150	1.25	1.00
M10	10.00	0.3937	1.50	1.25
M12	12.00	0.4724	1.75	1.50
M14	14.00	0.5512	2.00	1.50
M16	16.00	0.6299	2.00	1.50
M18	18.00	0.7087	2.50	1.50
M20	20.00	0.7874	2.50	1.50
M24	24.00	0.9449	3.00	2.00

### Imperial

UNIFIED INCH PRODUCTS					B.S INCH PRODUCTS				
Nom. Dia.	Major Dia.		T.P.I		Nom. Dia.	Major Dia.		T.P.I	
	mm	inch	UNC	UNF		mm	inch	BSW	BSF
#0	1.52	0.060		80					
#1	1.85	0.073	64	72					
#2	2.18	0.086	56	64					
#3	2.51	0.099	48	56					
#4	2.84	0.112	40	48					
#5	3.18	0.125	40	44	1/8			40	
#6	3.51	0.138	32	40					
#8	4.17	0.164	32	36					
#10	4.83	0.190	24	32	3/16			24	32
#12	5.49	0.216	24	28					
(#14) 1/4	6.35	0.250	20	28	1/4			20	26
5/16	7.95	0.313	18	24	5/16			18	22
3/8	9.53	0.375	16	24	3/8			16	20
7/16	11.13	0.438	14	20	7/16			14	16
1/2	12.70	0.500	13	20	1/2			12	16
9/16	14.30	0.563	12	18	9/16			12	16
5/8	15.88	0.625	11	18	5/8			11	14
3/4	19.05	0.750	10	16	3/4			10	12
7/8	22.23	0.875	9	14	7/8			9	11
1	25.40	1.000	8	12	1			8	10

Every effort has been made to ensure the accuracy of information provided in this catalogue. Sentinel Group cannot warrant the information however, expressly or implied, and any liability arising from it is expressly excluded. Customers must satisfy themselves as to the suitability of products and the technical information relating to them, and it is recommended that you conduct your own tests to establish suitability. This does not effect your statutory rights.



## Fastener Material Selection

Due to the wide variety of material used in fastener manufacture the following should be considered to aid selection.

In previous times it was considered necessary for periodical repair of mechanical and electrical components. Today greater consideration is being given to the reduction of maintenance. In cases where a fastener must be removed, corrosion resistance is particularly important to avoid corrosion hindering or preventing fastener removal.

The cost of dealing with corroded fasteners is more expensive than using corrosion resistant fasteners originally. This is especially so when other costs resulting from fastener failure, such as lost production or down time, are taken into consideration.

A low cost option for designers considering corrosion resistance are plated fasteners. These are usually manufactured from mild steel and given a corrosion resistant coating of gal. or zinc. Whilst these coatings may be adequate in non severe corrosive conditions, many designers consider the additional cost of an inherently corrosion resistant material, such as stainless steel, to be an inexpensive insurance against possible failure or discolouration.

In considering the cost factor in using stainless steel fasteners, it is interesting to note that the overall cost of the finished product will generally be affected only by an insignificant amount if we choose stainless.

Where a different colour or surface finish is required for aesthetic appeal this requirement can usually be accommodated in stainless steel.

The designer should consider a fastener as an integral part of the design because a joint is normally under stress and possibly where a failure is likely to occur. Therefore designers should start with the best fastener and design the joint around it.

## Stainless Steels

Stainless steel is a family of iron-base alloy steel containing 10.5% or more chromium, and other alloys such as nickel, manganese, molybdenum, sulphur, etc.

The chromium takes care of corrosion and heat resistance. Corrosion resistance is due to the presence of a naturally occurring chromium-rich oxide film on the steel's surface. This inert film adheres tightly to the metal and is rapidly self repairing in the presence of oxygen or surface damage.

The other alloys in stainless steel also enhance corrosion resistance and impart certain characteristics with respect to strength and fabricability.

Stainless steel as used in fastener manufacture is normally identified by the following three terms on the basis of their metallurgical structure. Under each classification the material tends to have similar characteristics with regards corrosion resistance, hardenability and fabricability.

*Austenitic* - These stainless steels are chromium-nickel and chromium-nickel-manganese compositions. They are

hardenable by cold working and are non-magnetic in the annealed condition. Typical of this group is Type 304 or A2 which contains at least 18% chromium and 8% nickel, hence its 18-8 name.

*Ferritic* - These stainless steels are straight chromium steels that are not hardenable by heat treatment and slightly hardenable by cold working. All this type is magnetic. Type 430 is a typical example.

*Martensitic* - These stainless steels are straight chromium that can be hardened by heat treatment only. All this type is magnetic and Type 410 is a typical example.

## Stainless Steel - The Right Choice

To aid the designer to choose the correct grade of stainless steel in a particular application, the following should be considered.

- All the austenitic stainless steels have excellent corrosion resistance. Type 304 (A2) is the most widely used and is virtually immune to foodstuffs, sterilising solutions, most organic chemicals and many inorganic chemicals.
- If an application demands higher corrosion resistance, Type 316 (A4) is the next choice. This type resists corrosion in environments containing chlorides or sulphurous acid compounds. It can also be used in phosphoric and acetic acids that can cause corrosion to Type 304.
- The relative resistance to corrosion among the common stainless steel fastener materials is: Austenitic (316) superior, (304) excellent, Ferritic (430) good, Martensitic (410) fair.

When these types have been considered on the basis of their corrosion-resistant properties the next concern will be their tensile strength or its capacity to withstand load. See the following chart.

## Stainless Steel Fasteners

### - Installation Procedures

For a fastener to be effective it will be obvious to the designer the fastener must be installed correctly. Incorrect installation can lead to difficulty such as seizing and galling or alternatively the fastener may work loose with vibration.

Reasonable care should be taken in handling fasteners to ensure threads are kept clean and free of dirt.

It is also critical that the fastener is installed to the correct torque. Trouble occurs in this area when fastener installation is attempted without correct torque measuring tools. There are some guidelines in this situation.

- 1) Tighten the fastener finger tight.
- 2) Tighten the fastener one additional turn (360 degrees).

**Note:** This specification may be too high for 410 type hardened stainless steel and primarily applies to Austenitic stainless steel fasteners.



## Tensile Strength of Nine Fastener Alloys

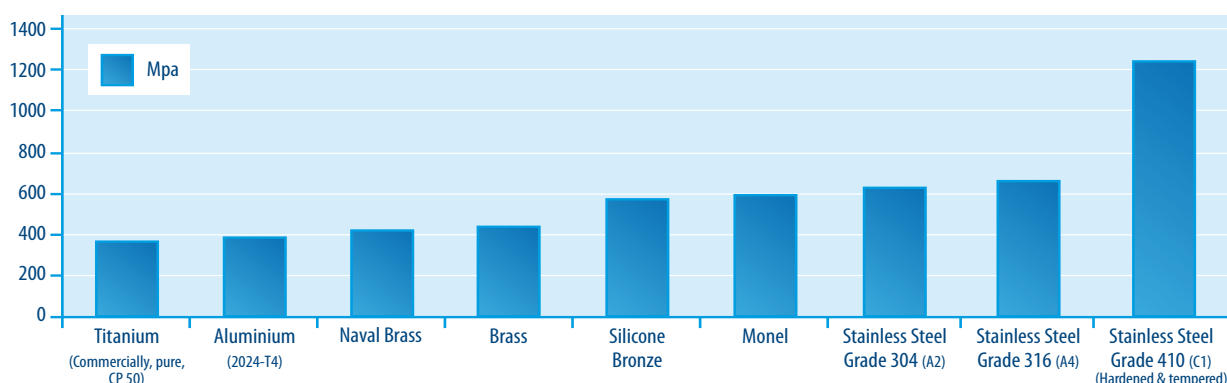

## Corrosion - A Closer Look

The best way to combat the destructive character of corrosion is by prevention. One common practice in industry is to use a fastener material that is more corrosion resistant than the joining materials. The reason being, the fastener is the key to joint integrity and corrosion affected fasteners may cause a major failure, whereas the same amount of corrosive attack elsewhere may not cause a problem.

There are several types of corrosion that can occur in fasteners. The most prevalent form is called galvanic corrosion.

Galvanic corrosion can occur between dissimilar metals in the presence of an electrolyte which could be no more than polluted water. When the two metals are in contact, in effect, a battery is created. Current flows and one of the metals corrodes.

In considering galvanic corrosion it is important to know which of the two metals is more anodic (least noble). This metal will have corrosion accelerated. See following table.

## Guidelines For Selection Of Fasteners Based On Galvanic Action

Fastener Metal Base Metal	Zinc & Galvanised Steel	Aluminium & Aluminium Alloys	Steel & Cast Iron	Brasses, Copper, Bronzes, Monel	Martensitic Stainless Type 410	Austenitic Stainless Types 302/304, 303, 305
Zinc and Galvanised Steel	A	B	B	C	C	C
Aluminium and Aluminium Alloys	A	A	B	C	Not Recommended	B
Steel & Cast Iron	A,D	A	A	C	C	B
Terne (Lead-Tin) Plated Steel Sheets	A,D,E	A,E	A,E	C	C	B
Brasses, Copper, Bronzes, Monel	A,D,E	A,E	A,E	A	A	B
Ferritic Stainless Steel (Type 430)	A,D,E	A,E	A,E	A	A	A
Austenitic Stainless Steel (Type 302/304)	A,D,E	A,E	A,E	A,E	A	A

### KEY

**A.** The corrosion of the base metal is not increased by the fastener.

**B.** The corrosion of the base metal is marginally increased by the fastener.

**C.** The corrosion of the base metal may be markedly

increased by the fastener material.

**D.** The plating on the fastener is rapidly consumed, leaving the bare fastener metal.

**E.** The corrosion of the fastener is increased by the base metal.

**NOTE:** Surface treatment and environment can change activity.

Every effort has been made to ensure the accuracy of information provided in this catalogue. Sentinel Group cannot warrant the information however, expressly or implied, and any liability arising from it is expressly excluded. Customers must satisfy themselves as to the suitability of products and the technical information relating to them, and it is recommended that you conduct your own tests to establish suitability. This does not effect your statutory rights.







600W x 1200H – Free Standing or Wall Mount



## Merchandiser Stand

Boost your sales with this eye catching merchandiser stand. Stocked with our most popular stock selection (retail value of \$1800).



Merchandiser Clam Pack

PART NO	DESCRIPTION	DRIVER	QTY	\$/PACK
	<b>Resytork Button Head Self Tappers with Driver to suit</b>			
RTBS6D-25	6G x 1/2"	T10	25 x 2	\$30.85
RTBS8F-25	8G x 3/4"	T15	25 x 2	\$34.60
RTBS8G-25	8G x 1"	T15	25 x 2	\$37.85
RTBS8H-25	8G x 1 1/4"	T15	25 x 2	\$39.55
RTBS10G-25	10G x 1"	T25	25 x 2	\$43.25
RTBS10I-25	10G x 1 1/2"	T25	25 x 2	\$52.38
RTBS12J-20	12G x 2"	T27	20 x 1	\$61.94
RTBS12K-20	12G x 2 1/2"	T27	20 x 1	\$70.20
	<b>Resytork Countersunk Self Tappers with Driver to suit</b>			
RTCS8F-25	8G x 3/4"	T20	25 x 2	\$34.60
RTCS8G-25	8G x 1"	T20	25 x 2	\$37.85
RTCS8I-25	8G x 1 1/2"	T20	25 x 2	\$45.55
RTCS10G-25	10G x 1"	T25	25 x 2	\$43.25
RTCS10I-25	10G x 1 1/2"	T25	25 x 2	\$52.38
RTCS12J-20	12G x 2"	T27	20 x 1	\$61.94
	<b>Resytork Button Head Machine Screws with Driver to suit</b>			
RTBM412-25	M4 x 12mm	T20	25 x 2	\$29.80
RTBM516-25	M5 x 16mm	T25	25 x 2	\$37.25
RTBM520-25	M5 x 20mm	T25	25 x 2	\$39.08
RTBM616-25	M6 x 16mm	T30	25 x 2	\$36.73
RTBM620-25	M6 x 20mm	T30	25 x 2	\$38.85
RTBM625-25	M6 x 25mm	T30	25 x 2	\$43.13
RTBM630-25	M6 x 30mm	T30	25 x 2	\$45.35

PART NO	DESCRIPTION	QTY	\$/PACK
	<b>Clutch Head Round Head Self Tappers</b>		
CHRS8F-25	8G x 3/4"	25 x 2	\$12.76
CHRS10F-25	10G x 3/4"	25 x 2	\$15.68
CHRS10I-25	10G x 1 1/2"	25 x 2	\$20.09
	<b>Clutch Head Round Head Machine Screws</b>		
CHRM620-Z-25	M6 x 20mm Zinc	25 x 2	9.00
	<b>Shear Nuts</b>		
SHN6-Z-10	M6 - Zinc	10 x 1	15.00
SHN8-Z-10	M8 - Zinc	10 x 1	16.00
SHN10-Z-10	M10 - Zinc	10 x 1	21.00
<b>TOTAL RETAIL VALUE</b>			<b>\$1,805.72</b>

**ASK FOR YOUR SPECIAL DISCOUNT ON MERCHANDISERS**



## Promotional Products

We are the people that help you sell. We market our unique fastening solutions to your clients, to help you increase sales and improve profitability.

PROMOTIONAL



01: Prolok A4 Flyers

02: Prolok Store Poster  
Laminated A3 Size



04: Prolok Sample Case



05: Prolok DL Flyer

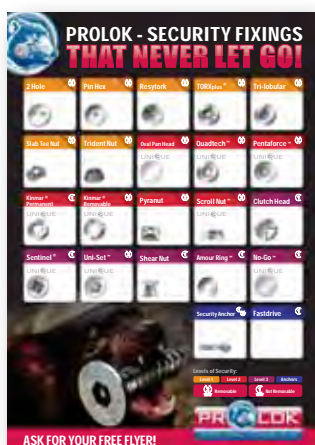

03: Prolok Sample Board  
400mm x 600mm



06: Electronic version of this  
catalogue also available

Call our friendly sales team on **1800 PRO LOK** to find out how we can help you promote security fasteners. Sales staff training available. Call us for details.

**"Tell them about Security Fixings"**



## Make it harder for the intruder!



Placing fasteners in tight corners makes access for impulse tampering harder.



Placing fasteners in a recess further raises the level of security.



Mixing of driver types makes it much harder for intrusion.



By using our rubber plugs you can seal the fastener recess from dirt and also hide the driver type. To order only.



**A. Can't find the size of screw you need?**

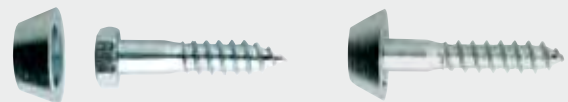

For a security coach screw use an Armour Ring™ on the hexagon head.



**B. How about using a length of studding with a security nut?**

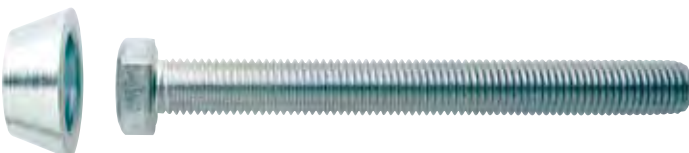

**C. Can you get it in a standard hex head? if so, you could use an Armour Ring™.**



**D. Want security both sides? You could use a standard cup head bolt with a security nut.**



## Do you deal with the following?

### Government

- Local Councils
- Parks & Gardens
- Dept. of Defense
- Dept. of Correctional Services
- Hospitals
- Museums/Art Galleries
- Police Dept.
- Schools & Universities

### Construction

- Prison Constructions
- Alarm Installers
- Public Toilets/Street Furniture Installation
- Airports/Railway Stations/Bus Terminals
- Stadiums
- Handrails/Balustrading
- External Lighting

### Manufacturing/Industrial

- Playground Manufacturers
- Street Furniture/Bus Shelter Manufacturers
- Vending Machine Manufacturers
- Electronics Industry
- Boom Gate/Security Fencing Manufacturers
- Marine/Boat Builders
- Sign Manufacturers
- Train & Bus Builders
- Auto Industry
- Shop Fitters
- Utilities Providers
- Window Screen Manufacturers
- Machine Safety Guard
- Solar Panel Manufacturers and Installers

***"Tell them about Security Fixings"***



Date:	
Acc.#	No.

**PHONE:** 03 5445 3200  
**FAX:** 03 5444 2200

## Goods Return / Adjustment

INV TO:		
CONTACT:		PHONE:
REP:	TERR:	FAX:

DEL TO:	
CONTACT:	PHONE:
APPROVED:	DATE:

## Details

PRODUCT CODE	DESCRIPTION	QTY	PRICE	TOTAL

### Reason for Return/Credit

- |  |  |
|--|--|
| <input type="checkbox"/> Incorrectly ordered by customer | <input type="checkbox"/> Settlement Discount _____ % Date paid ____/____/____      |
| <input type="checkbox"/> Not ordered by customer         | <input type="checkbox"/> Samples <input type="checkbox"/> Incorrect Product or Qty |
| <input type="checkbox"/> Faulty or damaged products      | <input type="checkbox"/> Freight <input type="checkbox"/> Other _____              |
| <input type="checkbox"/> Invoice/pricing error           | <input type="checkbox"/> Goods not received _____                                  |
| <input type="checkbox"/> Consignment                     | _____  |

SUB TOTAL	
GST	
<b>TOTAL</b>	

### You are Requesting A:

- ☐ CREDIT   
 ☐ REPLACEMENT   
 ☐ REPAIR   
 ☐ WARRANTY

DETAILS: Original Invoice No. \_\_\_\_\_ Date \_\_\_\_/\_\_\_\_/\_\_\_\_  
 Claim No. \_\_\_\_\_ Date \_\_\_\_/\_\_\_\_/\_\_\_\_

*Please return the above goods in their original packaging, and with the number clearly marked on the outer packaging. Please note that this is not a guarantee that a credit will be issued. We will need to inspect the goods first. Goods received damaged or not in their original packaging will not be accepted for credit. Many thanks for your co-operation.*

### SENTINEL Staff to Complete

Sentinel customer service officer: \_\_\_\_\_ Date \_\_\_\_/\_\_\_\_/\_\_\_\_

☐ Sales Rep to p/up \_\_\_\_\_ P/up Date \_\_\_\_/\_\_\_\_/\_\_\_\_  
☐ Freight to p/up - Company: \_\_\_\_\_ Con No. \_\_\_\_\_ P/up Date \_\_\_\_/\_\_\_\_/\_\_\_\_  
☐ Received into warehouse, per \_\_\_\_\_ Date \_\_\_\_/\_\_\_\_/\_\_\_\_  
☐ Credit Processed, per: \_\_\_\_\_ Adjust No. \_\_\_\_\_ Date \_\_\_\_/\_\_\_\_/\_\_\_\_  
☐ Please re-invoice and credit at above prices   
 ☐ Please credit products   
 ☐ Duplicated invoice - credit whole invoice  
☐ Other \_\_\_\_\_

*Photocopy this page for additional copies*



Date: \_\_\_\_\_

**I / We hereby apply for a trading account and submit the following confidential information for this purpose:**

Company Name \_\_\_\_\_ ACN: \_\_\_\_\_

Trading Name: \_\_\_\_\_ ABN: \_\_\_\_\_

Date Commenced Trading: \_\_\_\_\_ No. of Employees: \_\_\_\_\_

Public Company ( ) Private Company ( ) Partnership ( ) Sole Trader ( ) Trust ( )

Registered Office: \_\_\_\_\_ Post Code: \_\_\_\_\_

Postal Address: \_\_\_\_\_ Post Code: \_\_\_\_\_

Name of Buying Group (If applicable): \_\_\_\_\_

Business Premises: Leased / Rented ( ) Mortgaged ( ) Freehold ( )

Delivery Address: \_\_\_\_\_

Telephone No: \_\_\_\_\_ Facsimile No: \_\_\_\_\_

Email: \_\_\_\_\_ Type of Business: \_\_\_\_\_

Credit Required

\$

**Directors / Proprietors:**

	Full Name	Private Address	Telephone No.
1.	_____	_____	_____
2.	_____	_____	_____
3.	_____	_____	_____

Accounts Contact: \_\_\_\_\_ Phone: \_\_\_\_\_

Purchasing Contact: \_\_\_\_\_ Phone: \_\_\_\_\_

Bankers & Branch: \_\_\_\_\_

Chartered Accountant: \_\_\_\_\_

**Trade References: (Minimum of 3 required)**

	Name	State	Telephone No.
1.	_____	_____	_____
2.	_____	_____	_____
3.	_____	_____	_____
4.	_____	_____	_____

**Credit Terms**

1. Full payment strictly by 30th day of month following invoice date.
2. An account keeping fee may be imposed on overdue accounts.
3. Accounts referred to a Collection Agency or Solicitor will have all legal costs and commission added to the amount due.
4. Orders are subject to Sentinel Group Pty Ltd published Terms and Conditions.
5. Property in any goods sold will not pass until payment for these goods is made in full.

**Acceptance**

Signed: \_\_\_\_\_ Name: \_\_\_\_\_ Date: \_\_\_\_\_  
(Director / Proprietor) (Please Print Proprietor)





CATALOGUE PRICE \$22.00



**ADDRESS:** 354 Woodward Road GOLDEN SQUARE VIC 3555

**POSTAL:** P O Box 2488 BENDIGO DC VIC 3554

**PHONE:** +61 3 5445 3200 **FAX:** +61 3 5444 2200

**EMAIL:** [sales@sentinelgrp.com.au](mailto:sales@sentinelgrp.com.au)

**www.sentinelgrp.com.au**

**FREECALL: 1800 776 565**