



transform

# Stainless Hardware Stock List 2011



# Hobson Engineering Co. Pty. Ltd

A.B.N. 38 000 289 958

## Quality Fasteners Since 1935

### Sydney

10 Clay Place  
Eastern Creek NSW 2766

Ph: (02) 8818 0222

Fax: (02) 9620 1850

email: salesnsw@hobson.com.au

### Brisbane

62 Murdoch Circuit  
Acacia Ridge Qld 4110

Ph: (07) 3273 0777

Fax: (07) 3711 4551

email: salesqld@hobson.com.au

### Melbourne

Unit 1 155 Abbots Road  
Dandenong South Vic 3175

Ph: (03) 9797 3333

Fax: (03) 9799 3081

email: salesvic@hobson.com.au

### Perth

133 Beringarra Ave  
Malaga WA 6090

Ph: (08) 9241 9888

Fax: (08) 9248 8806

email: saleswa@hobson.com.au

### Tasmania Agent

R.M. Daniels & Co P/L

29 Mornington Road

Mornington Tas 7018

Ph: (03) 6244 7455

Fax: (03) 6244 7317

[www.hobson.com.au](http://www.hobson.com.au)

Published by Hobson Engineering Co. Pty. Ltd.  
P.O. Box 320  
Horsley Park N.S.W. 2175

Look out for other released Hobson Publications.

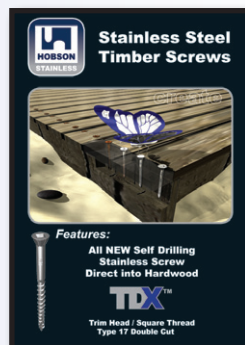
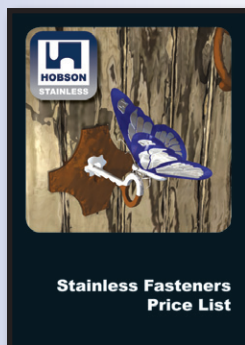
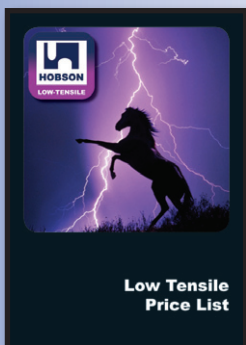

All rights reserved. Hobson Engineering Co. Pty. Ltd. is the owner of the copyright subsisting in this publication. Other than permitted by the Copyright Act, no part of this publication can be reproduced, copied or transmitted, in any form or by any means (electric, mechanical, photocopying, recording, storage in a retrieval system or otherwise), without the prior written consent of Hobson Engineering Co. Pty. Ltd. Hobson Engineering Co. Pty. Ltd. will vigorously pursue any breach of its copyright.

This publication is distributed on the basis and understanding that the publisher is not responsible for the results of any actions taken on the basis of information in this publication, nor for any error in or omission from this publication. The publisher expressly disclaims all and any liability and responsibility to any person, whether a reader of this publication or not, in respect of anything, and the consequences of anything, done or omitted to be done by any such person in reliance, whether wholly or partially, upon the whole or any part of the contents of this publication. Without limiting the generality of the foregoing the publisher accepts no liability for any loss or damage either direct or consequential arising out of or in relation to the use or application of the information or products referred to herein.

# Index



Wire Rope		2
Swage Terminals		4
Balustrading Accessories		6
Rigging Screws		10
Turnbuckles		10
Swivels		13
Hooks		14
Shackles		16
Pad Eyes		18
Eye Bolts / Nuts		20
Eye Screws		20
U-bolts		22
Toggle Latch / Pulleys		22
Rings / Chain		24
Tools		26

# 316 Stainless Wire Rope

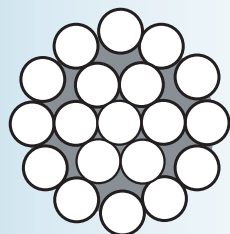

**Rigid**

## WIRE ROPE 1 X 19 CONSTRUCTION 316 STAINLESS

Part	Diam.	Wgt / Roll 305m	Stock
HRW1611901.0	1.0	1.50	✓
HRW1611901.2	1.2	2.20	✓
HRW1611901.6	1.6	3.10	✓
HRW1611902.0	2.0	6.30	✓
HRW1611902.5	2.5	9.10	✓
HRW1611903.2	3.2	15.90	✓
HRW1611904.0	4.0	25.00	✓
HRW1611905.0	5.0	39.30	✓
HRW1611906.0	6.0	56.40	✓
HRW1611908.0	8.0	95.50	✓
HRW1611910.0	10.0	150.40	✓

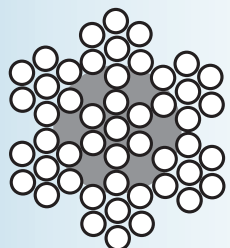

**Workable**

## WIRE ROPE 7 X 7 CONSTRUCTION 316 STAINLESS

Part	Diam.	Wgt / Roll 305m	Stock
HRW1670700.6	0.6	0.30	✓
HRW1670700.8	0.8	0.40	✓
HRW1670701.0	1.0	0.70	✓
HRW1670701.2	1.2	1.90	✓
HRW1670701.6	1.6	3.40	✓
HRW1670702.0	2.0	5.10	✓
HRW1670702.5	2.5	7.30	✓
HRW1670703.0	3.0	11.60	✓
HRW1670703.2	3.2	12.70	✓
HRW1670704.0	4.0	19.50	✓
HRW1670705.0	5.0	32.00	✓
HRW1670706.0	6.0	46.10	✓
HRW1670708.0	8.0	76.60	✓
HRW1670710.0	10.0	125.20	✓
HRW1670712.0	12.0	180.10	✓

## WIRE ROPE 7 X 7 CONSTRUCTION PVC WHITE COATED 316 STAINLESS

Part	Diam.	Wgt / Roll 305m	Stock
HRW1670703.2P	3.2 (5.0)	13.70	✓
HRW1670704.0P	4.0 (6.4)	20.50	✓

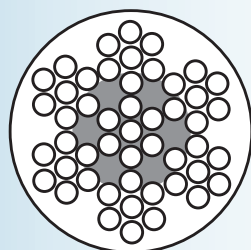

# 316 Stainless Wire Rope



## WIRE ROPE 7 X 19 CONSTRUCTION 316 STAINLESS

Part	Diam.	Wgt / Roll 305m	Stock
HRW1671902.0	2.0	5.20	✓
HRW1671902.5	2.5	7.90	✓
HRW1671903.2	3.2	13.20	✓
HRW1671904.0	4.0	20.40	✓
HRW1671905.0	5.0	32.70	✓
HRW1671906.0	6.0	47.00	✓
HRW1671908.0	8.0	78.40	✓
HRW1671910.0	10.0	126.30	✓
HRW1671912.0	12.0	181.10	✓

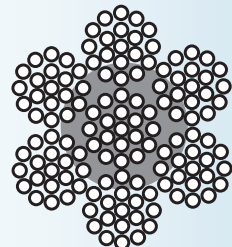

*Flexible*

## 100 MTR & 1000 MTR WIRE ROPE ROLLS 316 STAINLESS

Part	Diam.	Construction	Length (mtr)	Wgt / Roll	Stock
HRW1611903.21000	3.2	1 X 19	1000	52.13	✓
HRW1670703.20100	3.2	7 X 7	100	4.16	✓
HRW1670703.21000	3.2	7 X 7	1000	41.64	✓
HRW1671903.21000	3.2	7 X 19	1000	43.28	✓

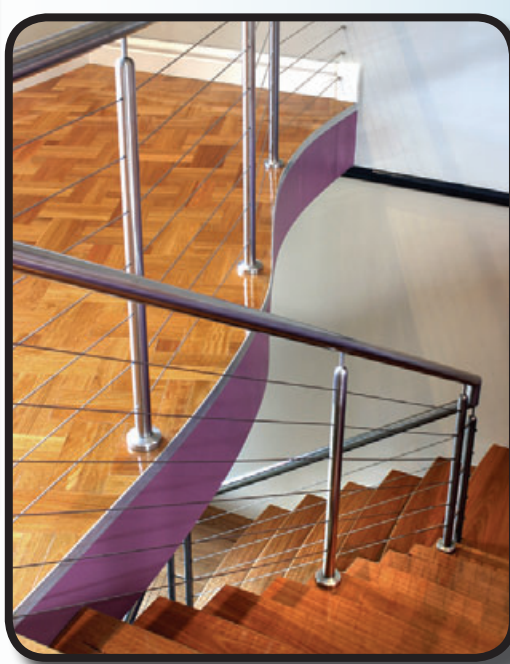

# Swage Terminals

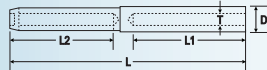

## TERMINAL SWAGE INTERNAL THREADED 316 STAINLESS

Part	T	Rope	L	L1	L2	D	Wgt (kg)	Stock
HTS16ITM0503.2	M5	3.2	90	45	45	7.5	0.02	✓
HTS16ITM0604.0	M6	4.0	95	46	49	8.0	0.02	✓
HTS16ITM0805.0	M8	5.0	120	60	60	10.0	0.04	✓

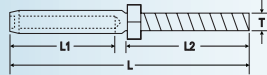

## TERMINAL SWAGE STUD 316 STAINLESS (incl. Lock Nut)

Part	T	Rope	L	L1	L2	Wgt (kg)	Stock
HTS16STM0502.5	M5	2.5	72	40	22	0.01	✓
HTS16STM0503.2	M5	3.2	90	42	39	0.01	✓
HTS16STM0602.5	M6	2.5	100	38	46	0.02	✓
HTS16STM0603.2	M6	3.2	100	48	39	0.02	✓
HTS16STM0604.0	M6	4.0	100	48	39	0.03	✓
HTS16STM0805.0	M8	5.0	117	57	45	0.03	✓
HTS16STM1006.0	M10	6.0	130	63	51	0.13	✓
HTS16STM1206.0	M12	6.0	162	80	64	0.11	✓
HTS16STM1206.0L	M12	6.0	235	63	135	0.19	✓
HTS16STM1208.0	M12	8.0	165	64	71	0.18	✓
HTS16STM1608.0	M16	8.0	225	90	92	0.29	✓
HTS16STM1610.0	M16	10.0	225	90	92	0.32	✓
HTS16STM1612.0	M16	12.0	225	90	92	0.32	✓

**NEW!**

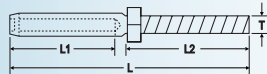

## TERMINAL SWAGE STUD LEFT HAND 316 STAINLESS (incl. Lock Nut)

Part	T	Rope	L	L1	L2	Wgt (kg)	Stock
HTS16SLM0503.2	M5	3.2	90	42	39	0.01	✓
HTS16SLM0603.2	M6	3.2	100	48	39	0.01	✓

# Swage Terminals



## TERMINAL SWAGE FORK 316 STAINLESS

Part	Rope	L1	L2	A	D	Wgt (kg)	Stock
HTS16FK02.5	2.5	55	24	7.0	5	0.02	✓
HTS16FK03.2	3.2	65	32	8.2	6	0.02	✓
HTS16FK04.0	4.0	73	45	9.2	6	0.03	✓
HTS16FK05.0	5.0	85	51	11.0	8	0.07	✓
HTS16FK06.0	6.0	106	63	15.0	12	0.11	✓
HTS16FK08.0	8.0	145	85	15.0	14	0.29	✓
HTS16FK10.0	10.0	149	89	22.0	14	0.35	✓

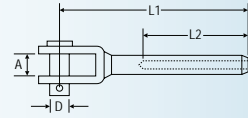

## TERMINAL SWAGE FORK MINI TYPE 316 STAINLESS

Part	Rope	L1	L2	A	D	Wgt (kg)	Stock
HTS16FM03.2	3.2	48	24	7.5	5	0.02	✓

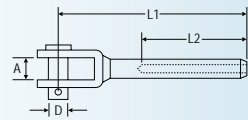

## TERMINAL SWAGE FORK TOGGLE 316 STAINLESS

Part	Rope	D	L1	L2	A	Wgt (kg)	Stock
HTS16FT03.2	3.2	6	75	32	8.2	0.03	✓
HTS16FT04.0	4.0	6	89	45	9.2	0.06	✓
HTS16FT05.0	5.0	8	104	51	11.0	0.10	✓
HTS16FT06.0	6.0	12	127	63	15.0	0.17	✓
HTS16FT08.0	8.0	14	163	85	15.0	0.32	✓
HTS16FT10.0	10.0	14	184	89	22.0	0.50	✓

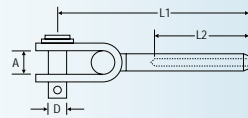

## TERMINAL SWAGE STUD MINI THREADED 316 STAINLESS

Part	Rope	T	L	L1	L2	Wgt (kg)	Stock
HTS16MT03.2	3.2	M6	67	38	16	0.01	✓

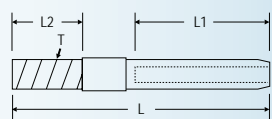

## TERMINAL SWAGE LAG SCREW 316 STAINLESS

Part	Rope	L	L1	E	THD	Wgt (kg)	Stock
HTS16RL-03.2	3.2	90.0	42.0	6	RHT	0.02	✓
HTS16LL-03.2	3.2	90.0	42.0	6	LHT	0.02	✓

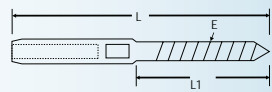

# Swage Terminals

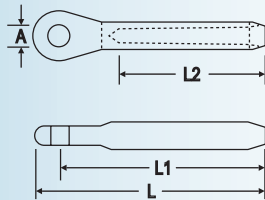

## TERMINAL SWAGE EYE 316 STAINLESS

Part	Rope	L	L1	L2	A	Wgt (kg)	Stock
HTS16EY02.5	2.5	55	49	32	6.0	0.01	✓
HTS16EY03.2	3.2	62	55	40	6.5	0.01	✓
HTS16EY04.0	4.0	77	61	45	8.0	0.02	✓
HTS16EY05.0	5.0	87	76	51	10.0	0.04	✓
HTS16EY06.0	6.0	106	90	64	12.5	0.10	✓
HTS16EY08.0	8.0	133	118	83	14.5	0.17	✓

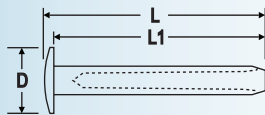

## TERMINAL SWAGE BUTTON HEAD 316 STAINLESS

Part	Rope	L	L1	D	Wgt (kg)	Stock
HTS16BH03.2	3.2	38	35	9.5	0.01	✓
HTS16BH04.0	4.0	54	50	12.5	0.01	✓



## NICKEL PLATED COPPER FERRULES - MACHINE

Part	Rope	Length	Stock
HXFEM-01.6	1.6	9.0	✓
HXFEM-02.0	2.0	9.0	✓
HXFEM-02.5	2.5	12.6	✓
HXFEM-03.2	3.2	12.6	✓
HXFEM-04.0	4.0	17.9	✓
HXFEM-05.0	5.0	25.5	✓
HXFEM-06.0	6.0	28.0	✓
HXFEM-08.0	8.0	28.0	✓
HXFEM-10.0	10.0	35.0	✓



## NICKEL PLATED COPPER FERRULES - HAND

Part	Rope	Length	Stock
HXFEH-01.6	1.6	9.0	✓
HXFEH-02.0	2.0	9.0	✓
HXFEH-02.5	2.5	12.6	✓
HXFEH-03.2	3.2	12.6	✓
HXFEH-04.0	4.0	17.9	✓
HXFEH-05.0	5.0	25.5	✓
HXFEH-06.0	6.0	28.0	✓



# Balustrading Accessories



## WIRE ROPE THIMBLE 304 STAINLESS

Part	Rope	A	B2	C	D	E	Stock
HXTH04N-02.0	2.0	7	12	21	5.0	3.2	✓
HXTH04N-03.2	3.2	9	14	23	6.0	4.0	✓
HXTH04N-04.0	4.0	11	16	27	7.0	5.0	✓
HXTH04N-05.0	5.0	14	21	21	8.0	6.0	✓
HXTH04N-06.0	6.0	16	26	39	9.5	7.0	✓
HXTH04N-08.0	8.0	21	35	50	12.0	9.0	✓
HXTH04N-10.0	10.0	26	42	59	14.0	11.0	✓
HXTH04N-12.0	12.0	31	48	70	17.5	14.0	✓
HXTH04N-14.0	14.0	34	55	76	20.0	16.0	✓
HXTH04N-16.0	16.0	39	63	85	21.0	17.0	✓
HXTH04N-18.0	18.0	41	68	93	23.0	19.0	✓
HXTH04N-20.0	20.0	45	73	103	26.0	22.0	✓
HXTH04N-22.0	22.0	50	82	112	32.0	24.0	✓

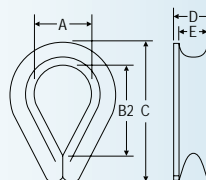

## WIRE ROPE OPEN THIMBLE 304 STAINLESS

Part	Rope	A	B2	C	D	E	G	Stock
HXTH04O-03.2	3.2	9	14	23	6.0	4.0	5.0	✓
HXTH04O-04.0	4.0	11	16	27	7.0	5.0	6.5	✓

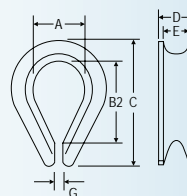

## SADDLE EYE STRAP 304 STAINLESS

Part	D	L1	L2	H	h	W	d	Wgt (kg)	Stock
HED04ST-04	4	40	32	16	11	10	3.2	0.01	✓
HED04ST-05	5	51	40	16	13	11	4.2	0.01	✓
HED04ST-06	6	57	44	22	16	14	5.2	0.01	✓
HED04ST-08	8	63	47	25	17	11	5.2	0.03	✓

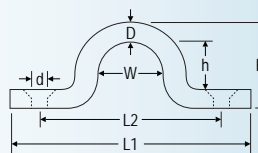

# Balustrading Accessories

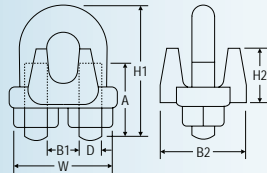

## WIRE ROPE GRIP 316 STAINLESS

Part	Rope	D	A	B1	B2	H1	H2	Stock
HXRW16G-02.0	2.0	M3	10	4	14	18	14	✓
HXRW16G-03.2	3.2	M4	12	5	16	24	17	✓
HXRW16G-04.0	4.0	M4	13	6	18	24	19	✓
HXRW16G-05.0	5.0	M6	15	7	20	33	24	✓
HXRW16G-06.0	6.0	M6	15	8	22	33	28	✓
HXRW16G-08.0	8.0	M8	20	10	28	40	34	✓
HXRW16G-10.0	10.0	M10	28	12	35	50	45	✓
HXRW16G-12.0	12.0	M12	35	14	39	60	51	✓
HXRW16G-16.0	16.0	M14	45	18	48	75	60	✓
HXRW16G-19.0	19.0	M14	50	20	53	80	62	✓
HXRW16G-25.0	25.0	M18	65	29	68	110	86	✓

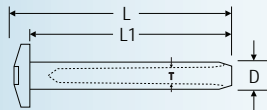

## HEAD TENSIONER - ALLEN KEY 304 STAINLESS (INTERNAL THREAD)

Part	T	L	L1	D	Wgt (kg)	Stock
HXHT04AKM06	M6	42	40	8	0.01	✓

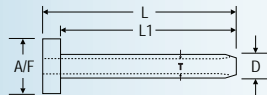

## HEAD TENSIONER - HEX HEAD 304 STAINLESS (INTERNAL THREAD)

Part	T	L	L1	D	A/F	Wgt (kg)	Stock
HXHT04HHM06	M6	39	35	8	12	0.01	✓
HXHT04HHM08	M8	39	35	10	12	0.01	✓



House design by Peter Downes Designs - [www.peterdownes.com](http://www.peterdownes.com)

# Balustrading Accessories



## CROSS CONNECTOR 304 STAINLESS

Part	Rope	D	H	T	Wgt (kg)	Stock
HXCC04-03.2	3.2	20.0	19.0	M12	0.03	✓
HXCC04-04.0	4.0	20.0	19.0	M12	0.03	✓

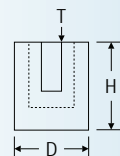

## NYLON BUSH BLACK SPLIT TYPE

Part	D2	H	D1	D	Rope	Stock
HXNBB-12.5	12.5	2.5	9.5	6.5	3.2-5.0	✓

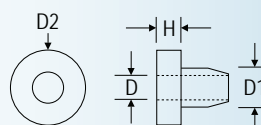

## BEVELLED WASHER BRASS CHROME PLATED

Part	I	D	A	L	Stock
HXWBBC-06.3	6.3	11.0	35°	10	✓
HXWBBC-08.3	8.3	11.0	35°	10	✓

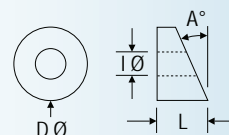

## INTERNAL THREADED BALL 316 STAINLESS

Part	T	D	L	Wgt (kg)	Stock
HXRB16TM06	M6	16	15	0.01	✓

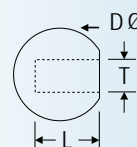

## ROUND BALL 316 STAINLESS

Part	I	D	F	Wgt (kg)	Stock
HXRB16-05.4	5.4	15	9.5	0.01	✓
HXRB16-06.3	6.3	20	11.5	0.03	✓

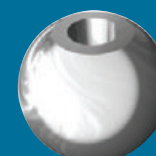
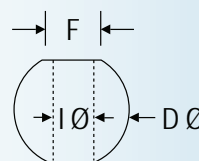

## WIRE ROPE SHELF SUPPORT CLIP 316 STAINLESS

Part	D	H	I	Rope	Wgt (kg)	Stock
HXSS16-02.5	10	8.0	2.5	0.6-2.5	0.01	✓
HXSS16-04.0	15	11.5	4.0	2.5-4.0	0.01	✓

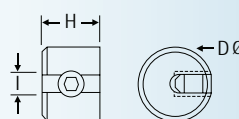

# Rigging Screws

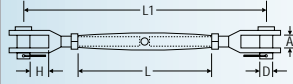

## RIGGING SCREW JAW + JAW 316 STAINLESS (incl. 2 Lock Nuts)

Part	Dia.	L1	L	A	D	H	Wgt (kg)	Stock
HRS16JJM05	M5	130	80	8.2	6	10	0.05	✓
HRS16JJM06	M6	150	95	9.2	6	10	0.01	✓
HRS16JJM08	M8	180	105	11.0	8	11	0.16	✓
HRS16JJM10	M10	220	125	15.0	12	14	0.21	✓
HRS16JJM12	M12	270	150	15.0	14	21	0.50	✓
HRS16JJM16	M16	300	190	22.0	14	26	0.97	✓

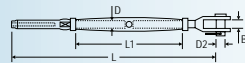

## RIGGING SCREW JAW + SWAGE 316 STAINLESS (incl. 2 Lock Nuts)

Part	D	ROPE	L1	L	D2	B	Wgt (kg)	Stock
HRS16JSM0502.5	M5	2.5	80	155	5	7.0	0.05	✓
HRS16JSM0503.2	M5	3.2	80	155	6	8.2	0.05	✓
HRS16JSM0603.2	M6	3.2	95	175	6	8.2	0.08	✓
HRS16JSM0604.0	M6	4.0	95	175	6	9.2	0.01	✓
HRS16JSM0805.0	M8	5.0	105	205	8	11.0	0.15	✓
HRS16JSM1006.0	M10	6.0	125	230	12	15.0	0.27	✓

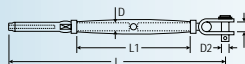

## RIGGING SCREW TOGGLE + SWAGE 316 STAINLESS (incl. 2 Lock Nuts)

Part	D	Rope	L	L1	D2	B	Wgt (kg)	Stock
HRS16TSM0603.2	M6	3.2	160	90	6	8.2	0.09	✓
HRS16TSM0604.0	M6	4.0	160	90	6	9.2	0.08	✓
HRS16TSM0805.0	M8	5.0	200	112	8	11.0	0.10	✓
HRS16TSM1006.0	M10	6.0	225	125	12	15.0	0.29	✓
HRS16TSM1208.0	M12	8.0	285	150	14	15.0	0.53	✓
HRS16TSM1610.0	M16	10.0	360	190	14	22.0	0.12	✓
HRS16TSM1612.0	M16	12.0	360	190	14	22.0	0.12	✓

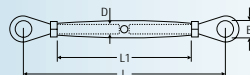

## RIGGING SCREW EYE + EYE 316 STAINLESS (incl. 2 Lock Nuts)

Part	D	B	L	L1	Wgt (kg)	Stock
HRS16EEM05	M5	5.5	128	80	0.03	✓
HRS16EEM06	M6	6.5	142	90	0.08	✓
HRS16EEM08	M8	8.5	155	105	0.12	✓

# TurnBuckles



## RIGGING SCREW JAW + SWAGE MINI TYPE 316 STAINLESS

Part	D	Rope	L	L1	L2	D2	B	Wgt (kg)	Stock
HRS16JSM0503.2M	M5	3.2	105	45	25	5	7.5	0.04	✓

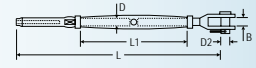

## PIN REPLACEMENT - CLEVIS 316 STAINLESS

Part	D	TO SUIT R/S	D2	L	Wgt (kg)	Stock
HXPINC-05.0	5.0	M5	8.0	19	0.01	✓
HXPINC-06.0	6.0	M6	9.0	21	0.01	✓
HXPINC-09.5	9.5	M10	13.5	29	0.02	✓

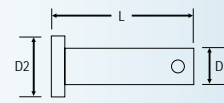

## RETAINING CLIP 316 STAINLESS

Part	Ring	TO SUIT R/S	Stock
HXRC-15.0	15	M5-M10	✓
HXRC-30.0	30	M12-M16	✓



## TURNBUCKLE - OPEN BODY JAW + JAW 316 STAINLESS (incl. 2 Lock Nuts)

Part	T	L1	L2	A	D	Wgt (kg)	Stock
HTB16JJM05	M5	125	70	8.2	6	0.05	✓
HTB16JJM06	M6	145	90	9.2	6	0.10	✓
HTB16JJM08	M8	180	120	11.0	8	0.20	✓
HTB16JJM10	M10	220	150	15.0	12	0.33	✓
HTB16JJM12	M12	320	198	15.0	14	0.63	✓

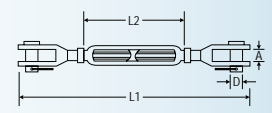

# TurnBuckles

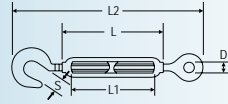

## TURNBUCKLE - OPEN BODY HOOK + EYE 316 STAINLESS (incl. 2 Lock Nuts)

Part	T	L	L1	L2	D	S	Wgt (kg)	Stock
HTB16HEM04	M4	55	47	98	8	9	0.03	✓
HTB16HEM05	M5	70	52	120	8	9	0.05	✓
HTB16HEM06	M6	90	66	160	10	10	0.08	✓
HTB16HEM08	M8	120	94	200	14	11	0.17	✓
HTB16HEM10	M10	150	120	240	16	13	0.30	✓
HTB16HEM12	M12	200	168	300	20	15	0.56	✓
HTB16HEM16	M16	250	210	390	26	16	1.20	✓
HTB16HEM20	M20	300	260	510	29	20	2.75	✓

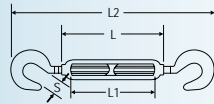

## TURNBUCKLE - OPEN BODY HOOK + HOOK 316 STAINLESS (incl. 2 Lock Nuts)

Part	T	L	L1	L2	S	Wgt (kg)	Stock
HTB16HHM04	M4	55	47	98	9	0.03	✓
HTB16HHM05	M5	70	52	120	9	0.05	✓
HTB16HHM06	M6	90	66	160	10	0.08	✓
HTB16HHM08	M8	120	94	200	11	0.17	✓
HTB16HHM10	M10	150	120	240	13	0.30	✓
HTB16HHM12	M12	200	168	300	15	0.56	✓
HTB16HHM16	M16	250	210	390	16	1.20	✓
HTB16HHM20	M20	300	260	510	20	2.75	✓

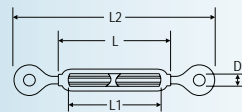

## TURNBUCKLE - OPEN BODY EYE + EYE 316 STAINLESS (incl. 2 Lock Nuts)

Part	T	L	L1	L2	D	Wgt (kg)	Stock
HTB16EEM04	M4	55	47	98	8	0.03	✓
HTB16EEM05	M5	70	52	120	8	0.05	✓
HTB16EEM06	M6	90	66	160	10	0.08	✓
HTB16EEM08	M8	120	94	200	14	0.17	✓
HTB16EEM10	M10	150	120	240	16	0.30	✓
HTB16EEM12	M12	200	168	300	20	0.56	✓
HTB16EEM16	M16	250	210	390	26	1.20	✓
HTB16EEM20	M20	300	260	510	29	2.75	✓

# Swivels



## SWIVEL EYE SNAP 316 STAINLESS

Part	d	L	W	S	H	t	Wgt (kg)	Stock
HSW16EP-12	12	76	21	7.5	11	5	0.04	✓
HSW16EP-19	19	90	24	8.5	18	8	0.05	✓
HSW16EP-25	25	97	24	10.0	23	10	0.05	✓

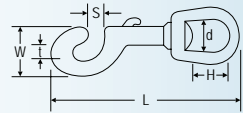

## SWIVEL EYE + EYE 316 STAINLESS

Part	A	L	L1	B	B1	Wgt (kg)	Stock
HSW16EE-06	6	65	15	26	15	0.05	✓
HSW16EE-08	8	94	22	35	20	0.12	✓
HSW16EE-10	10	118	27	44	24	0.24	✓
HSW16EE-12	12	128	28	48	25	0.56	✓

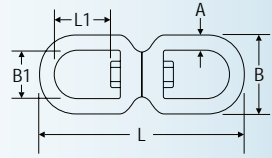

## SWIVEL JAW + JAW 316 STAINLESS

Part	D	L	B	C	Wgt (kg)	Stock
HSW16JJ-06	6	66	12	11	0.07	✓
HSW16JJ-08	8	94	16	16	0.17	✓
HSW16JJ-10	10	118	20	22	0.32	✓
HSW16JJ-12	12	152	26	28	0.61	✓

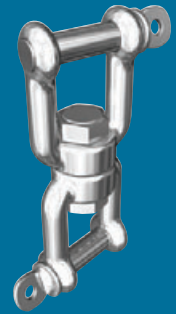
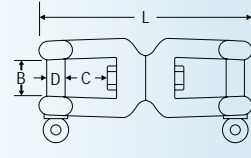

## SWIVEL EYE SNAP SHACKLE 316 STAINLESS

Part	A	B	L	Wgt (kg)	Stock
HSW16EK-12	12	12	70	0.06	✓
HSW16EK-16	16	16	87	0.13	✓
HSW16EK-22	22	22	128	0.88	✓

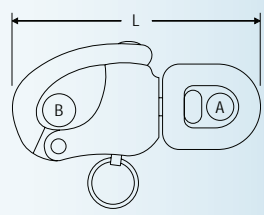

## SWIVEL JAW SNAP SHACKLE 316 STAINLESS

Part	A	B	C	L	Wgt (kg)	Stock
HSW16JK-12	12	12	10	70	0.07	✓
HSW16JK-16	16	13	13	87	0.16	✓
HSW16JK-22	22	16	18	128	0.88	✓

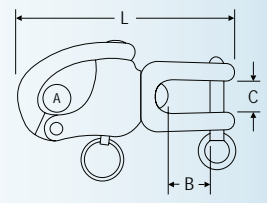

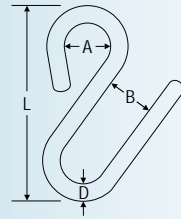

### "S" HOOK 304 STAINLESS

Part	D	L	A	B	Wgt (kg)	Stock
HHK04S-05	5	50	9	8.5	0.02	✓
HHK04S-06	6	60	12	11.0	0.03	✓
HHK04S-08	8	75	16	15.0	0.06	✓
HHK04S-09	9	85	18	17.0	0.10	✓
HHK04S-10	10	100	18	18.0	0.11	✓

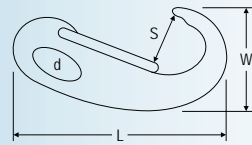

### CAST SNAP HOOK 316 STAINLESS

Part	L	W	S	d	Wgt (kg)	Stock
HHK16CP-050	50	25	10	8	0.02	✓
HHK16CP-070	70	31	11	12	0.06	✓
HHK16CP-100	100	50	15	16	0.14	✓

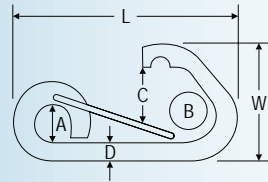

### ASYMMETRIC SPRING HOOK 316 STAINLESS

Part	D	L	W	A	B	C	Wgt (kg)	Stock
HHK16SA-06	6	61	35	7	10	10	0.03	✓
HHK16SA-08	8	81	48	11	13	13	0.07	✓
HHK16SA-10	10	102	58	13	15	15	0.12	✓
HHK16SA-12	12	122	70	16	21	21	0.22	✓

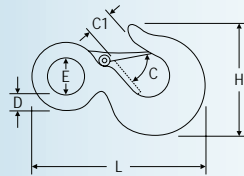

### SNAP HOOK - SAFETY WITH LATCH 316 STAINLESS

Part	E	C	D	H	C1	L	Wgt (kg)	Stock
HHK16CL-19	19	21	9	73	22	102	0.13	✓
HHK16CL-28	28	21	11	81	25	127	0.18	✓

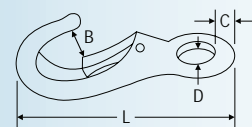

### SNAP HOOK - RIGID EYE 316 STAINLESS

Part	D	C	B	L	Wgt (kg)	Stock
HHK16CR-16	16	5	9	72	0.05	✓
HHK16CR-21	21	7	15	98	0.11	✓



# Hooks



## SPRING HOOK WITH EYE 316 STAINLESS

Part	D	L	B	A1	E	Wgt (kg)	Stock
HHK16SE-04	4	40	6.5	9	7	0.01	✓
HHK16SE-05	5	50	7.5	10	8	0.02	✓
HHK16SE-06	6	60	9.0	13	9	0.02	✓
HHK16SE-08	8	80	11.5	13	9	0.06	✓
HHK16SE-10	10	100	14.0	16	12	0.13	✓
HHK16SE-11	11	120	16.5	18	16	0.19	✓

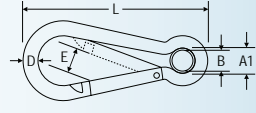

## SPRING HOOK 316 STAINLESS

Part	D	L	A	A1	E	Wgt (kg)	Stock
HHK16SP-04	4	40	5	9	7	0.01	✓
HHK16SP-05	5	50	6	10	8	0.02	✓
HHK16SP-06	6	60	8	13	9	0.02	✓
HHK16SP-08	8	80	8	13	9	0.06	✓
HHK16SP-10	10	100	10	16	12	0.13	✓
HHK16SP-11	11	120	11	18	16	0.19	✓

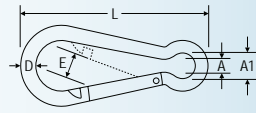

## SPRING HOOK WITH EYE AND NUT 316 STAINLESS

Part	D	L	A1	E	B	Wgt (kg)	Stock
HHK16SN-06	6	60	13	9	9.0	0.03	✓
HHK16SN-08	8	80	13	9	11.5	0.07	✓
HHK16SN-10	10	100	16	12	14.0	0.14	✓
HHK16SN-12	12	140	20	19	18.0	0.28	✓

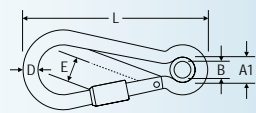

## PELICAN HOOK 316 STAINLESS

Part	D	L	A	Wgt (kg)	Stock
HHK16PEM06	M6	76	12.5	0.07	✓

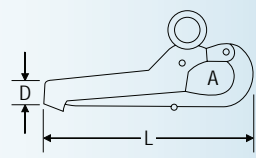

# Shackles

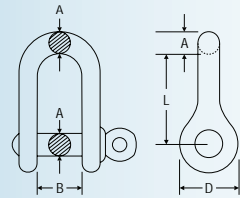

## "D" SHACKLE 316 STAINLESS

Part	A	L	B	D	Wgt (kg)	Stock
HSH16DSM04	M4	16	8	8	0.01	✓
HSH16DSM05	M5	20	10	10	0.01	✓
HSH16DSM06	M6	24	12	12	0.02	✓
HSH16DSM08	M8	32	16	16	0.06	✓
HSH16DSM10	M10	40	20	20	0.11	✓
HSH16DSM12	M12	48	24	24	0.19	✓
HSH16DSM16	M16	64	32	32	0.44	✓
HSH16DSM19	M19	76	38	38	0.89	✓

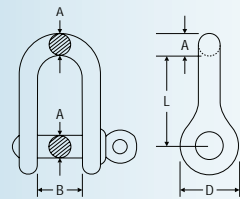

## "D" SHACKLE WITH CAPTIVE PIN 316 STAINLESS

Part	A	L	B	D	Wgt (kg)	Stock
HSH16CPM05	M5	20	10	10	0.01	✓
HSH16CPM06	M6	24	12	12	0.02	✓
HSH16CPM08	M8	32	16	16	0.06	✓
HSH16CPM10	M10	40	20	20	0.10	✓
HSH16CPM12	M12	48	24	24	0.11	✓

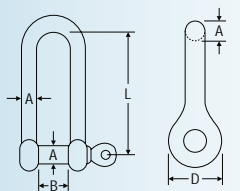

## "D" SHACKLE - LONG 316 STAINLESS

Part	A	L	B	D	Wgt (kg)	Stock
HSH16LGM04	M4	32.0	8.0	8.0	0.01	✓
HSH16LGM05	M5	40.0	10.0	10.0	0.02	✓
HSH16LGM06	M6	48.0	12.0	12.0	0.04	✓
HSH16LGM08	M8	64.0	16.0	16.0	0.01	✓
HSH16LGM10	M10	80.0	20.0	20.0	0.15	✓
HSH16LGM12	M12	96.0	24.0	24.0	0.27	✓

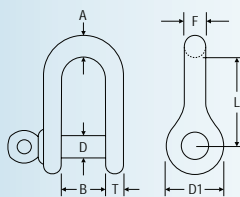

## "D" SHACKLE - LIGHT WEIGHT 304 STAINLESS

Part	D	L	B	F	D1	T	Wgt (kg)	Stock
HSH04LWM04	M4	22	10	5.5	9.5	1.8	0.01	✓
HSH04LWM05	M5	28	12	7.8	12.0	2.0	0.01	✓
HSH04LWM06	M6	30	14	8.5	14.6	3.0	0.02	✓
HSH04LWM08	M8	48	18	10.5	18.0	4.0	0.06	✓

# Shackles



## "D" SHACKLE WITH INTERNAL HEX PIN 316 STAINLESS

Part	A	L	B	D	Wgt (kg)	Stock
HSH16HPM06	M6	24	12	12	0.02	✓
HSH16HPM08	M8	32	16	16	0.05	✓
HSH16HPM10	M10	40	20	20	0.10	✓
HSH16HPM12	M12	48	24	24	0.18	✓

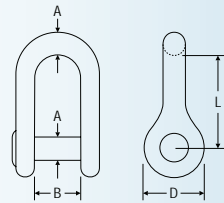

## SHACKLE - WIDE OPENING MOUTH 316 STAINLESS

Part	A	L	C	Wgt (kg)	Stock
HSH16WMM06	M6	36	24	0.03	✓
HSH16WMM08	M8	48	32	0.07	✓
HSH16WMM10	M10	60	40	0.15	✓
HSH16WMM12	M12	72	48	0.26	✓

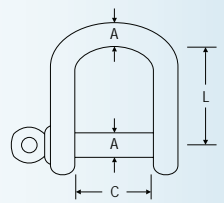

## SHACKLE - BOW 316 STAINLESS

Part	A	L	B	R	D	Wgt (kg)	Stock
HSH16BWM05	M5	20	8	17	10	0.02	✓
HSH16BWM06	M6	24	12	21	12	0.02	✓
HSH16BWM08	M8	32	16	28	16	0.07	✓
HSH16BWM10	M10	40	20	34	20	0.13	✓
HSH16BWM12	M12	48	24	42	24	0.21	✓
HSH16BWM16	M16	64	32	56	32	0.52	✓
HSH16BWM22	M22	88	44	77	44	1.31	✓

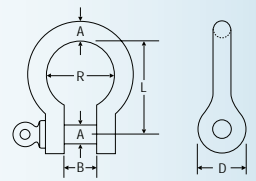

## SHACKLE - TWISTED 316 STAINLESS

Part	A	L	B	D	Wgt (kg)	Stock
HSH16TWM04	M4	24	8	14	0.01	✓
HSH16TWM05	M5	20	10	17	0.01	✓
HSH16TWM06	M6	24	12	21	0.05	✓
HSH16TWM08	M8	32	16	28	0.07	✓
HSH16TWM10	M10	40	20	34	0.13	✓
HSH16TWM12	M12	48	24	42	0.22	✓

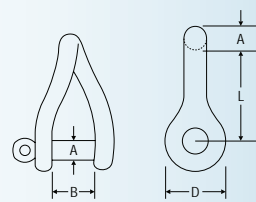

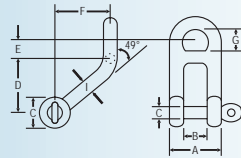

## "D" SHACKLE - DOUBLE BAR 316 STAINLESS

Part	C	D	A	B	G	I	Wgt (kg)	Stock
HSH16DBM06	M6	27	24	12	11.25	7.0	0.05	✓
HSH16DBM08	M8	36	32	16	15.00	8.8	0.10	✓
HSH16DBM10	M10	45	40	20	18.75	10.7	0.11	✓
HSH16DBM12	M12	54	48	24	22.50	12.5	0.32	✓



## PIN REPLACEMENT 316 STAINLESS

Part	D	Wgt (kg)	Stock
HXPINSM04	M4	0.01	✓
HXPINSM05	M5	0.01	✓
HXPINSM06	M6	0.01	✓
HXPINSM08	M8	0.02	✓
HXPINSM10	M10	0.03	✓
HXPINSM12	M12	0.08	✓
HXPINSM16	M16	0.11	✓

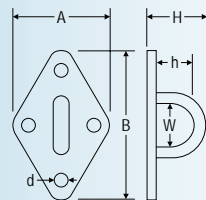

## PAD EYE - DIAMOND 304 STAINLESS

Part	A	B	H	h	W	d	Wgt (kg)	Stock
HEP04DI-05	37	59	22	12	11	4.2	0.03	✓
HEP04DI-06	40	64	26	15	15	4.2	0.05	✓
HEP04DI-08	50	80	33	20	18	5.2	0.07	✓

**NEW!**

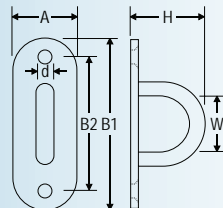

## PAD EYE - OVAL 304 STAINLESS

Part	A	B1	B2	H	W	d	Wgt (kg)	Stock
HEP04OV-05	15	54	38	22	16	5	0.02	✓
HEP04OV-06	19	65	46	28	16	5	0.05	✓

# Pad Eyes



## PAD EYE - OBLONG 304 STAINLESS

Part	A	B	H	h	W	d	Wgt (kg)	Stock
HEP04OB-05	30	35	19	12	14	4.2	0.03	✓
HEP04OB-06	35	40	26	17	18	4.2	0.04	✓
HEP04OB-08	40	50	33	22	20	5.2	0.06	✓

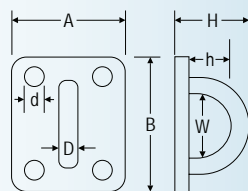

## PAD EYE - OBLONG WITH RING 304 STAINLESS

Part	A	B	H	h	W	d	Wgt (kg)	Stock
HEP04OR-05	30	35	19	12	14	4.2	0.04	✓
HEP04OR-06	35	40	26	17	18	4.2	0.07	✓
HEP04OR-08	40	50	33	22	20	5.2	0.13	✓

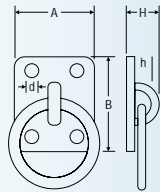

## PAD EYE - ROUND EYE BOLT 304 STAINLESS

Part	T	A	H	h	W	B	Wgt (kg)	Stock
HEP04RB-05	M6	33	20	12	13	20	0.03	✓
HEP04RB-06	M8	40	26	17	17	23	0.05	✓
HEP04RB-08	M10	50	32	20	20	25	0.08	✓

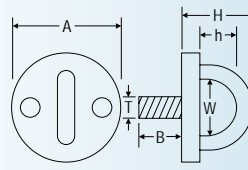

## PAD EYE - ROUND 304 STAINLESS

Part	A1	A2	H	h	W	d	Wgt (kg)	Stock
HEP04RD-05	33	19.5	20	12	13	4.2	0.02	✓
HEP04RD-06	40	23.0	26	17	17	4.2	0.04	✓
HEP04RD-08	50	29.5	32	21	20	5.2	0.07	✓

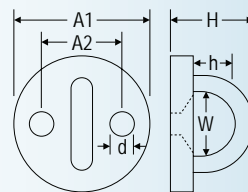

## PAD EYE - ROUND OPEN 304 STAINLESS

Part	H	A1	d	GAP	Wgt (kg)	Stock
HEP04RO-05	20	33	4.5	8.5	0.02	✓

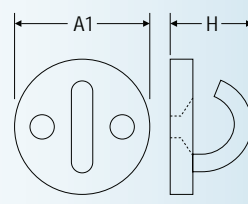

# Eye Bolts / Nuts

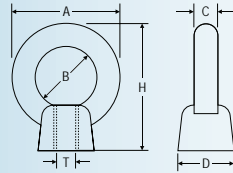

## EYE NUT 316 STAINLESS

Part	T	H	B	A	D	C	Wgt (kg)	Stock
HEN16PM06	M6	31.0	16	26.0	13	5.0	0.01	✓
HEN16PM08	M8	38.5	20	32.6	16	6.3	0.03	✓
HEN16PM10	M10	49.0	25	41.0	20	8.0	0.05	✓
HEN16PM12	M12	60.0	30	50.0	25	10.0	0.11	✓
HEN16PM16	M16	70.5	35	60.0	30	12.5	0.23	✓
HEN16PM20	M20	85.5	40	72.0	35	16.0	0.33	✓
HEN16PM24	M24	90.0	50	90.0	45	20.0	0.61	✓

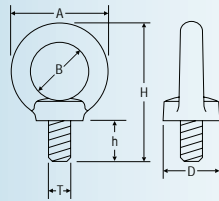

## EYE BOLT WITH COLLAR 316 STAINLESS

Part	T	H	B	A	D	h	Wgt (kg)	Stock
HEC16PM06	M6	41	16	26	13	11	0.02	✓
HEC16PM08	M8	50	20	32	16	15	0.03	✓
HEC16PM10	M10	63	25	40	20	21	0.06	✓
HEC16PM12	M12	75	30	49	25	23	0.10	✓
HEC16PM16	M16	87	35	60	30	25	0.20	✓
HEC16PM20	M20	103	40	70	35	32	0.37	✓
HEC16PM24	M24	130	50	89	50	40	0.76	✓

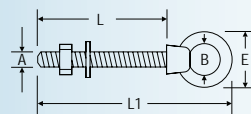

## EYE BOLT KIT WITH COLLAR 316 STAINLESS (incl. 1 Nut & 1 Washer)

Part	A	L	B	L1	E	Wgt (kg)	Stock
HEC16KM060060	M6	60	16	91	26	0.03	✓
HEC16KM080080	M8	80	20	120	32	0.09	✓
HEC16KM100100	M10	100	25	148	41	0.15	✓
HEC16KM100120	M10	120	25	168	41	0.14	✓
HEC16KM120120	M12	120	30	181	50	0.16	✓

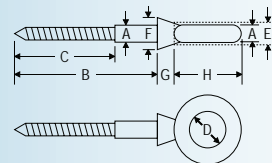

## LAG SCREW EYE WITH COLLAR 316 STAINLESS

Part	A	B	C	D	F	G	Wgt (kg)	Stock
HES16CLM06	M6	60	35	14.5	11.5	7	0.03	✓
HES16CLM08	M8	80	48	18.0	11.5	8	0.06	✓
HES16CLM10	M10	100	60	22.0	20.0	10	0.13	✓
HES16CLM12	M12	120	72	27.0	23.0	12	0.22	✓

# Eye Bolts / Screws



## EYE BOLT KIT 304 STAINLESS (incl. 1 Nut & 2 Washers)

Part	A	L1	B	L	L2	Wgt (kg)	Stock
HEB04PM060040	M6	40	13	35	64	0.02	✓
HEB04PM060060	M6	60	13	55	104	0.03	✓
HEB04PM060080	M6	80	13	75	104	0.03	✓
HEB04PM060100	M6	100	13	95	124	0.03	✓
HEB04PM080060	M8	60	17	55	92	0.05	✓
HEB04PM080080	M8	80	17	75	112	0.06	✓
HEB04PM080100	M8	100	17	95	132	0.06	✓
HEB04PM080130	M8	130	17	125	162	0.07	✓
HEB04PM100080	M10	80	21	75	119	0.11	✓
HEB04PM100100	M10	100	21	95	139	0.12	✓
HEB04PM100120	M10	120	21	115	159	0.12	✓
HEB04PM100150	M10	150	21	145	189	0.14	✓
HEB04PM120100	M12	100	25	95	146	0.19	✓
HEB04PM120150	M12	150	25	145	196	0.22	✓

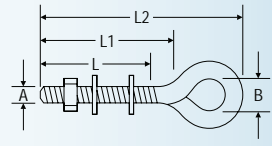

## EYE SCREW - METAL THREAD 316 STAINLESS

Part	D	L	L1	L2	E	Wgt (kg)	Stock
HES16PCM060030	M6	43	30	26	6.1	0.01	✓
HES16PCM060055	M6	62	55	50	6.1	0.01	✓

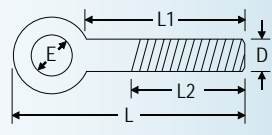

## LAG EYE SCREW 316 STAINLESS

Part	D	L1	B	D2	L	Wgt (kg)	Stock
HES16PLM04	M4	45	8.4	4.2	30	0.01	✓
HES16PLM06	M6	55	12.0	6.3	32	0.01	✓
HES16PLM08	M8	60	16.2	8.4	40	0.02	✓
HES16PLM10	M10	80	19.7	10.5	55	0.05	✓
HES16PLM12	M12	105	24.5	12.5	65	0.09	✓

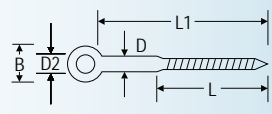

## SOCKET DRIVE

Part	D	L	B	Wgt (kg)	Stock
HXSD-06.5	6.5	35	13	0.01	✓

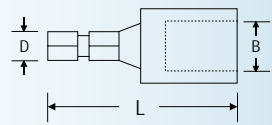

Suitable for use with M6 Lag Eye Screw (HES16PLM06)

# U-Bolts

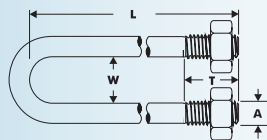

## ROUND U-BOLT KIT 316 STAINLESS (incl. 2 Nuts)

Part	A	NB	W	L	T	Pack	Wgt (Kg) per Pack	Stock
KUR16PCM100022	M10	15	22	67	40	50	4.80	✓
KUR16PCM100027	M10	20	27	78	50	50	5.54	✓
KUR16PCM100035	M10	25	35	86	50	50	6.10	✓
KUR16PCM100043	M10	32	43	94	50	50	6.60	✓
KUR16PCM100049	M10	40	49	100	50	50	7.17	✓
KUR16PCM100060	M10	50	60	111	50	50	8.00	✓
KUR16PCM120076	M12	65	76	127	50	25	7.50	✓
KUR16PCM120089	M12	80	89	140	50	25	8.00	✓
KUR16PCM120102	M12	90	102	152	50	25	8.75	✓
KUR16PCM120114	M12	100	114	165	50	10	3.70	✓
KUR16PCM120168	M12	150	168	220	50	10	4.50	✓

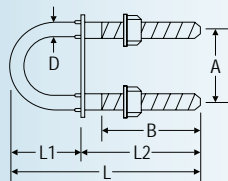

## U-BOLT KIT WITH CRIMP 304 STAINLESS (incl. 2 Nuts, 2 Washers & 1 Plate)

Part	D	L	A	B	L1	L2	Wgt (kg)	Stock
HUR04KPM040060	M4	60	30	30	25	35	0.02	✓
HUR04KPM050080	M5	80	35	40	35	45	0.03	✓
HUR04KPM060090	M6	90	35	40	35	55	0.05	✓
HUR04KPM080080	M8	80	35	40	35	45	0.08	✓
HUR04KPM100090	M10	90	50	55	30	60	0.14	✓
HUR04KPM100130	M10	130	50	55	55	75	0.21	✓
HUR04KPM120150	M12	150	60	65	65	85	0.31	✓

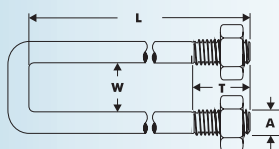

## SQUARE U-BOLT KIT 316 STAINLESS (incl. 2 Nuts)

Part	A	W	L	T	Pack	Wgt (Kg) per Pack	Stock
KUS16PCM10042086	M10	42	86	55	50	5.50	✓

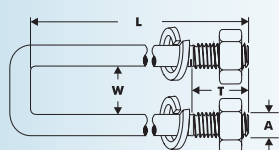

## SQUARE U-BOLT KIT 316 STAINLESS (incl. 2 Nuts & 2 Spring Washers)

Part	A	W	L	T	Pack	Wgt (Kg) per Pack	Stock
KUS16PSM12077110	M12	77	110	50	25	6.25	✓



# Toggle Latch / Pulleys



**NEW!**

## TOGGLE LATCH - ADJUSTABLE & LOCKABLE 304 STAINLESS

Part	A	B	C	D	F	L	Wgt (kg)	Stock
HLT04A078087	25	35	18	14	24	78 - 87	0.03	✓
HLT04A110120	25	35	25	20	35	110 - 120	0.04	✓

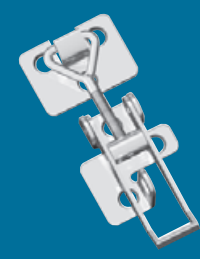
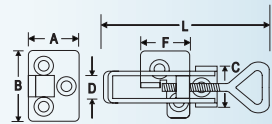

## NYLON PULLEY BLOCK 316 STAINLESS (incl. Removable Pin)

Part	A	B	D	L	Wgt (kg)	Stock
HPB16RP-25	26	10	6.5	45	0.03	✓

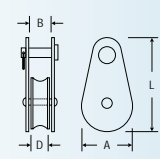

## NYLON PULLEY BLOCK 316 STAINLESS (incl. Swivel & Removable Pin)

Part	A	B	D	L	Wgt (kg)	Stock
HPB16BP-25	26	10	6.5	57	0.03	✓

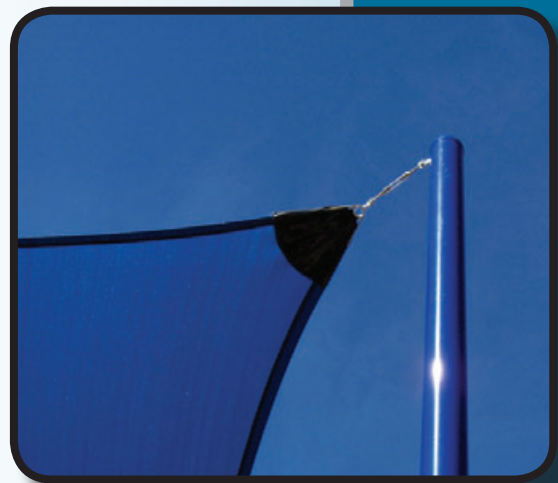
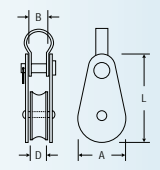

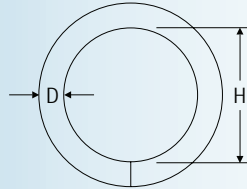

## ROUND RING WELDED 304 STAINLESS

Part	D	H	Wgt (kg)	Stock
HRG04WR-040025	4	25	0.01	✓
HRG04WR-050035	5	35	0.02	✓
HRG04WR-060040	6	40	0.03	✓
HRG04WR-060050	6	50	0.04	✓
HRG04WR-080050	8	50	0.07	✓
HRG04WR-080075	8	75	0.10	✓
HRG04WR-100075	10	75	0.16	✓
HRG04WR-100100	10	100	0.17	✓

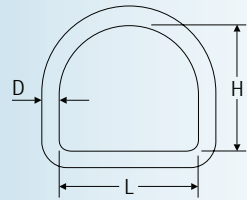

## DEE RING WELDED 304 STAINLESS

Part	D	L	H	Wgt (kg)	Stock
HRG04WD-040030	4	30	25	0.01	✓
HRG04WD-060040	6	40	37	0.03	✓
HRG04WD-060050	6	50	47	0.04	✓
HRG04WD-080050	8	50	47	0.08	✓

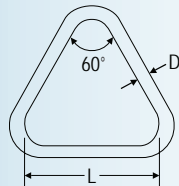

## TRIANGLE RING WELDED 304 STAINLESS

Part	D	L	A	Wgt (kg)	Stock
HRG04WT-06	6	50	60°	0.04	✓
HRG04WT-08	8	50	60°	0.06	✓

# Chain



## CHAIN LINK CLIP POLISHED 316 STAINLESS

Part	D	L1	A	B	L	Wgt (kg)	Stock
HCH16LC-06	6	36	9	24	24	0.02	✓
HCH16LC-08	8	48	12	30	32	0.04	✓
HCH16LC-09	9	54	13	34	36	0.06	✓
HCH16LC-11	11	66	17	41	44	0.13	✓
HCH16LC-16	16	96	24	59	64	0.38	✓
HCH16LC-18	18	110	28	64	76	0.54	✓

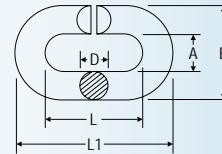

## CHAIN LINK QUIK POLISHED 316 STAINLESS

Part	D	B	L	Wgt (kg)	Stock
HCH16LQ-04	4	12	33	0.01	✓
HCH16LQ-05	5	13	41	0.02	✓
HCH16LQ-06	6	14	47	0.04	✓
HCH16LQ-08	8	18	60	0.08	✓
HCH16LQ-10	10	22	70	0.14	✓

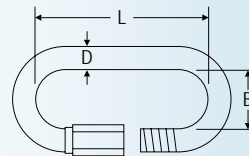

## CHAIN LINK POLISHED 316 STAINLESS DIN766

Part	D	L	W	Wgt (Kg) per Mtr	Stock
HCH16LP-02	2	26	10	0.07	✓
HCH16LP-03	3	22	11	0.16	✓
HCH16LP-04	4	24	14	0.32	✓
HCH16LP-05	5	28	17	0.50	✓
HCH16LP-06	6	30	20	0.75	✓
HCH16LP-08	8	40	26	1.35	✓
HCH16LP-10	10	48	34	2.25	✓
HCH16LP-12	12	58	40	3.50	✓

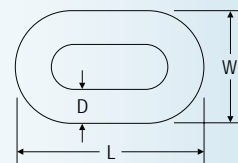



# Swaging & Cutting Tools

Cutting



Swaging



HTHSC-350



HTHSC-600



HTHSC-600BB



## SWAGING TOOLS C/W CUTTERS

Part	Size	Overall Length	Wire Rope Diam.	Stock
HTHSC-350	350	380	1.5 - 3.5	✓
HTHSC-600	600	650	1.5 - 5.0	✓
HTHSC-600BB	600	540	1.5 - 5.0	✓

HTHRC-008



HTHRC-450



HTHRC-800



## WIRE ROPE CUTTERS

Part	Size	Overall Length	Wire Rope Diam.	Stock
HTHRC-008	200	195	5	✓
HTHRC-450	450	470	12	✓
HTHRC-800	800	800	16	✓

Hydraulic press and dies also available!

# Swaging - Made To Order



We can supply wire rope and fittings already swaged for your customers project.

Step 1: Download the swaging order form online [www.hobson.com.au](http://www.hobson.com.au).

Step 2: Fill in your requirements.

Step 3: Fax it to us for a quote.

Step 4: Order placed for selected wire and fittings.

Step 5: Swaged and supplied by Hobson.



## SWAGING ORDER FORM

Date: \_\_\_\_\_

CUSTOMER / COMPANY NAME : \_\_\_\_\_

CONTACT NAME : \_\_\_\_\_

PHONE : \_\_\_\_\_ FAX : \_\_\_\_\_

Since 1935  
... because quality matters

Length from Outside Posts mm \_\_\_\_\_

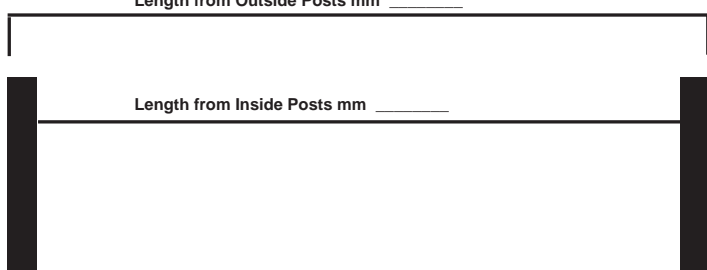

Length from Inside Posts mm \_\_\_\_\_

Wire Rope Construction \_\_\_\_\_ Qty \_\_\_\_\_

Wire Diameter \_\_\_\_\_

Cut Length mm \_\_\_\_\_

*Please fill in the Blanks with the corresponding Letters of the fitting combination you require.*

Fittings to be used on Left Hand Post End: \_\_\_\_\_ + \_\_\_\_\_ + \_\_\_\_\_ + \_\_\_\_\_

Fittings to be used on Right Hand Post End: \_\_\_\_\_ + \_\_\_\_\_ + \_\_\_\_\_ + \_\_\_\_\_

<b>A. Lag Eye Screw (Wood)</b> HES16PL	<b>B. TurnBuckle Jaw+Jaw</b> HTB16JJ	<b>C. Rigging Screw Eye+Eye</b> HRS16EE	<b>D. TurnBuckle Hook+Hook</b> HTB16HH
<b>E. Saddle</b> HED04ST	<b>F. Fork Swage</b> HTS16FK	<b>G. Rigging Screw Jaw+Swage</b> HRS16JS	<b>H. Fork Toggle Swage</b> HTS16FT
<b>I. Button Head Swage</b> HTS16BH	<b>J. Threaded Stud Terminal</b> HTS16ST	<b>K. Eye Screw (Metal Thread)</b> HES16PC	<b>L. Dome Nut</b> ND16PC

FITTINGS AND WIRE ROPE MEASUREMENTS CONFIRMED - SIGNED

\_\_\_\_\_ Date: \_\_\_\_\_



# Stainless Technical

## STAINLESS STEEL CHEMICAL PROPERTIES

	Suitable Alloys	Carbon	Silicon	Manganese	Phosphorous	Sulphur	Chromium	Molybdenum	Nickel
A2	302, 304, 304L, 321, 347	0.08 max	1.0 max	2.0 max	0.05 max	0.03 max	17.0-20.0	-	8.0-13.0
A4	316, 316L	0.08 max	1.0 max	2.0 max	0.05 max	0.03 max	16.0-18.5	2.0-3.0	10.0-14.0

### Want better corrosion resistance?

Choose a stainless fastener or fitting. The chromium in the stainless steel has a great affinity for oxygen, and will form on the surface of the steel at a molecular level a film of chromium oxide. The film itself is about 130 Angstroms in thickness, one Angstrom being one millionth of one centimetre. This layer is described as passive, tenacious and self renewing.

**Passive** means that it does not react or influence other materials;

**Tenacious** means that it clings to the layer of steel and is not transferred elsewhere;

**Self renewing** means that if damaged or forcibly removed more chromium from the steel will be exposed to the air and form more chromium oxide.

### Protective Chromium Oxide Film

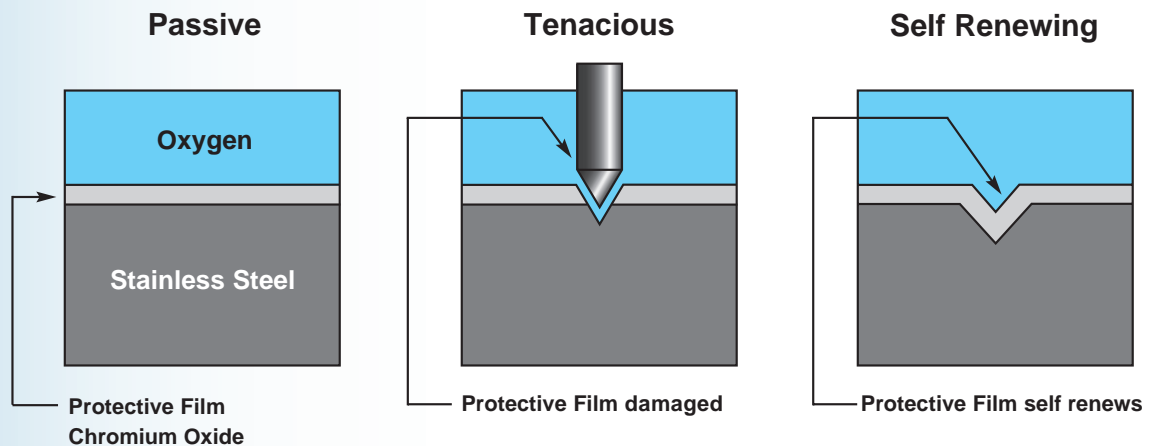

# Terms and Conditions



The Company and the Customer each agree with the other as follows:

## DEFINITIONS

Company means Hobson Engineering Pty Limited (A.B.N. 38 000 289 958).

Customer means the party described as the customer in the Delivery Docket as amended by the Invoice.

Delivery Docket means the document furnished by the Company to the Customer.

GST has the same meaning as given in A New Tax System (Goods and Services Tax) Act 1999 ("Act").

Invoice means a tax invoice (as defined in the Act) furnished by the Company to the Customer in respect of the product.

Product means the goods described as the product in the Delivery Docket as amended by the Invoice.

Purchase Order means the request by the Customer for the Product which is accepted by the Company.

Sum means the price and other monies payable for the Product together with GST payable on the supply of the Product.

## SUPPLY

The Company supplies to the Customer the Product in accordance with these terms and conditions as varied in writing by the Company. Any variation in writing by the Company shall take precedence to these terms and conditions. We reserve the right to supply 316 stainless steel in lieu of 304 stainless steel.

## PRICE

The Sum is set forth in the Purchase Order as amended by the Invoice. The Customer agrees that the Sum set forth in the Purchase Order may be amended by the Invoice in respect of the following:

arithmetic error; and

GST payable on the supply of the Product not included or incorrectly calculated in the Sum.

In addition to the price the Customer agrees, if so requested by the Company, to pay:

any increase in any GST taxes and duties which the Company may be required to collect or pay in respect of the Product after the date of the Delivery Docket; and

interest accruing on a daily basis on the unpaid balance of the Sum from the due date for payment until actual receipt at the rate of 1 per cent per month.

## PAYMENT

The Customer must pay the Sum within 30 days of the end of the month in which the Product is delivered to the Customer unless otherwise determined by the Company.

## TITLE AND RISK

Notwithstanding any other term and condition, the parties agree that the risk of the Product passes on delivery, but title to the Product does not pass until the Sum is paid in full. Until such time as the Sum is paid in full the Customer is only at liberty to sell the Product in the ordinary course of its business as agent for the Company on the condition that it holds on trust and accounts to the Company for the proceeds thereof. Pending the passing of title to the Product the Company may require the Customer to mark the Product as being the property of the Company.

## ACCEPTANCE

The initialling or signing of the Delivery Docket by the Customer or representative of the Customer shall constitute acceptance of the Product in accord with these terms and conditions.

## RETURNS AND ALLOWANCES

The Customer must satisfy itself within 14 days of the date of delivery of the Product with the type and quantity of the Product. In the event that the Customer considers it has not received the appropriate type and or quantity of Product it must notify the Company in writing within 14 days of the date of delivery of the Product. The notice must refer to the Delivery Docket number, the delivery date, the invoice number (if applicable) and provide adequate details of the incorrect type and or quantity of Product.

As a consequence of this condition the receipt of Products by the Company, returned by the Customer does not constitute acceptance of the Product. Acceptance by the Company shall only be given by the Company, in writing, after the Product has been inspected and found satisfactory in the opinion of the Company. In the event that the Company does not accept the Product the Customer will be notified and the Product made available to the Customer. As a consequence of this condition no transport or freight costs shall be borne by the Company unless agreed to in writing by the Company.

## EXCLUSION OF WARRANTY

Nothing in this agreement excludes, restricts or modifies any condition, warranty or liability which may at any time be implied by the Trade Practices Act or Sales of Goods Act (NSW) or equivalent State or Territory legislation or any other law where to do so is illegal or would render any provision of this agreement void.

Where the Company is responsible pursuant to the aforesaid condition warranty or liability which can not be excluded the parties agree that the Company shall only be liable for the cost of repair or the resupply of the Product. Subject to this condition any express or implied condition, statement or warranty (statutory or otherwise) in respect of the Product is expressly negated and excluded.

## GENERAL

The validity, interpretation and performance of this agreement will be governed by and construed in accordance with the law of the State of New South Wales and of the Commonwealth of Australia which the parties acknowledge is the proper law of this agreement. Each of the parties irrevocably agrees that the Courts of the State of New South Wales and of the Commonwealth of Australia will have jurisdiction to hear and determine any suit, action or proceedings, and to settle any dispute, which may arise out of or in connection with this agreement and for this purpose irrevocably submits to the jurisdiction of such Courts.

DISCOUNTS as advised are applicable to the prices shown in this price list.

PRICES The resale prices or discounts referred to in the price list are recommended only and there is no obligation to comply with the recommendation. Prices are subject to GST where applicable.

Minimum invoice value is \$40.00

SHIPPING QUANTITIES On specially manufactured items ( $\pm 10\%$ ).

VALIDITY ON SPECIAL QUOTATIONS 14 days unless otherwise stated.

© Copyright 2005 – No part of this catalogue may be published without the written consent of the publishers.

Note: Due to research and development, products are continually improved. This may lead to the specifications being changed without notice.

As part of our ongoing commitment to serve your fastener needs, please let us know if there are any products which we lack.

Also, if you've got any comments on this year's Catalogue, let us know. We'll consider your feedback when we produce next year's. This catalogue is for you to use – so if it's use can be made easier, then make sure you tell us! Our aim is to have the best catalogue possible as well as the best products.

